

**(12) STANDARD PATENT**  
**(19) AUSTRALIAN PATENT OFFICE**

(11) Application No. **AU 2011358377 B2**

(54) Title  
**Clamp for temporary or definitive external orthopaedic fixation, and external fixation system comprising said clamp**

(51) International Patent Classification(s)  
**A61B 17/64 (2006.01)**

(21) Application No: **2011358377** (22) Date of Filing: **2011.09.09**

(87) WIPO No: **WO12/107060**

(30) Priority Data

(31) Number	(32) Date	(33) Country
<b>61/441,953</b>	<b>2011.02.11</b>	<b>US</b>

(43) Publication Date: **2012.08.16**

(44) Accepted Journal Date: **2014.11.13**

(71) Applicant(s)  
**ORTHOFIX S.R.L.**

(72) Inventor(s)  
**Zandona, Enrico;Lorenzini, Denis;Venturini, Daniele;Assom, Marco;Nayagam, Selvadurai**

(74) Agent / Attorney  
**Smootenburg Patent and Trade Mark Attorneys, PO Box 515, RINGWOOD, VIC, 3134**

(56) Related Art  
**EP 2250968 A1**  
**US 5752954 A**  
**US 2008/0247818 A1**  
**US 2009/0326532 A1**  
**US 2002/0165543 A1**  
**US 2007/0038217 A1**



- (51) International Patent Classification:  
*A61B 17/64* (2006.01)
- (21) International Application Number:  
PCT/EP2011/004549
- (22) International Filing Date:  
9 September 2011 (09.09.2011)
- (25) Filing Language: English
- (26) Publication Language: English
- (30) Priority Data:  
61/441,953 11 February 2011 (11.02.2011) US
- (71) Applicant (for all designated States except US): **ORTHOFIX S.R.L.** [IT/IT]; Via delle Nazioni, 9, I-37012 Bussolengo (VR) (IT).
- (72) Inventors; and
- (75) Inventors/Applicants (for US only): **ZANDONÀ, Enrico** [IT/IT]; Via della Pesciara, 1, 37142 Quinto di Valpentena (VR) (IT). **LORENZINI, Denis** [IT/IT]; Via Giovanni XXIII, 12, 37013 Caprino Veronese (VR) (IT). **VENTURINI, Daniele** [IT/IT]; Via dei Carpini, 36, I-37064 Povegliano Veronese (VR) (IT).
- (74) Agents: **BOTTI, Mario** et al.; BOTTI & FERRARI S.R.L., Via Cappellini, 11, I-20124 Milano (IT).
- (81) Designated States (unless otherwise indicated, for every kind of national protection available): AE, AG, AL, AM, AO, AT, AU, AZ, BA, BB, BG, BH, BR, BW, BY, BZ, CA, CH, CL, CN, CO, CR, CU, CZ, DE, DK, DM, DO, DZ, EC, EE, EG, ES, FI, GB, GD, GE, GH, GM, GT, HN, HR, HU, ID, IL, IN, IS, JP, KE, KG, KM, KN, KP, KR, KZ, LA, LC, LK, LR, LS, LT, LU, LY, MA, MD, ME, MG, MK, MN, MW, MX, MY, MZ, NA, NG, NI, NO, NZ, OM, PE, PG, PH, PL, PT, QA, RO, RS, RU, RW, SC, SD, SE, SG, SK, SL, SM, ST, SV, SY, TH, TJ, TM, TN, TR, TT, TZ, UA, UG, US, UZ, VC, VN, ZA, ZM, ZW.
- (84) Designated States (unless otherwise indicated, for every kind of regional protection available): ARIPO (BW, GH, GM, KE, LR, LS, MW, MZ, NA, SD, SL, SZ, TZ, UG, ZM, ZW), Eurasian (AM, AZ, BY, KG, KZ, MD, RU, TJ, TM), European (AL, AT, BE, BG, CH, CY, CZ, DE, DK, EE, ES, FI, FR, GB, GR, HR, HU, IE, IS, IT, LT, LU, LV, MC, MK, MT, NL, NO, PL, PT, RO, RS, SE, SI, SK, SM, TR), OAPI (BF, BJ, CF, CG, CI, CM, GA, GN, GQ, GW, ML, MR, NE, SN, TD, TG).

[Continued on next page]

- (54) Title: CLAMP FOR TEMPORARY OR DEFINITIVE EXTERNAL ORTHOPAEDIC FIXATION, AND EXTERNAL FIXATION SYSTEM COMPRISING SAID CLAMP

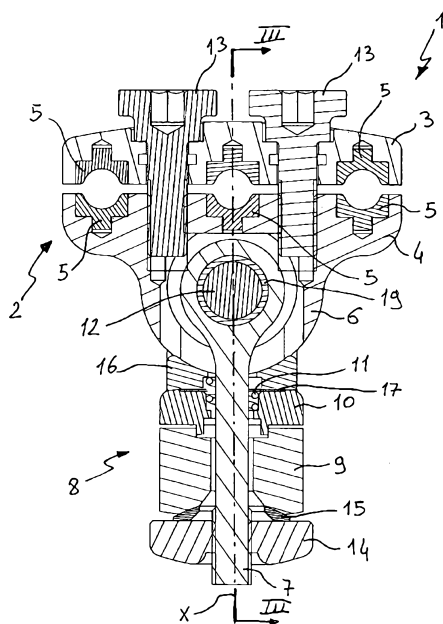

FIG. 2

(57) Abstract: Clamp (1) that can advantageously be applied to both temporary and definitive orthopaedic external fixation systems comprising: - a first coupling element (2), comprising a pair of opposite jaws (3, 4) together defining one or more seats able to house at least a first component of the orthopaedic external fixation system; - a second coupling element (8), comprising a pair of opposite jaws (9, 10) together defining one or more seats able to house at least a second component of the orthopaedic external fixation system; - an interconnection pin (7) passing through and connecting the first (2) and second (8) coupling elements along a main axis of rotation (x); - fastening means arranged to bring the clamp (1) from a slack configuration, wherein the first (2) and second coupling elements (8) are relatively rotatable at least along the main axis of rotation (x), to a locked configuration, wherein the first (2) and second coupling elements (8) are relatively rotatable with each other; these fastening means dividing in - temporary fastening means, which can be manually operated, to temporarily lock the clamp (1); - definitive fastening means, which can be operated by means of a fastening tool, to definitively lock the clamp (1).



**Published:**

— *with international search report (Art. 21(3))*

+61 3 9870 4200

1

**CLAMP FOR TEMPORARY OR DEFINITIVE EXTERNAL ORTHOPAEDIC  
FIXATION, AND EXTERNAL FIXATION SYSTEM COMPRISING SAID CLAMP.****DESCRIPTION****Field of Application**

[0001] The present invention applies to the field of orthopaedic surgery and it relates in particular to a clamp intended for the temporary or definitive fixation of the elements composing an external fixation system.

[0002] The present invention also relates to an external fixation system comprising this clamp.

**Prior Art**

[0003] In orthopaedics, external fixation techniques for stabilizing, reducing and manipulating bone segments are known and commonly used. These techniques provide the surgical application of an external fixation system, composed in its simplest form of a set of rods associated by means of endosseous pins or Kirchner wires to the patient's bone structure. The articulation of rods with respect to each other and to fixators is left to suitable clamps.

[0004] These fixation systems can be temporarily applied during an operation, or definitively applied in order to be removed only upon full recovery from the treated pathological condition.

[0005] The use of temporary fixation systems is required especially for the following reasons:

- a patient may have serious lesions that require priority treatment;
- a patient may have lesions obliging interventions to be minimal;
- local conditions in the fracture region could preclude definitive fracture fixation owing to severe wound infection, or a lack of covering soft tissue, or a shortage of blood supply;

+61 3 9870 4200

2

- single fractures to be treated may not be particularly serious, but they may require long and complex surgical interventions for their treatment if they are taken together with other fractures that have occurred.

[0006] In the latter case some or all of the fractures can be treated by means of external fixation systems. It is however necessary to avoid the situation wherein one is forced to abandon fracture fixation: at the end of the primary treatment all long bones must be firmly fixed.

[0007] Beyond these specific requirements, external fixation systems are mainly applied in a definitive way. In such cases, however, a different performance when compared to temporary applications is requested of the external fixation system. In particular, if an external fixation system for temporary application is required to present above all flexibility of use and rapidity of fixation, a system that is implanted in a definitive way must ensure a certain degree of rigidity (see for example Orthofix's device marketed under the name XCaliber, which allows for adjustment of lateral curvature and bearing torsional stress during the initial steps of treatment).

[0008] This stability partly derives from the alignment of the fixation system rods with the axis of the long bones to be treated, and partly from the intrinsic stiffness of the device itself and the number of screws, and furthermore partly in function of the geometrical screw configuration. A proper configuration allows rapid healing and a quick recuperation of mobility.

[0009] Given the different requirements of the fixation system for these two applications, up to now systems have been used that are dedicated either to the temporary treatment or to the definitive treatment.

[0010] This specificity in treatment is undoubtedly one of the disadvantages of the external fixation systems known up to now; for example when a temporary fixation needs to be applied that subsequently must be substituted by definitive fixation, it is necessary to replace the entire fixation system.

[0011] On the other hand, the main critical aspect that stands in the way of external fixation systems for mixed use is concerned with the clamp that is intended to fasten joining elements such as rods, screws and Kirchner wires.

+61 3 9870 4200

3

[0012] In fact, in temporary fixation it is essential that this clamp allows the relative orientation of the elements it connects to be rapidly blocked, possibly without using a fastening tool. In definitive fixation, the blocking of the relative orientation however must be rigid and stable over time, features that clash with the above-mentioned fastening modes.

[0013] Therefore, the technical problem underlying the present invention is to provide a clamp that can be used in external fixation systems and that is suited for both temporary use and definitive use, i.e. that can be locked in a rapid and manual way, but that at the same time ensures rigidity and stability over time.

### **Summary of the Invention**

[0014] The above-mentioned technical problem is solved by a clamp for an external orthopaedic fixation system comprising:

- a first coupling element, comprising a pair of opposite jaws that together define one or more seats suitable for housing at least a first component of the external orthopaedic fixation system;
- a second coupling element, comprising a pair of opposite jaws that together define one or more seats suitable for housing at least a second component of the external orthopaedic fixation system;
- an interconnection pin crossing and connecting the first and second coupling elements along a main axis of rotation;
- fastening means arranged to bring the clamp from a slack configuration, wherein the first and second coupling elements are relatively rotatable at least along the main axis of rotation, to a locked configuration, wherein the first and second coupling elements are relatively integral with each other; these fastening means comprising in particular;
- temporary fastening means, which can be manually operated, arranged to bring the clamp temporarily in a locked configuration;

+61 3 9870 4200

4

- definitive fastening means, which can be operated by means of a fastening tool, arranged to bring the clamp definitively in a locked configuration wherein said temporary fastening means comprise a fastening ring nut arranged to fasten together the first and second coupling elements along the interconnection pin, characterized in that said definitive fastening means comprise an eccentric body, rotatably mounted on a hinging body that is axially integral with either one of the first or of the second coupling elements, said eccentric body passing through a connecting rod head of the interconnection pin along an axis that is perpendicular to the main axis of rotation, the opposite end of said interconnection pin being constrained to the other between the first and second coupling elements, the rotation of said eccentric body with respect to the hinging body promoting a translation of the opposite end of the interconnection pin towards said hinging body and as a result to relatively bring the two coupling elements nearer each other.

[0015] The alternative meanings "temporarily" and "definitively" are intended to discriminate, similarly to what has been done in the prior art description, between a temporary fastening of the clamp components and a definitive fastening. The temporary, moderately tight fastening can be rapidly realized without using a fastening wrench, it allows a relative fixation of the elements but it does not guarantee rigidity and stability of the chosen position over time. Instead the definitive fastening, which is stronger than the previous one, is able to withstand the regular stress that an external fixation system is exposed to in the course of a patient's hospitalization.

[0016] A person skilled in the art will immediately note how the presence of double fastening means on the clamp, the manual ones and those that are fastened by means of a tool, allows the device to be applied to external fracture fixation systems, as a result of which these systems will be suited for both temporary and definitive use.

[0017] Moreover it should be noted that, although the capabilities of the clamp according to the present invention are greatly adapted to the context of an external fixation system for both temporary and definitive use, this clamp can advantageously be used in any other orthopaedic application.

+61 3 9870 4200

5

[0018] The above-mentioned temporary fastening means can advantageously comprise a fastening ring nut, arranged to fasten the first and second coupling elements to each other along the length of the clamp's interconnection pin.

[0019] In particular, the fastening ring nut can advantageously have a cylindrical peripheral handling surface that is conveniently knurled.

[0020] The single jaws of at least one of the pair of jaws can be both crossed by the interconnection pin, so that this pair of jaws is not fastened in the slack configuration of the clamp and fastened in the locked configuration of the clamp.

[0021] This configuration results in an advantageous acceleration of clamp locking operations, since the same means are used both to fasten the jaws and to fix coupling elements.

[0022] The clamp can further comprise a spring interposed between the first and second coupling elements, which can advantageously determine a pre-fastening action of the jaws of the coupling element onto the respective seats.

[0023] In a first embodiment of the clamp according to the present invention, the fastening ring nut can engage a threaded end of the interconnection pin, the opposite end of said interconnection pin being constrained to the first coupling element, the second coupling element being interposed between the fastening ring nut and the first coupling element.

[0024] In alternative embodiments of the clamp, instead, the fastening ring nut is axially constrained to one end of the interconnection pin, the opposite end being threaded and engaging an at least partially threaded hole of the second coupling element, said first coupling element being interposed between the fastening ring nut and the second coupling element.

[0025] In one of these embodiments, which presents the advantage of great structural simplicity, the fastening ring nut even defines a fastening head that is integral with the interconnection pin, said definitive fastening means comprising a hollow of said head intended to allow it to be coupled with a fastening tool.



+61 3 9870 4200

6

[0026] In particular, the fastening ring nut can surround a connecting rod head of the interconnection pin, said definitive locking means comprising an eccentric body, rotatably mounted on the fastening ring nut which crosses said connecting rod head along an axis perpendicular to the main axis of rotation, the rotation of said eccentric body with respect to the fastening ring nut creating a translation of the end of the interconnection pin engaged in the second coupling element towards the fastening ring nut.

[0027] In some embodiments of the clamp, said definitive fastening means comprise an eccentric body, rotatably mounted on a hinging member that is axially integral with either one of the first and second coupling elements, said eccentric body crossing a connecting rod head of the interconnection pin along an axis perpendicular to the main axis of rotation, the opposite end of said interconnection pin being constrained to the other between the first and second coupling elements, the rotation of said eccentric body with respect to the hinging body promoting a translation of the opposite end of the interconnection pin towards said hinging body and a subsequent relative approach of the two coupling elements.

[0028] In one of these embodiments, the fastening ring nut is arranged in abutment against the outermost jaw of the second coupling element, said hinging body corresponding to the first coupling element, the end of the interconnection pin opposite the connecting rod head being threaded and constrained by screwing to the fastening ring nut.

[0029] In an alternative embodiment, said eccentric body hinges the first coupling element to the interconnection pin along a secondary axis of rotation, advantageously defining a second degree of rotational freedom between the first coupling element and the second coupling element in the slack configuration of the clamp.

[0030] The eccentric body can then be hinged onto a base portion that proceeds in the direction of the second coupling element as a protruberance of the innermost jaw of the first coupling element.

[0031] In this case, a central joint crossed by the interconnection pin can be advantageously arranged between the base portion and the second coupling element, said central joint having a sliding face along a concave periphery of the base portion and a flat face intended to couple with a surface of the internal jaw of the coupling element.

+61 3 9870 4200

7

[0032] The above-identified technical problem is also solved by an external orthopaedic fixation system comprising at least one of the above-described clamps, besides known rods and fixators.

[0033] This external orthopaedic fixation system can further comprise at least an innovatively designed wire-carrier element, arranged to allow at least one Kirchner wire or other fixator of limited-diameter to be fixed onto one of the system clamps.

[0034] One should note that this element can also be advantageously applied outside the scope defined by the present invention, as it presents innovative features of its own.

[0035] The wire-carrier element can comprise a shank with a threaded portion onto which a fastening plate is screwed right up to an abutting plate that is integral with the shank.

[0036] The shank can comprise a gripping portion intended to be locked between the jaws of one of the system clamps.

[0037] The fastening plate can further advantageously have four peripheral teeth on one of its faces turned towards the abutting plate, equiangularly spaced along the circumference of said plate and arranged to abut against a flat surface of the abutting plate, thus defining, in collaboration with the shank portion comprised between the two plates, a seat for a Kirchner wire or for screws with limited diameter.

[0038] Further features and advantages will be apparent from the following description of some preferred, but not exclusive, embodiments of the present invention, with reference to the attached drawings, given by way of non-limiting examples.

#### **Brief Description of the Drawings**

[0039] Figure 1 is an axonometric view of a clamp according to the invention;

[0040] Figure 2 is a sectional view along a vertical central plane of the clamp of figure 1;

+61 3 9870 4200

8

[0041] Figure 3 is a sectional view, taken along the line III-III of figure 2, of the 20 clamp of figure 1;

[0042] Figures 4 and 5 are respective axonometric views of a clamp according to an alternative embodiment of the present invention;

[0043] Figure 6 is a sectional view along the line VI-VI of figure 7 of the clamp of figures 4 and 5;

[0044] Figure 7 is a sectional view, taken along the line VII-VII of figure 6, of the clamp of figures 4 and 5;

[0045] Figures 8 and 9 are respective axonometric views of a clamp according to a third embodiment of the present invention;

[0046] Figure 10 is a sectional view along a vertical central plane of the clamp of figures 8 and 9;

[0047] Figure 11 is an axonometric view of an element of an external fixation system according to the present invention;

[0048] Figure 12 is a sectional view, taken along a vertical central plane, of the element of figure 11;

[0049] Figure 13 is an axonometric view of an external fixation system according to the present invention applied to a first bone site of a patient;

[0050] Figure 14 is an axonometric view of an external fixation system according to the present invention applied to a second bone site of a patient.

### Detailed Description

[0051] According to a first embodiment of the present invention, figures 1-3 show a first clamp, globally indicated with reference number 1, for an external modular fixation system

+61 3 9870 4200

9

suitable to be used for the treatment of lower limbs, such as tibia, femur or pelvis. Through a simple dimensional adjustment it is possible to use this clamp also for upper limbs, for example a humerus.

[0052] In this first embodiment, the clamp allows a rod and a plurality of endosseous pins to be fixed in a simple and stable way, as will be clear from the following description.

[0053] The clamp 1 comprises a first multi-seat coupling element 2 for fixing endosseous pins, comprising at least three seats to fasten as many endosseous pins.

[0054] The multi-seat coupling element 2 is preferably made of metal.

[0055] According to the present invention, the multi-seat coupling element 2 comprises an upper jaw 3 and a lower jaw 4. The upper jaw 3 performs the function of a lid and has a pair of through-holes, at least partially threaded, through which closing screws 13 pass. The lower jaw 4 comprises a corresponding pair of internally-threaded blind holes to receive the ends of the two screws 13.

[0056] At least an insert 5 is provided in at least one of the seats in order to fix the endosseous pins. In particular, the use of inserts of a hemispheric form is provided between the lower jaw 4 and the upper jaw 3 in order to define each housing seat of the endosseous pins.

[0057] These inserts 5 are made of a different material with respect to the jaws 3 and 4, for example out of a non-conductive material.

[0058] More particularly, it is preferable that these inserts are made of a radio-transparent material that is MRI-compatible.

[0059] In the example being shown, the three seats are equidistant, the central seat being placed in correspondence with the central axis and the two remaining seats on either side thereof.

[0060] A base portion 6 developing as a protuberance of the lower jaw 4 has a seat internally to house the head of an interconnection pin 7 shaped as a connecting rod with a shank extending

2011358377 06 May 2013

+61 3 9870 4200

10

along a main axis of rotation  $x$  that is orthogonal to the seats defined by the first coupling element 2, toward a second rod coupling element 8.

[0061] The second rod coupling element 8 also has a lower jaw 9 and an upper jaw 10.

[0062] This second rod coupling element 8 has a single C-shaped seat, lateral and orthogonal with respect to the main axis of rotation  $x$ , for snap-fitting to a fixing rod 100.

[0063] The lower and upper jaws 9, 10 of the second coupling element have a central through-hole through which the interconnection pin 7 passes.

[0064] A fastening ring nut 14, suitably knurled on the outer side for better grip, is screwed on the free end of the interconnection pin 7. In particular, this ring nut 14 has a threaded central hole that is screwed on the end of said interconnection pin 7.

[0065] A washer 15 through which the interconnection pin 7 passes, is inserted between the lower jaw 9 of the second coupling element 8 and the ring nut 14.

[0066] In brief, the first multi-seat coupling element 2 is mounted onto the head of the interconnection pin 7 and it is able to move freely and angularly, while the second rod coupling element 8 is rotatably mounted onto the interconnection pin 7.

[0067] A spring 11 is inserted between the first multi-seat coupling element 2 and the second rod coupling element 8 around the interconnection pin 7. This spring 11 is compressed between the lower jaw 4 of the first coupling element 2 and the upper jaw 10 of the second coupling element 8 and concealingly housed in impressions on the opposite surfaces of these jaws. The spring 11 defines a fastening preload exerted by the jaws on the elements inserted into the seats of the coupling elements before locking the clamp.

[0068] Moreover, a central joint 16 with a central hole for the passage of the interconnection pin 7, is placed between the two coupling elements 2 and 3.

[0069] In order to avoid sliding during the usual assembly operations, respective anti-rotation means 17 are present on the surface of the upper jaw 10 of the second coupling element 8 and on

+61 3 9870 4200

11

the surface of the central joint 16; in the example these means are formed integrally with the body of the piece itself and they comprise a plurality of radially oriented grooves on a crown placed around the central hole.

[0070] Advantageously, the head of the interconnection pin 7 has a through-hole to allow an eccentric body 12 to be transversely inserted along a secondary axis of rotation  $y$  into a bush 19. This eccentric body 12 has, on the two opposite sides accessible from the outside, on the sides of the lower jaw 4 of the first coupling element 2, a respective hollow socket head 18 to receive a control socket wrench.

[0071] The simple rotation of the eccentric body 12 allows it to be locked in its seat and at the same time to bring the free end of the interconnection pin 7 nearer the first coupling element 2, thus defining a relative locking of the various elements of which clamp 1 is composed.

[0072] The clamp 1 can have a slack configuration in which the jaws of the second coupling element 8 are not fastened, the second coupling element 8 is rotatable with respect to the interconnection pin 7 along the main axis of rotation  $x$  and the axis of the interconnection pin 7 is rotatable with respect to the first coupling element 2 along the secondary axis of rotation  $y$ . In this slack configuration, therefore, two degrees of rotational freedom are present, together allowing for a proper relative positioning of the first coupling element and the second coupling element 8. In alternative the clamp 1 can have a locked configuration in which the two coupling elements 2, 8 are relatively integral with each other and the jaws of the second coupling element 8 are fastened. It should be noted that the jaws of the first coupling element 2 are independent, since the fastening thereof is done by the closing screws 13 that are autonomous with respect to the interconnection pin 7.

[0073] The manual fastening of the fastening ring nut 14 allows the whole clamp 1 to be rapidly pre-closed with no need to use a wrench. This operation brings the clamp 1 from the slack configuration to a temporary locked configuration, which ensures the fastening of the jaws of the second coupling element and the relative locking of the two coupling elements, but does not ensure rigidity and stability over time of these conditions.

2011358377 06 May 2013

+61 3 9870 4200

12

[0074] Then, in order to change to a definitive locked configuration, in which rigidity and stability over time are ensured, it is necessary to rotate the eccentric body 12 by means of a control socket wrench.

[0075] The clamp according to the first embodiment described above has several advantages, such as:

- the use of a single clamp to connect the rod and endosseous pins;
- the presence of two degrees of rotational freedom for an easy relative positioning of the coupling elements;
- the option of manual pre-closure;
- the possibility to perform the fastening by a single rapid movement of the control wrench;
- the compatibility with MRI techniques.

[0076] When the clamp according to the first embodiment just described is used for upper limbs, it is possible to use the rod coupling element 8 in order to fix an endosseous pin, simply by changing the size of the various elements.

[0077] Therefore, where reference has been made to a rod coupling element, one should consider that this also comprises endosseous pin coupling elements.

[0078] According to a second embodiment of the present invention, figures 4-7 show a second clamp, globally indicated with 20, suitable to be used for the treatment of lower limbs, such as tibia, femur or pelvis. After a simple modification of the dimensions it is also possible to use this clamp for upper limbs, for example humerus and forearm, as well as for treatments of the foot and ankle.

[0079] The second clamp comprises a first two-seat coupling element 21 comprising an upper jaw 22 and a lower jaw 23, both provided with a central through-hole for an interconnection pin 24 that extends along a main axis of rotation  $x'$ .

+61 3 9870 4200

13

[0080] The two-seat coupling element 21 has, opposite each other on the two sides of the central hole, two C-shaped open seats to respectively house an endosseous pin and a rod. Again it is possible to adapt the dimensions of said opposite open seats, so that both seats are able to house a respective endosseous pin.

[0081] The open seats are therefore placed in an eccentric and orthogonal manner with respect to the main axis of rotation  $x'$ .

[0082] An insert 25 is provided between the upper jaw 22 and the lower jaw 23 on the jaw portion that is intended to house the endosseous pin.

[0083] This insert is made of a different material than the material used to realize the two-seat coupling element 21, in particular a non-conductive material, when the coupling element is preferably made of steel.

[0084] More particularly, it is preferable that this insert is made of a radio-transparent material that is MRI-compatible.

[0085] The clamp according to the second embodiment of the present invention further comprises a second coupling element 31 having a lower jaw 33 and an upper jaw 34.

[0086] This second coupling element has a single lateral C-shaped seat for clamping between the jaws.

[0087] These lower 33 and upper 34 jaws of the second coupling element 31 of the clamp 20 also have a central through-hole to allow the interconnection pin 24 to pass through.

[0088] This interconnection pin 24 has at its free end a threading that matches a corresponding internal threading that is present at least partially in the through-hole of the lower jaw 33 of the second coupling element 31.

[0089] In this manner the first two-seat coupling element 21 is rotatably mounted with respect to the interconnection pin 24, while the second coupling element 31 is rotatably constrained to the interconnection pin 24 to which it is screwed by means of its own lower jaw 33.



+61 3 9870 4200

14

[0090] Basically the lower jaw 33 functions like a nut into which the entire second clamp 20 can be screwed.

[0091] A spring 26 is inserted between the first two-seat coupling element 21 and the second coupling element 31 around the interconnection pin 24. This spring 26 is compressed between the lower jaw 23 of the first two-seat coupling element 21 and the upper jaw 34 of the second coupling element 31, and concealingly housed in impressions on the opposite surfaces of these jaws. The spring defines a fastening preload exerted by the jaws on the elements inserted into the seats of the coupling elements before locking the clamp.

[0092] In order to avoid sliding during the usual assembly operations, respective anti-rotation means 27 are present on the opposite surfaces of the upper jaw 34 of the second coupling element 31 and of the lower jaw 23 of the first coupling element 21; in the example these means are formed integrally with the body of the piece itself and they comprise a plurality of radially oriented grooves on a crown placed around the central hole.

[0093] Advantageously, the end of the interconnection pin 24 opposite the one that is screwed on the second coupling element 31 has an enlargement with the shape of a connecting rod head. This connecting rod head has a through-hole to allow an eccentric body 28 to be transversely inserted with the interposition of a bush 30. This eccentric body 28 has, on the two opposite sides, a hollow socket head 29 to receive a control socket wrench.

[0094] A manually rotatable ring nut 35, through which the eccentric body 28 passes as well, encloses the head of the interconnection pin 24. In particular, this ring nut 35 has a central slot into which the head of the interconnection pin 24 fits perfectly and a central hole through which the shank of the interconnection pin 24 passes.

[0095] It should be noted that the rotation of the eccentric body 28 in the ring nut 35 allows it to be locked and at the same time the second coupling element 31 to be pressed against the first two-seat coupling element 21, thus defining a relative locking between the various elements of which the clamp 20 is composed.

[0096] A washer 32 through which the interconnection pin 24 passes, is inserted between the ring nut 35 and the upper jaw 22 of the first two-seat coupling element 21.

+61 3 9870 4200

15

[0097] The clamp 20 can have a slack configuration in which the jaws of the coupling elements 21, 31 are not fastened and the first two-seat coupling element 21 is rotating with respect to the second coupling element 31 around the main axis of rotation  $x'$ . In this slack configuration, therefore, a degree of rotational freedom is defined that allows the first two-seat coupling element 21 and of the second coupling element 31 to be positioned properly relative to each other. In alternative, the clamp 20 can have a locked configuration in which the jaws are fastened and the two coupling elements 21, 31 are integral with one other.

[0098] The manual fastening of the fastening ring nut 35 allows the whole clamp 20 to be rapidly pre-closed with no need to use a wrench. This operation brings the clamp 20 from the slack configuration to a temporary locked configuration, which ensures the fastening of the jaws and the relative locking of the two coupling elements, but does not ensure the rigidity and stability over time of these conditions.

[0099] Then, in order to change to a definitive locked configuration, in which rigidity and stability over time are ensured, it is necessary to rotate the eccentric body 28 by means of a control socket wrench.

[0100] The clamp according to the second embodiment has several advantages, such as:

- the use of a single clamp to connect two rods or a rod to an endosseous pin;
- the presence of a degree of rotational freedom for an easy relative positioning of the coupling elements;
- the option of manual pre-closure;
- the possibility to perform the fastening by a single rapid movement of the control wrench;
- the compatibility with MRI techniques.

[0101] According to a third embodiment of the present invention, figures 8-10 show a third clamp, globally indicated with 40, suitable to be used for the treatment of upper limbs, such as wrist, shoulder, hands.

+61 3 9870 4200

16

[0102] The third clamp comprises a first two-seat coupling element 41 comprising an upper jaw 42 and a lower jaw 43, both provided with a central through-hole to allow an interconnection pin 44 orientated along a main axis of rotation  $x''$  to pass through.

[0103] The two-seat coupling element 41 has, next to the central hole and opposite to each other, open C-shaped seats to respectively house an endosseous pin 101 and a rod. It is also possible to modify the dimensions of these seats so that both are able to house an endosseous pin.

[0104] The open seats are therefore placed in an eccentric and orthogonal manner with respect to the main axis of rotation  $x''$ .

[0105] An insert 45 is provided between the upper jaw 42 and the lower jaw 43 on the jaw portion that is intended to house the endosseous pin.

[0106] This insert is made of a different material than the material being used to realize the coupling element 41, in particular a non-conductive material, when the coupling element 41 is preferably made of steel.

[0107] More particularly, it is preferable that this insert 45 is made of a radio-transparent material that is MRI-compatible.

[0108] The third clamp 40 according to the present invention further comprises a second coupling element 46 having a lower jaw 47 and an upper jaw 48.

[0109] This second coupling element has a single opening for clamping a rod 100 between the jaws.

[0110] These lower 47 and upper 48 jaws of the second coupling element 41 of the third clamp 40 also have a central through-hole to allow the interconnection pin 44 to pass through.

[0111] This interconnection pin 44 has at its free end a threading that matches a corresponding internal threading that is present at least partially in the through-hole of the lower jaw 47 of the second coupling element 46.

2011358377 06 May 2013

+61 3 9870 4200

17

[0112] In this manner the first two-seat coupling element 41 is rotatably mounted with respect to the interconnection pin 44, while the second coupling element 46 is rotatably constrained to the interconnection pin 44 to which it is screwed by means of its own lower jaw 47.

[0113] Basically the lower jaw 47 functions like a nut into which the entire third clamp 40 can be screwed.

[0114] A spring 49 is inserted between the first two-seat coupling element 41 and the second coupling element 46 around the interconnection pin 44. This spring 49 is compressed between the lower jaw 43 of the first two-seat coupling element 41 and the upper jaw 48 of the second coupling element 46, and concealingly housed in impressions on the opposite surfaces of these jaws. The spring 49 defines a fastening preload exerted by the jaws on the elements inserted into the seats of the coupling elements before locking the clamp.

[0115] In order to avoid sliding during the usual assembly operations, respective anti-rotation means 50 are present on the surface of the upper jaw 48 of the second coupling element 46 and on the surface of the lower jaw 43 of the first coupling element 41; in the example these means are formed integrally with the body of the piece itself to which it is fixed and they comprise a plurality of radially oriented grooves on a crown placed around the central hole.

[0116] The end of the interconnection pin 44 opposite the one that is screwed on the second coupling element 46 has an expansion that is shaped like a planar fastening ring nut 51 that can be operated manually from the outside. In the middle of its free surface this fastening ring nut 51 has a socket hollow 53 to receive a control socket wrench.

[0117] A washer 52 through which the interconnection pin 44 passes, is inserted between the fastening ring nut 51 of the interconnection pin 44 and the upper jaw 42 of the first two-seat coupling element 41.

[0118] The third clamp 40 can have a slack configuration in which the jaws of the two coupling elements 41, 46 are not fastened and the first two-seat coupling element 21 is rotatable with respect to the second coupling element 46 around the main axis of rotation  $x''$ . In this slack configuration therefore a degree of rotational freedom is defined that allows the first two-seat coupling element 41 and the second coupling element 46 to be positioned properly relative to

+61 3 9870 4200

18

each other. In alternative, the clamp 40 can have a locked configuration in which the two coupling elements 41, 46 are integral with one other and their jaws are fastened.

[0119] The manual fastening of the fastening ring nut 51 allows the whole clamp 40 to be rapidly pre-closed with no need to use a control socket wrench. This operation brings the clamp 40 from the slack configuration to a temporary locked configuration, which ensures the fastening of the jaws and the relative locking of the two coupling elements, but does not ensure the rigidity and stability over time of these conditions.

[0120] Then, in order to change to a definitive locked configuration, in which rigidity and stability over time are ensured, it is necessary to insert a control socket wrench into the socket hollow 53 of the fastening ring nut 51 and to fasten it by means of this tool.

[0121] The clamp according to the third embodiment has several advantages, such as:

- the use of a single clamp to connect two rods or a rod to an endosseous pin;
- the presence of a degree of rotational freedom for an easy relative positioning of the coupling elements;
- the option of manual pre-closure;
- the compatibility with MRI techniques.

[0122] The external fixation modular system 200, 300 according to the present invention, shown in figures 13 and 14, can comprise one or more of the above-described clamps 1, 20, 40; moreover it can comprise a wire-carrier element 60 of the type shown in the attached figures 11-12.

[0123] This wire-carrier element 60, which is particularly useful in fixation systems for bone sites of the wrist and shoulder, allows one or two Kirchner wires to be supported or alternatively as many screws 102 of reduced diameter ( $D=2,5$  mm), partially or fully threaded.

[0124] The wire-carrier element 60 comprises a shank 61 and a fastening plate 62.

[0125] The main shank has a threaded portion 63, onto which said fastening plate 62 is screwed, and a non-threaded gripping portion 64; the two portions are divided by an abutting plate 65.

[0126] The fastening plate 62 has on its surface turned towards the abutting plate 65, when in use, four peripheral teeth 68, equiangularly spaced along the circumference of said plate.

[0127] When screwing the fastening plate 62 onto the threaded portion 63 of the shank 61, the four peripheral teeth 68 abut against a flat surface of the abutting plate 65, thus defining wire seats in collaboration with the shank 61 portion connecting the two plates.

[0128] Both the shank 61 and the fastening plate 62 comprise hexagonally shaped portions 66 on the external surface of the fastening/abutting plates for the insertion of a control wrench. The shank 61 also comprises a hexagonal hollow 67 located at the end of its gripping portion 64.

[0129] In order to insert a wire or a screw in the wire-carrier element 60, the wire or the screw is inserted in the channel defined by two peripheral teeth 68 on one side and by the shank 61 on the other side; a second wire or a second screw is then inserted in the channel defined on the other side of the shank by the peripheral teeth 68 opposite the first ones. A pair of parallel wires or screws can thus be associated to the wire-carrier element 60.

[0130] In order to associate the wire-carrier element 60 to the rest of the external fixation system, it is sufficient to lock its gripping portion 64 inside a coupling element of one of the system clamps.

[0131] The wire-carrier element described above has several advantages, such as:

- the possibility to use a normal clamp to connect rods or endosseous pins to Kirchner wires or screws of limited diameter;
- the possibility of an easy relative positioning of the elements to be connected;
- the secure fixing of wires or screws locked by the wire-carrier element;

+61 3 9870 4200

20

- the high structural simplicity of the wire-carrier element, which consists of only two components.

[0132] Modular external fixation systems 200, 300 according to the present invention, which can be seen in two alternative embodiments in figure 13 and 14, comprise, in addition to the above-described innovative components, rods 100 and endosseous pins 101, 102 of the known type.

[0133] "Comprises/comprising" when used in this specification is taken to specify the presence of stated features, integers, steps or components but does not preclude the presence or addition of one or more other features, integers, steps, components or groups thereof."

[0134] The discussion throughout this specification comes about due to the realisation of the inventors and/or the identification of certain prior art problems by the inventors. Any discussion of documents, devices, acts or knowledge in this specification is included to explain the context of the invention. It should not be taken as an admission that any of the material forms a part of the prior art base or the common general knowledge in the relevant art in Australia or elsewhere on or before the priority date of the disclosure and claims herein.

2011358377 06 May 2013

+61 3 9870 4200

21

## CLAIMS

1. Clamp (1; 20; 40) for an orthopaedic external fixation system (200; 300) comprising:
- a first coupling element (2; 21), comprising a pair of opposite jaws (3; 4; 22, 23) together defining one or more seats able to house at least a first component of the orthopaedic external fixation system (200; 300);
  - a second coupling element (8; 31), comprising a pair of opposite jaws (9, 10; 33, 34) together defining one or more seats able to house at least a second component of the orthopaedic external fixation system (200; 300);
  - an interconnection pin (7; 24) that passes through and connects the first (2; 21) and second (8; 31) coupling elements along a main axis of rotation (x; x");
  - fastening means arranged to bring the clamp (1; 20) from a slack configuration, in which the first (2; 21) and second coupling elements (8; 31) are relatively rotatable at least along the main axis of rotation (x; x"), to a locked configuration, in which the first (2; 21) and second coupling elements (8; 31) are relatively integral with each other;

wherein said fastening means comprise:

- temporary fastening means, manually operable, arranged to temporarily bring the clamp (1; 20) in the locked configuration;
- definitive fastening means, operable by means of a fastening tool, arranged to definitively bring the clamp (1; 20) in the locked configuration, wherein said temporary fastening means comprise a fastening ring nut (14; 35) arranged to fasten together the first (2; 21) and second coupling elements (8; 31) along the interconnection pin (7; 24), characterized in that said definitive fastening means comprise an eccentric body (12; 28), rotatably mounted on a hinging body that is axially integral with either one of the first (2; 21) or of the second coupling elements (8; 31), said eccentric body (12; 28) passing through a connecting rod head of the interconnection pin (7; 24) along an axis that is perpendicular to the

06 May 2013

2011358377



+61 3 9870 4200

22

main axis of rotation (x), the opposite end of said interconnection pin (7, 24) being constrained to the other between the first (2; 21) and second coupling elements (8; 31), the rotation of said eccentric body (12; 28) with respect to the hinging body promoting a translation of the opposite end of the interconnection pin (7; 24) towards said hinging body and as a result to relatively bring the two coupling elements (2, 8; 21, 31) nearer each other.

2. Clamp (1; 20; 40) according to claim 1, wherein said fastening ring nut (14; 35) has a cylindrical peripheral handling surface.
3. Clamp (1; 20) according to claim 2, wherein said cylindrical peripheral handling surface is knurled.
4. Clamp (1; 20) according to any one of the previous claims, wherein the interconnection pin (7; 24) passes through both single jaws of at least one of the pairs of jaws (3, 4; 22, 23; 9, 10; 33, 34), said pair of jaws as a result not being fastened in the slack configuration of the clamp (1; 20) and fastened in the locked configuration of the clamp (1; 20).
5. Clamp (1; 20) according to claim 4, further comprising a spring (11; 26) interposed between the first (2; 21) and second coupling elements (8; 31).
6. Clamp (20) according to any of the previous claims, wherein said fastening ring nut (35) is axially constrained to an end of the interconnection pin (24), the opposite end being threaded and engaging an at least partially threaded hole of the second coupling element (31), said first coupling element (21) being interposed between the fastening ring nut (35) and the second coupling element (24).
7. Clamp (20) according to claim 6, wherein said fastening ring nut (35) encloses a connecting rod head of the interconnection pin (24), said definitive locking means comprising an eccentric body (28), rotatably mounted on the fastening ring nut (35), that passes through said connecting rod head along an axis that is perpendicular to the main axis of rotation (x), the rotation of said eccentric body (28) with respect to the fastening ring nut (35) promoting a translation of the end of the interconnection pin (24) engaged in the second coupling element (31) towards the fastening ring nut (35).

+61 3 9870 4200

23

8. Clamp (1) according to any of the claims 1 to 5 wherein said fastening ring nut (14) abuts against the outermost jaw (9) of the second coupling element (8), said hinging body corresponding to the first coupling element (2), the end of the interconnection pin (7) opposite the connecting rod head being threaded and constrained by screwing to the fastening ring nut (14).

9. Clamp (1) according to claim 8, wherein said eccentric body (12) hinges the first coupling element (2) to the interconnection pin (7) along a secondary axis of rotation (y), defining a second degree of rotational freedom between the first coupling element (2) and the second coupling element (8) in the slack configuration of the clamp (1).

10. Clamp (1) according to claim 9, wherein said eccentric body (12) is hinged on a base portion (6) developing towards the second coupling element (8) like a protuberance of the innermost jaw (4) of the first coupling element (2).

11. Clamp (1) according to claim 10, wherein a central joint (16) is placed between the base portion (6) and the second coupling element (8), through which the interconnection pin (7) passes, said central joint (16) presenting a sliding face along a concave periphery of the base portion (6) and a flat face intended to couple with a surface of the internal jaw (10) of the coupling element (8).

12. Orthopaedic external fixation system (200; 300) comprising at least one of the clamps according to any of the previous claims.

13. Orthopaedic external fixation system (300) according to claim 12, further comprising at least a wire-carrier element (60), arranged to allow at least a Kirchner wire or other fixator (102) of limited diameter to be fixed to one of the system clamps, said wire-carrier element (60) comprising a shank (61) with a threaded portion (63) whereon a fastening plate (62) is screwed until it abuts against an abutting plate (65) that is integral with the shank (61).

14. Orthopaedic external fixation system (300) according to claim 13, wherein said shank (61) comprises a gripping portion (64) intended to be locked between the jaws of one of the system clamps.

+61 3 9870 4200

24

15. Orthopaedic external fixation system (300) according to claim 14, wherein the fastening plate (62) has, on one of its faces turned towards the abutting plate (65), four peripheral teeth (68), equiangularly spaced along the circumference of said plate, and arranged to abut against a flat surface of the abutting plate (65), defining, in collaboration with the shank (61) portion comprised between the two plates (62, 65), a seat for a Kirchner wire or other fixator (102) of limited diameter.

2011358377 06 May 2013

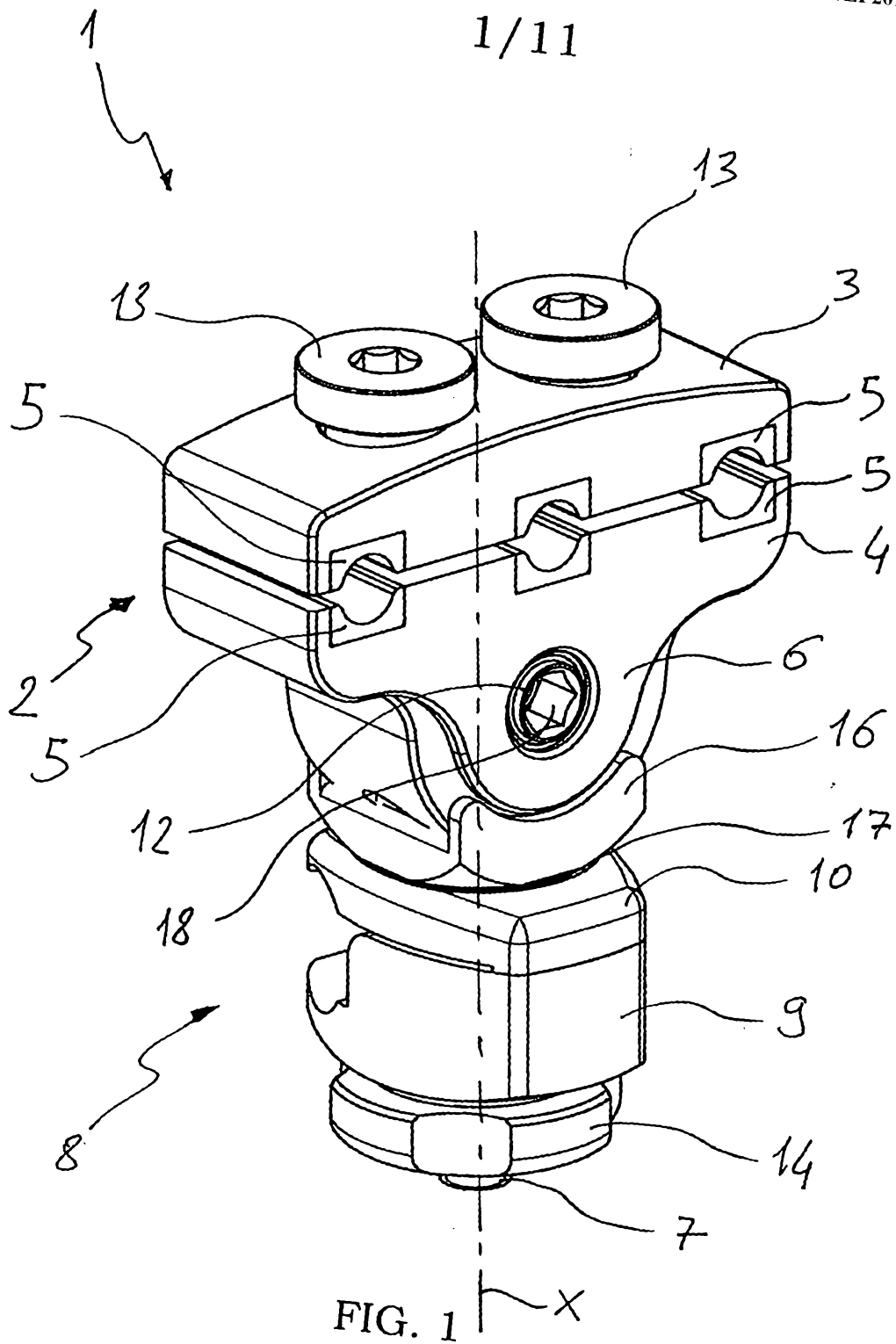

2/11

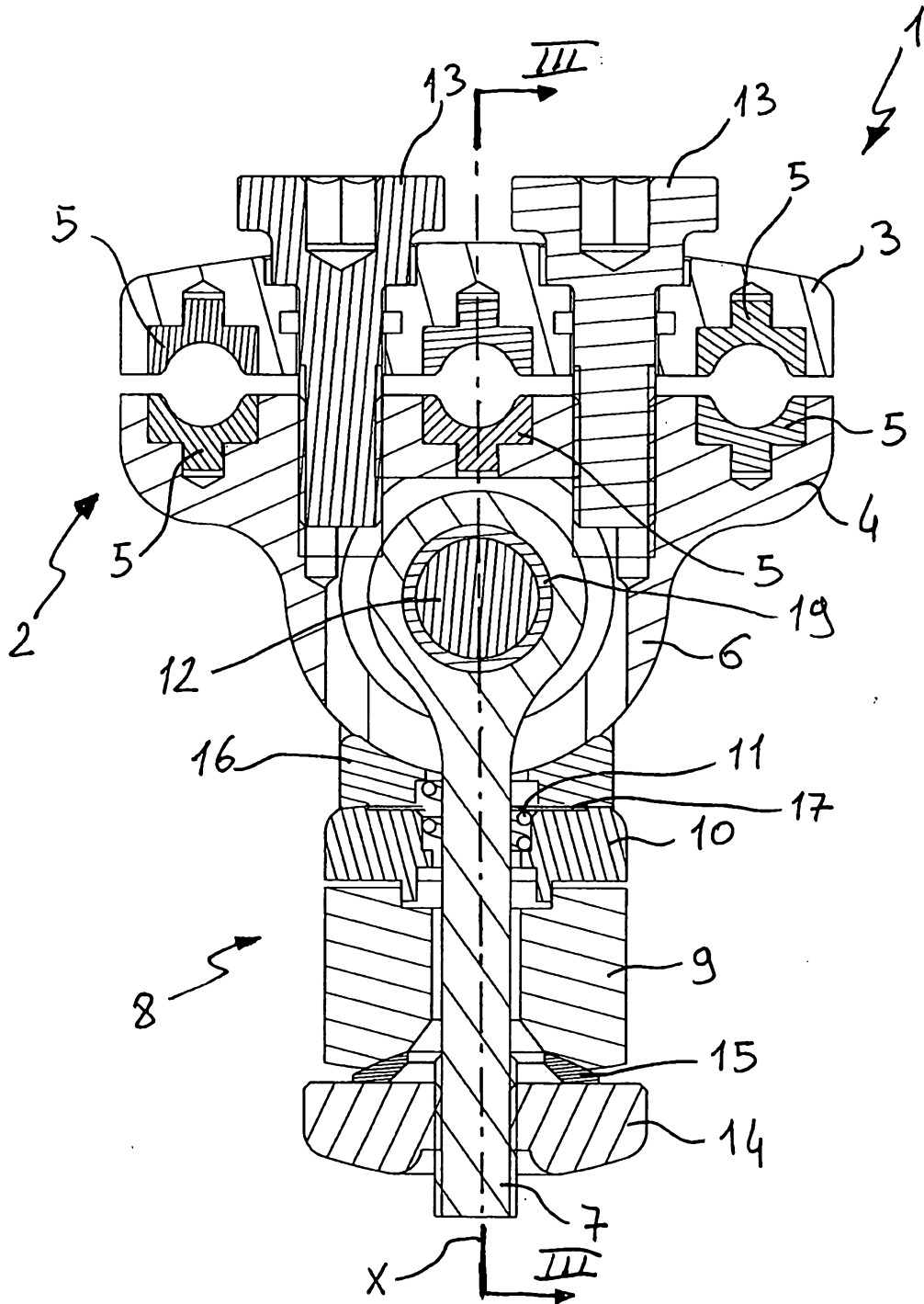

FIG. 2

3/11

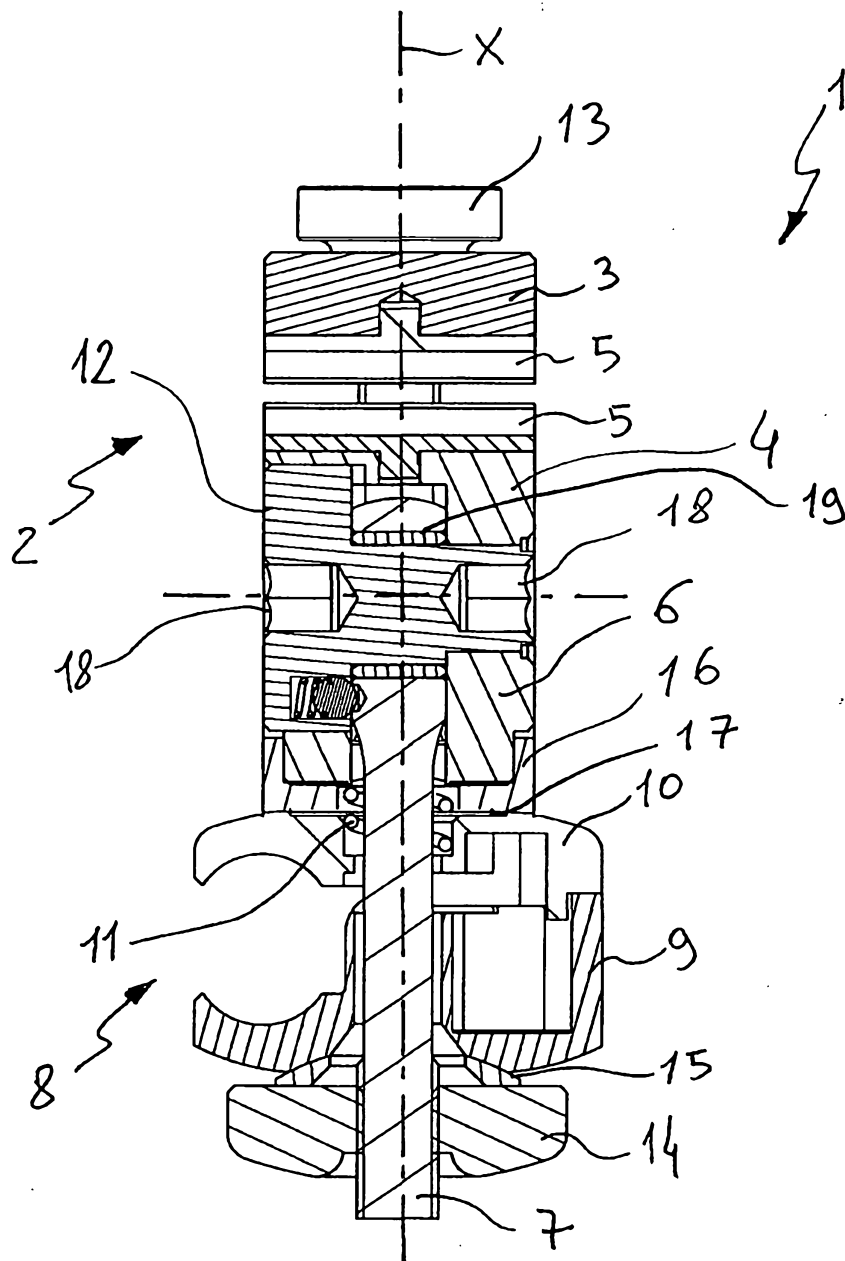

FIG. 3

4/11

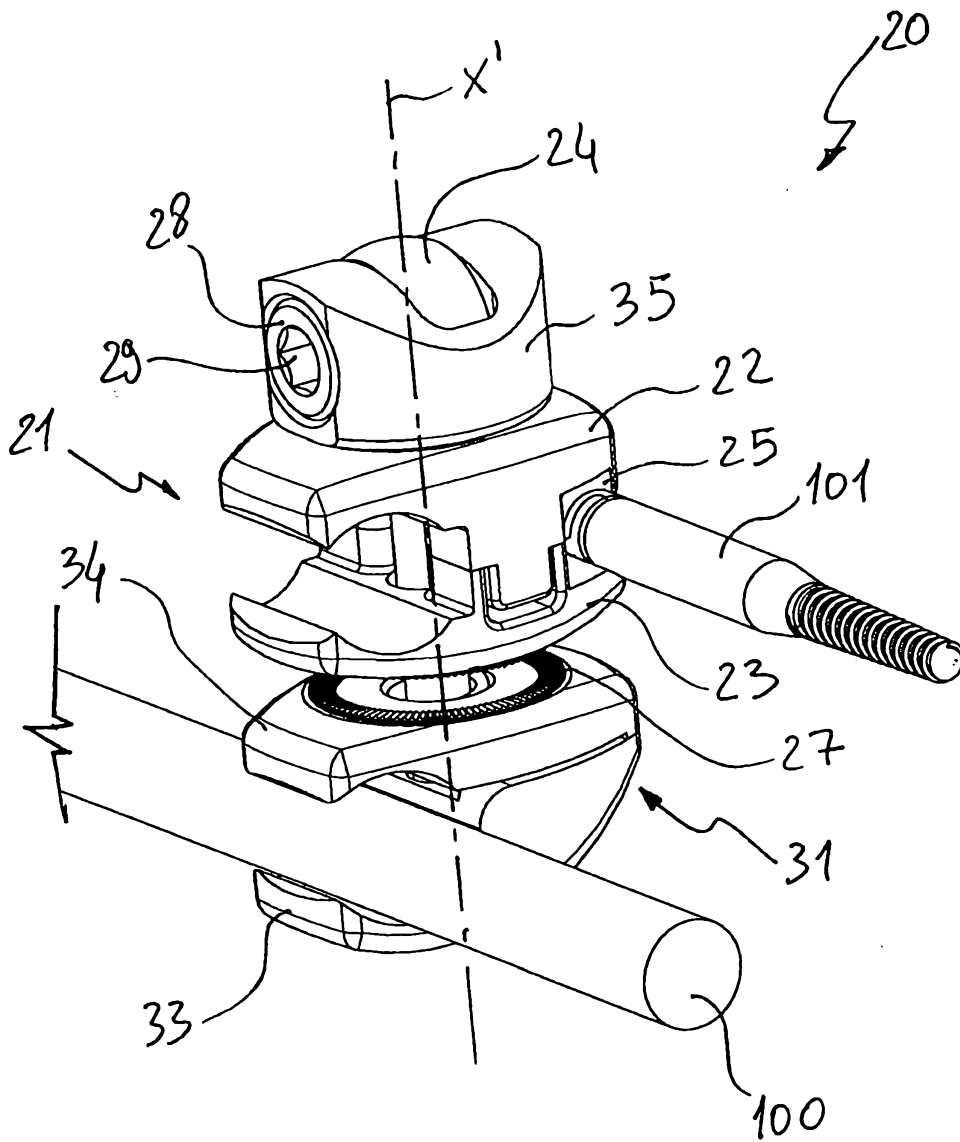

FIG. 4

5/11

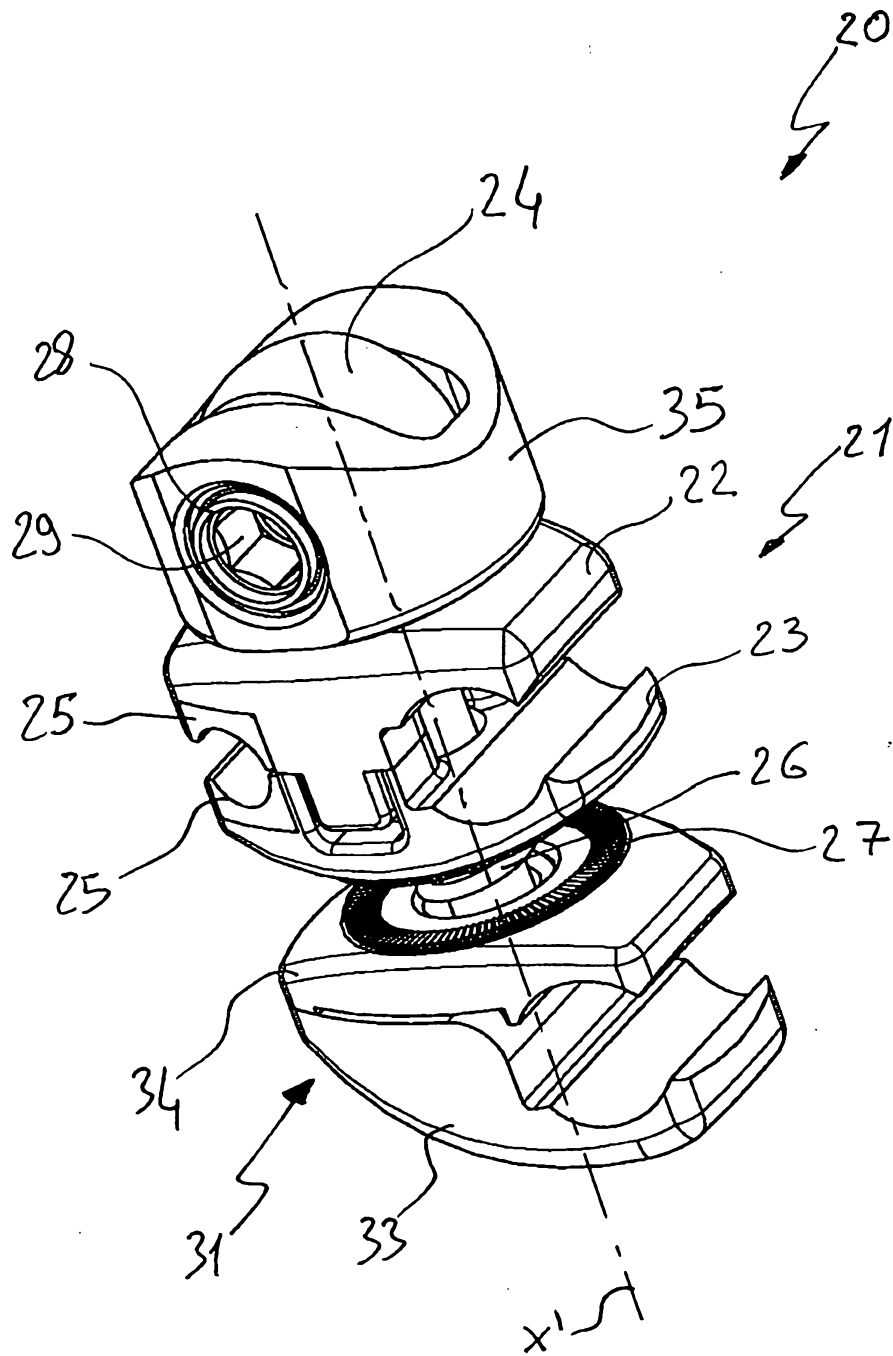

FIG. 5



6/11

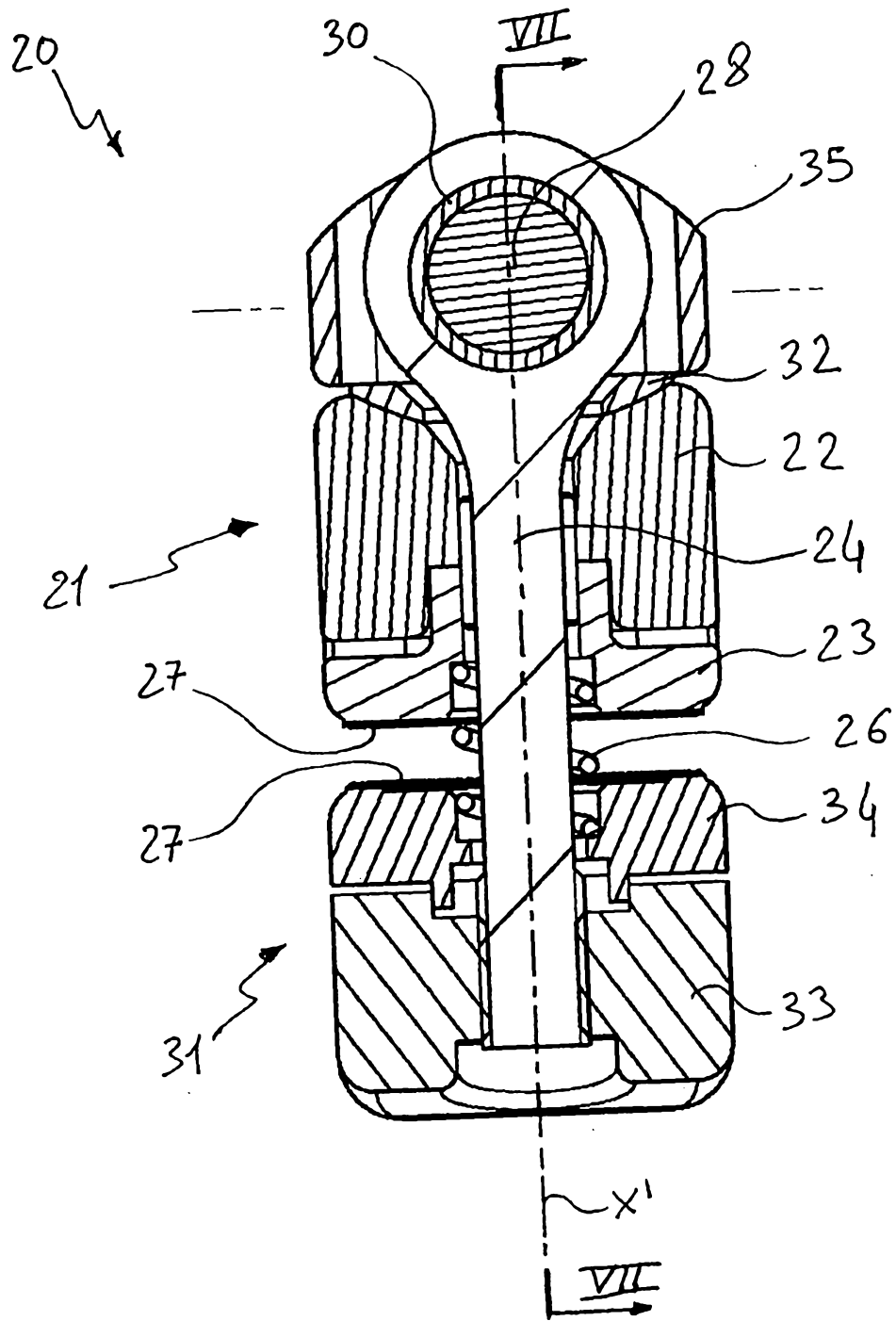

FIG. 6

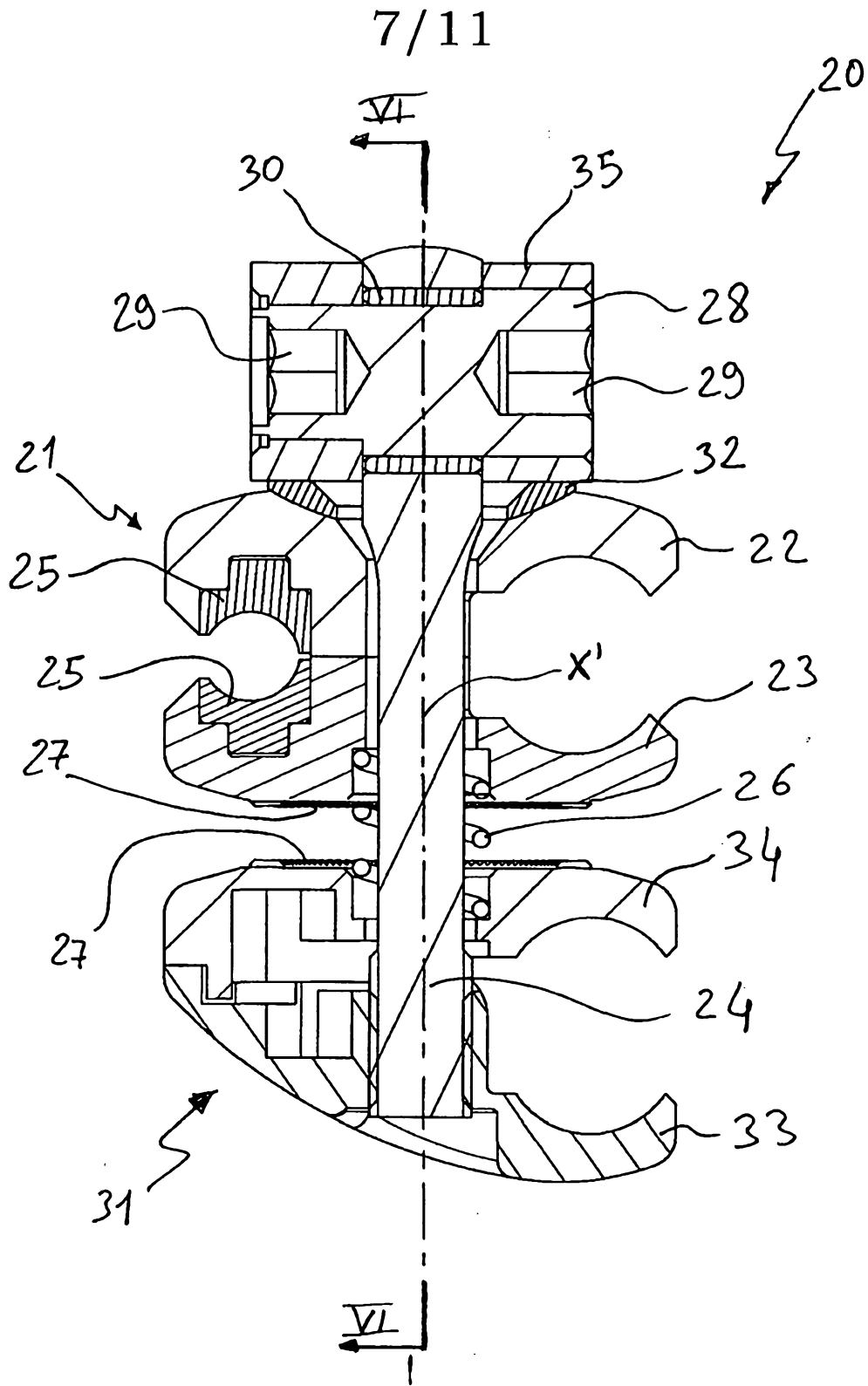

FIG. 7

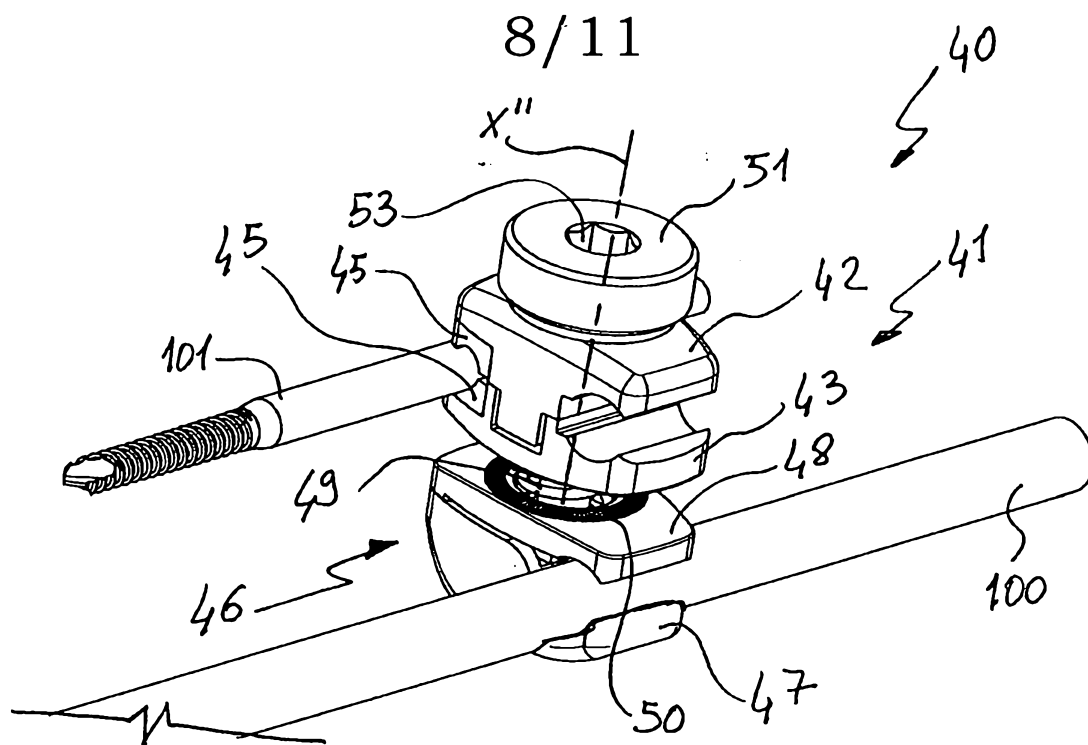

FIG. 8

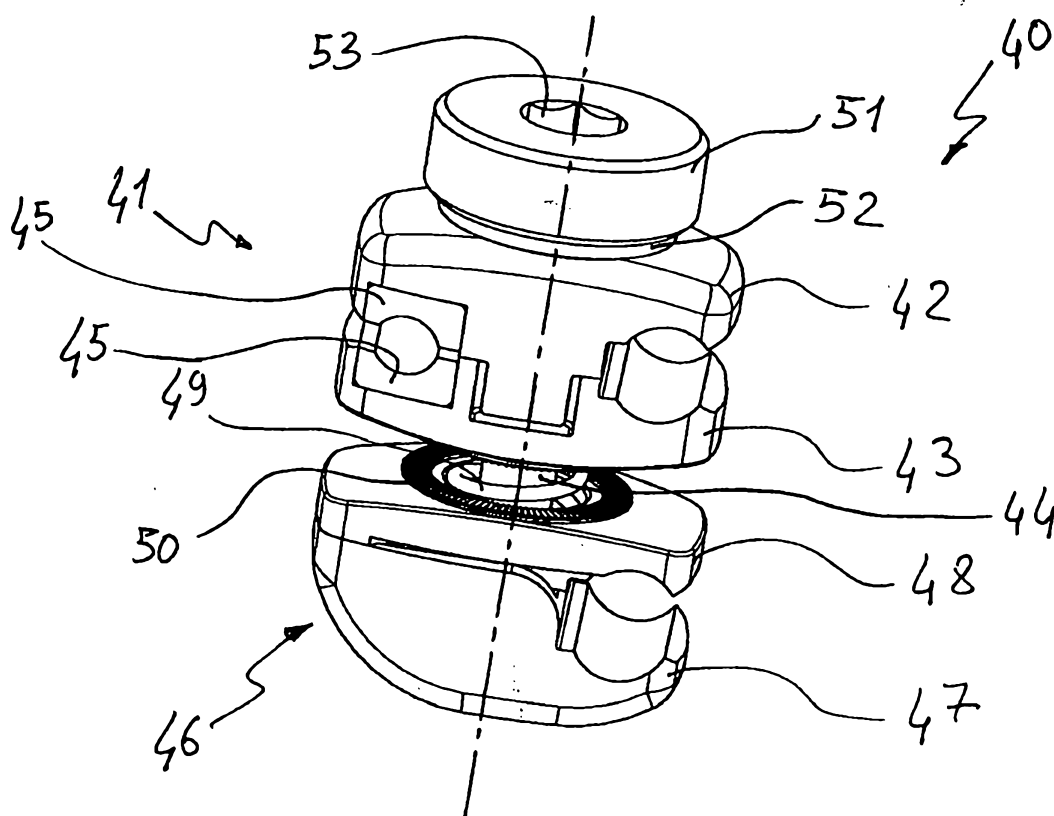

FIG. 9

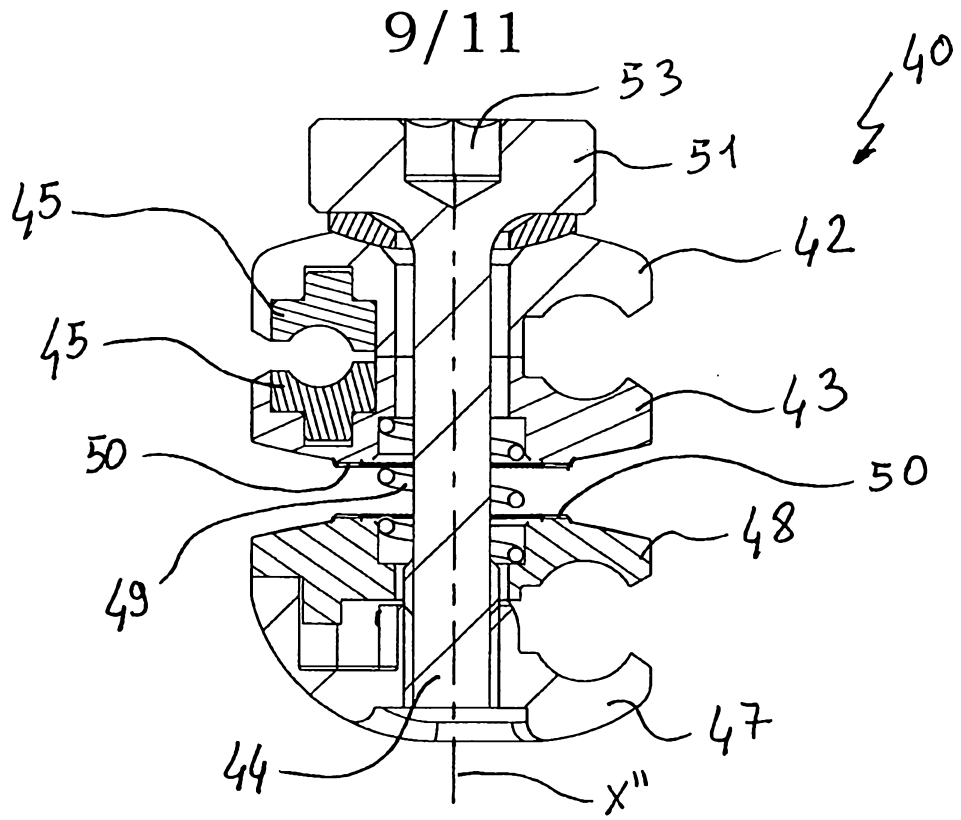

FIG. 10

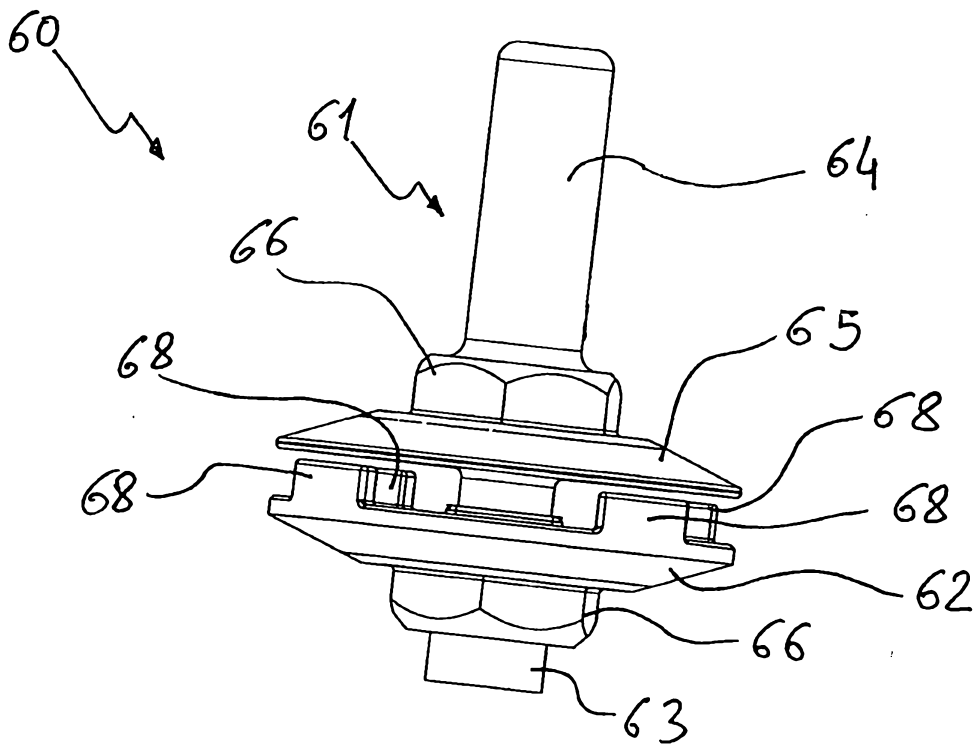

FIG. 11

10/11

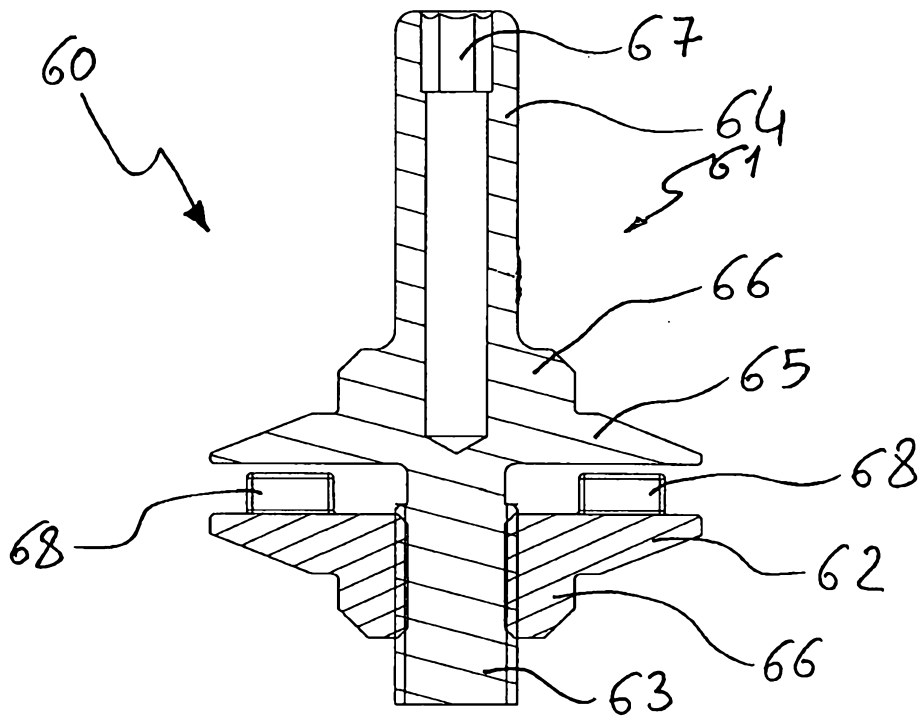

FIG. 12

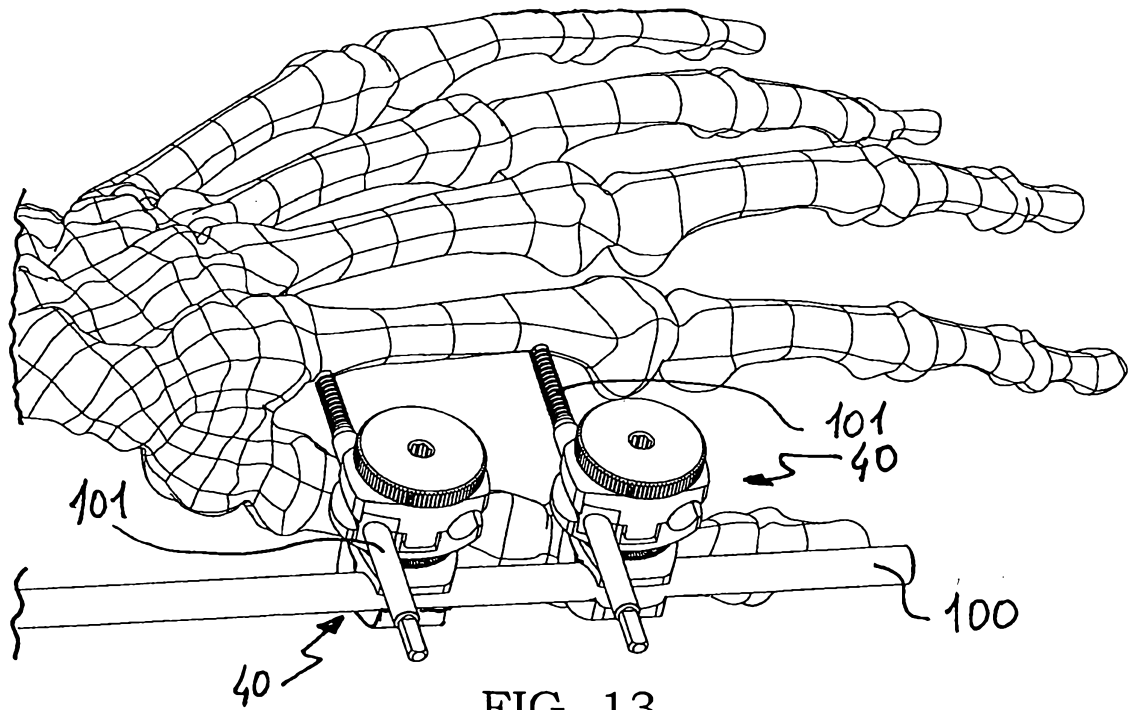

FIG. 13

