



US012041326B2

(12) **United States Patent**  
**Woodman**

(10) **Patent No.:** **US 12,041,326 B2**  
(45) **Date of Patent:** **\*Jul. 16, 2024**

(54) **CAMERA HOUSING WITH EXPANSION MODULE**

(71) Applicant: **GoPro, Inc.**, San Mateo, CA (US)

(72) Inventor: **Nicholas D. Woodman**, Big Sky, MT (US)

(73) Assignee: **GoPro, Inc.**, San Mateo, CA (US)

(\* ) Notice: Subject to any disclaimer, the term of this patent is extended or adjusted under 35 U.S.C. 154(b) by 135 days.

This patent is subject to a terminal disclaimer.

(21) Appl. No.: **17/331,171**

(22) Filed: **May 26, 2021**

(65) **Prior Publication Data**

US 2021/0281719 A1 Sep. 9, 2021

**Related U.S. Application Data**

(60) Continuation of application No. 16/516,846, filed on Jul. 19, 2019, now Pat. No. 11,025,802, which is a (Continued)

(51) **Int. Cl.**  
**H04N 23/51** (2023.01)  
**G03B 17/02** (2021.01)  
(Continued)

(52) **U.S. Cl.**  
CPC ..... **H04N 23/51** (2023.01); **G03B 17/02** (2013.01); **G03B 17/08** (2013.01); **G03B 17/56** (2013.01);  
(Continued)

(58) **Field of Classification Search**

CPC ..... H04N 5/2252; H04N 5/2251; H04N 5/225251; H04N 5/232; H04N 5/23209;  
(Continued)

(56) **References Cited**

U.S. PATENT DOCUMENTS

2,944,474 A 7/1960 Dennis  
3,073,227 A 1/1963 Richard  
(Continued)

FOREIGN PATENT DOCUMENTS

EP 1653423 A1 5/2006  
GB 2363028 A 12/2001  
(Continued)

OTHER PUBLICATIONS

'GoPro Hero 3 Sports Wrist Camera Review,' PaddleDogNation, 2006, 6 pages, [Online] [Retrieved on Aug. 8, 2007] Retrieved from the Internet <URL:http://paddledognation.com/Reviews/PaddlingGearReviews/He-ro3Ca . . . >.

(Continued)

*Primary Examiner* — Shahbaz Nazrul

(74) *Attorney, Agent, or Firm* — Young Basile Hanlon & MacFarlane, P.C.

(57) **ABSTRACT**

A camera expansion device includes a housing and a power supply within the housing. The power supply is configured to power an imaging device. The camera expansion device includes a securing structure extending from the housing for securing the housing to a separate mounting device and an interface configured to facilitate power transfer between the camera expansion device and the imaging device.

**20 Claims, 16 Drawing Sheets**

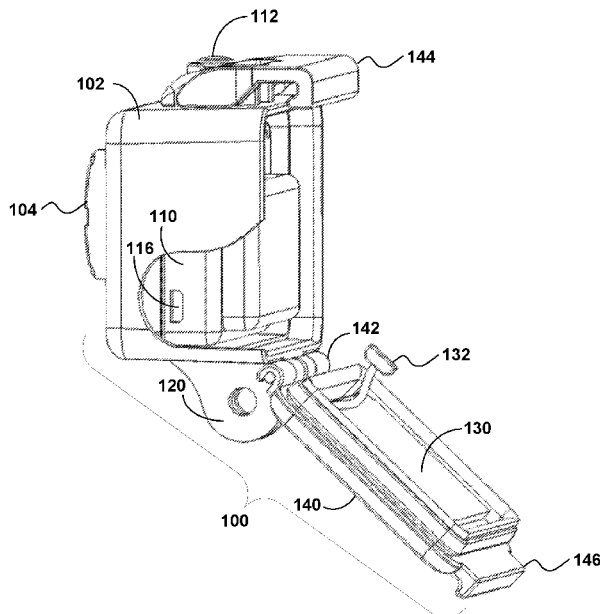

**Related U.S. Application Data**

continuation of application No. 16/426,065, filed on May 30, 2019, now Pat. No. 10,986,253, which is a continuation of application No. 15/612,917, filed on Jun. 2, 2017, now Pat. No. 10,356,291, which is a continuation of application No. 15/187,708, filed on Jun. 20, 2016, now Pat. No. 9,699,360, which is a continuation of application No. 14/132,554, filed on Dec. 18, 2013, now abandoned, which is a continuation of application No. 13/665,594, filed on Oct. 31, 2012, now Pat. No. 8,638,392, which is a continuation of application No. 13/469,926, filed on May 11, 2012, now Pat. No. 8,325,270, which is a division of application No. 12/498,890, filed on Jul. 7, 2009, now Pat. No. 8,199,251.		6,741,287 B1	5/2004	Fuchimukai	
		6,809,759 B1	10/2004	Chiang	
		6,955,484 B2	10/2005	Woodman	
		7,129,981 B2	10/2006	Bersts	
		7,196,722 B2	3/2007	White	
		7,327,396 B2	2/2008	Schultz	
		7,337,403 B2	2/2008	Pavley	
		7,362,352 B2	4/2008	Ueyama	
		7,379,664 B2	5/2008	Marcus	
		7,463,304 B2	12/2008	Murray	
		7,464,215 B2	12/2008	Kawai	
		7,496,293 B2	2/2009	Shamir	
		7,508,420 B2	3/2009	Kitajima	
		7,543,327 B1	6/2009	Kaplinsky	
		7,612,821 B1	11/2009	Hsia	
		7,643,056 B2	1/2010	Silsby	
		7,656,294 B2	2/2010	Boss	
		7,663,666 B2	2/2010	Kawai	
		7,671,886 B2	3/2010	Sawada	
		7,823,771 B2	11/2010	Sawachi	
		8,013,932 B2	9/2011	Chan	
		8,026,945 B2	9/2011	Garoutte	
		8,031,222 B2	10/2011	Crinon	
		8,194,145 B2	6/2012	Lee	
		8,194,174 B2	6/2012	Roskowski	
		8,199,251 B2	6/2012	Woodman	
		8,218,025 B2	7/2012	Yonaha	
		8,300,107 B2	10/2012	Strandwitz	
		8,325,270 B2	12/2012	Woodman	
		8,638,392 B2	1/2014	Woodman	
		8,830,326 B2	9/2014	Kitagawa	
		8,917,496 B2	12/2014	Richardson	
		9,596,388 B2	3/2017	Woodman	
		9,699,360 B2	7/2017	Woodman	
		10,356,291 B2	7/2019	Woodman	
		10,986,253 B2	4/2021	Woodman	
		11,025,802 B2	6/2021	Woodman	
		2001/0043281 A1	11/2001	Onuki	
		2002/0005907 A1	1/2002	Alten	
		2002/0075397 A1*	6/2002	Hanada	H04N 5/232 348/E5.025
(60)	Provisional application No. 61/078,756, filed on Jul. 7, 2008.				
(51)	<b>Int. Cl.</b>				
	<b>G03B 17/08</b> (2021.01)				
	<b>G03B 17/56</b> (2021.01)				
	<b>H04N 23/50</b> (2023.01)				
	<b>H04N 23/53</b> (2023.01)				
	<b>H04N 23/60</b> (2023.01)				
	<b>H04N 23/63</b> (2023.01)				
	<b>H04N 23/663</b> (2023.01)				
(52)	<b>U.S. Cl.</b>				
	CPC ..... <b>H04N 23/50</b> (2023.01); <b>H04N 23/531</b> (2023.01); <b>H04N 23/60</b> (2023.01); <b>H04N 23/63</b> (2023.01); <b>H04N 23/663</b> (2023.01); <b>G03B 2206/00</b> (2013.01)				
(58)	<b>Field of Classification Search</b>				
	CPC .... H04N 5/23293; H04N 23/51; H04N 23/50; H04N 23/531; H04N 23/60; H04N 23/63; H04N 23/663; G03B 17/02; G03B 17/08; G03B 17/56; G03B 2206/00				
	See application file for complete search history.				
(56)	<b>References Cited</b>				
	U.S. PATENT DOCUMENTS				
	3,860,937 A 1/1975 Wolfe				
	4,025,930 A 5/1977 Wolff				
	4,837,817 A 6/1989 Maemori				
	4,887,161 A 12/1989 Watanabe				
	4,888,795 A 12/1989 Ando				
	5,294,988 A 3/1994 Wakabayashi				
	5,327,265 A 7/1994 McDonald				
	5,486,852 A 1/1996 Arai				
	5,563,661 A 10/1996 Takahashi				
	5,627,587 A * 5/1997 Murata ..... H04N 1/2125 348/373				
	5,657,081 A 8/1997 Kurahashi				
	5,661,823 A 8/1997 Yamauchi				
	5,729,289 A 3/1998 Etoh				
	5,805,219 A 9/1998 Ejima				
	5,926,218 A 7/1999 Smith				
	5,946,501 A 8/1999 Hayakawa				
	5,969,750 A 10/1999 Hsieh				
	6,034,728 A 3/2000 Arena				
	6,035,147 A 3/2000 Kurosawa				
	6,118,929 A 9/2000 Kawamura				
	6,128,441 A 10/2000 Kamata				
	6,138,826 A 10/2000 Kanamori				
	6,332,146 B1 12/2001 Jebens				
	6,480,671 B2 11/2002 Takahashi				
	6,483,542 B1 11/2002 Morinaga				
	6,583,809 B1 6/2003 Fujiwara				
	6,727,954 B1 4/2004 Okada				
		2004/0201745 A1	10/2004	Wess	
		2004/0212687 A1	10/2004	Patwari	
		2005/0190263 A1	9/2005	Monroe	
		2006/0008262 A1	1/2006	Watanabe	
		2006/0015664 A1	1/2006	Zhang	
		2006/0042920 A1	3/2006	Kubo	
		2006/0061663 A1	3/2006	Park	
		2006/0066753 A1	3/2006	Gennetten	
		2006/0098966 A1	5/2006	Takahashi	
		2006/0139459 A1	6/2006	Zhong	
		2006/0216019 A1*	9/2006	Thompson	F16M 11/2014 348/E5.026
		2006/0262365 A1	11/2006	Imao	
		2006/0274157 A1	12/2006	Levien	
		2007/0024734 A1	2/2007	Headley	
		2007/0025711 A1	2/2007	Marcus	
		2007/0071423 A1	3/2007	Fantone	
		2007/0077062 A1	4/2007	Senba	
		2007/0109417 A1	5/2007	Hytffors	
		2007/0110416 A1	5/2007	Yamaguchi	
		2007/0126883 A1	6/2007	Ishige	
		2007/0244634 A1	10/2007	Koch	
		2007/0268382 A1	11/2007	Shiomi	
		2008/0072163 A1	3/2008	Teng	
		2008/0074487 A1	3/2008	Ryckman	
		2008/0100712 A1	5/2008	Hayes	
		2008/0122958 A1	5/2008	Huseth	
		2008/0170838 A1*	7/2008	Teetzel	A42B 3/042 348/E5.025
		2008/0180537 A1	7/2008	Weinberg	

(56)

References Cited

U.S. PATENT DOCUMENTS

2008/0316327	A1	12/2008	Steinberg	
2009/0032420	A1	2/2009	Zenzai	
2009/0060465	A1*	3/2009	Igarashi	H04N 5/77 386/224
2009/0109286	A1	4/2009	Ennis	
2010/0060747	A1	3/2010	Woodman	
2010/0079607	A1	4/2010	Won	
2010/0118158	A1	5/2010	Boland	
2010/0141762	A1	6/2010	Siann	
2010/0205537	A1	8/2010	Knighton	
2010/0220188	A1	9/2010	Renkis	
2010/0246669	A1	9/2010	Harel	
2010/0283843	A1	11/2010	Cai	
2010/0289904	A1	11/2010	Zhang	
2010/0333155	A1	12/2010	Royall	
2011/0147245	A1	6/2011	Yim	
2011/0298970	A1	12/2011	Shinohara	
2012/0224078	A1	9/2012	Woodman	
2013/0057758	A1	3/2013	Woodman	
2014/0104447	A1	4/2014	Woodman	
2016/0309064	A1	10/2016	Woodman	
2016/0373623	A1	12/2016	Woodman	
2017/0339319	A1	11/2017	Woodman	
2019/0281197	A1	9/2019	Woodman	
2019/0342474	A1	11/2019	Woodman	

FOREIGN PATENT DOCUMENTS

JP	2004080256	A	3/2004
WO	2004023795	A1	3/2004
WO	2004081713	A2	9/2004
WO	2005096760	A2	10/2005
WO	2007128317	A1	11/2007
WO	2007130146	A1	11/2007

OTHER PUBLICATIONS

'Tekkno Trading Project—Brandnews,' NSP, Jan. 2008, p. 59.  
 Canon, 'Wireless file Transmitter WFT-EF E,' 2009, 132 pages, [Online] [Retrieved on Feb. 11, 2015] Retrieved from the Internet<URL:http://shuttersnitch.com/downloads/manuals/canon/wft-e5-en.pdf.  
 CheesyCam.com, 'Remote LCD Live View + Remote Shutter for DSLR Video—Exciting!', Jul. 16, 2010, 12 pages, [Online] [Retrieved on Feb. 11, 2015] Retrieved from the Internet<URL:http://cheesycam.com/remote-lcd-live-view-for-dslr-video-exciting/>.  
 Guarnera, M. et al., 'Manet: Possible Applications with PDA in Wireless Imaging Environment', IEEE International Symposium, Sep. 2002, vol. 7, pp. 2394-2398, vol. 5, pp. 15-18.

Huang, J., "Part 19—Oct. 21: Interbike Bits and Baubles," Interbike Show, Las Vegas, Nevada, USA, Sep. 22-26, 2008, Cyclingnews.com, [Online] [Retrieved on Oct. 21, 2008] Retrieved from the Internet<URL:http://www.cyclingnews.com/tech/2008/shows/interbike08/?i-d=result...>. 3 pages.  
 Ion USA, 'Wi-Fi PODZ,' Date Unknown, 2 pages. [Online] [Retrieved Oct. 11, 2016] Retrieved from the internet <https://usa.ioncamera.com/shop/wi-fi-podz/>.  
 Non-Final Rejection for U.S. Appl. No. 13/665,594 dated Mar. 29, 2013, 25 Pages.  
 Non-Final Rejection for U.S. Appl. No. 12/498,890 dated Aug. 30, 2011, 31 Pages.  
 Norouzzhad, E. et al. "A High Resolution Smart Camera with GigE Vision Extension for Surveillance Applications," Second ACM/IEEE International Conference on Distributed Smart Cameras, 2008, 8 pages.  
 PCT International Search Report and Written Opinion, PCT Application No. PCT/US2009/049821, dated Sep. 3, 2009, 8 pages.  
 Re-Fuel, '24hr Action Pack Battery for GoPro Hero4, Hero3+ & Hero3,' Date Unknown, 5 pages. [Online] [Retrieved Oct. 11, 2016] Retrieved from the internet <https://re-fuel.com/action-packs/24hr-action-battery-pack.html>.  
 Sun, X. et al. "Region of Interest Extraction and Virtual Camera Control Based on Panoramic Video Capturing," IEEE Transactions on Multimedia, 2005, pp. 981-990, vol. 7, issue 5.  
 United States Office Action, U.S. Appl. No. 14/132,554, dated Apr. 24, 2015, 13 pages.  
 United States Office Action, U.S. Appl. No. 14/132,554, dated Dec. 3, 2015, 28 pages.  
 United States Office Action, U.S. Appl. No. 14/132,554, dated Feb. 26, 2016, 31 pages.  
 United States Office Action, U.S. Appl. No. 15/187,708, dated Oct. 7, 2016, 13 pages.  
 Volk, W., 'Go Pro's Digital Hero Camera,' Divester, Posted Dec. 5, 2008, [Online] [Retrieved on Sep. 16, 2009] Retrieved from the Internet<URL:http://www.divester.com/2006/12/05/go-pro-digital-hero-camera/>. 3 pages.  
 Yourdealer, 'Aputure Gigtube Digital Screen Remote Viewfinder gives you more remote control with most DSLRs,' 2009 Deals-World.com, Apr. 11, 2010, 3 pages, [Online] [Retrieved on Feb. 11, 2015] Retrieved from the Internet <URL:http://www.deals-world.com/deals/2010/04/11/aputure-gigtube-digital-screen-remote-viewfinder-gives-you-more-remote-control-with-most-dslrs/, Apr. 11, 2010.  
 youtube.com, Video for 'The Air Pro Wi-Fi Podz,' Aug. 18, 2014, 1 page, [Online] [Retrieved Oct. 11, 2016] Can be retrieved from the internet<URL:https://www.youtube.com/watch?v=YpWZ44aCdGA>.  
 youtube.com, Video for 'The WiFi PODZ Tutorial,' Jun. 15, 2012, 2 pages. [Online] [Retrieved Oct. 11, 2016] Can be retrieved from the internet <URL:https://www.youtube.com/watch?v=kGGwGobzQBg>.

\* cited by examiner

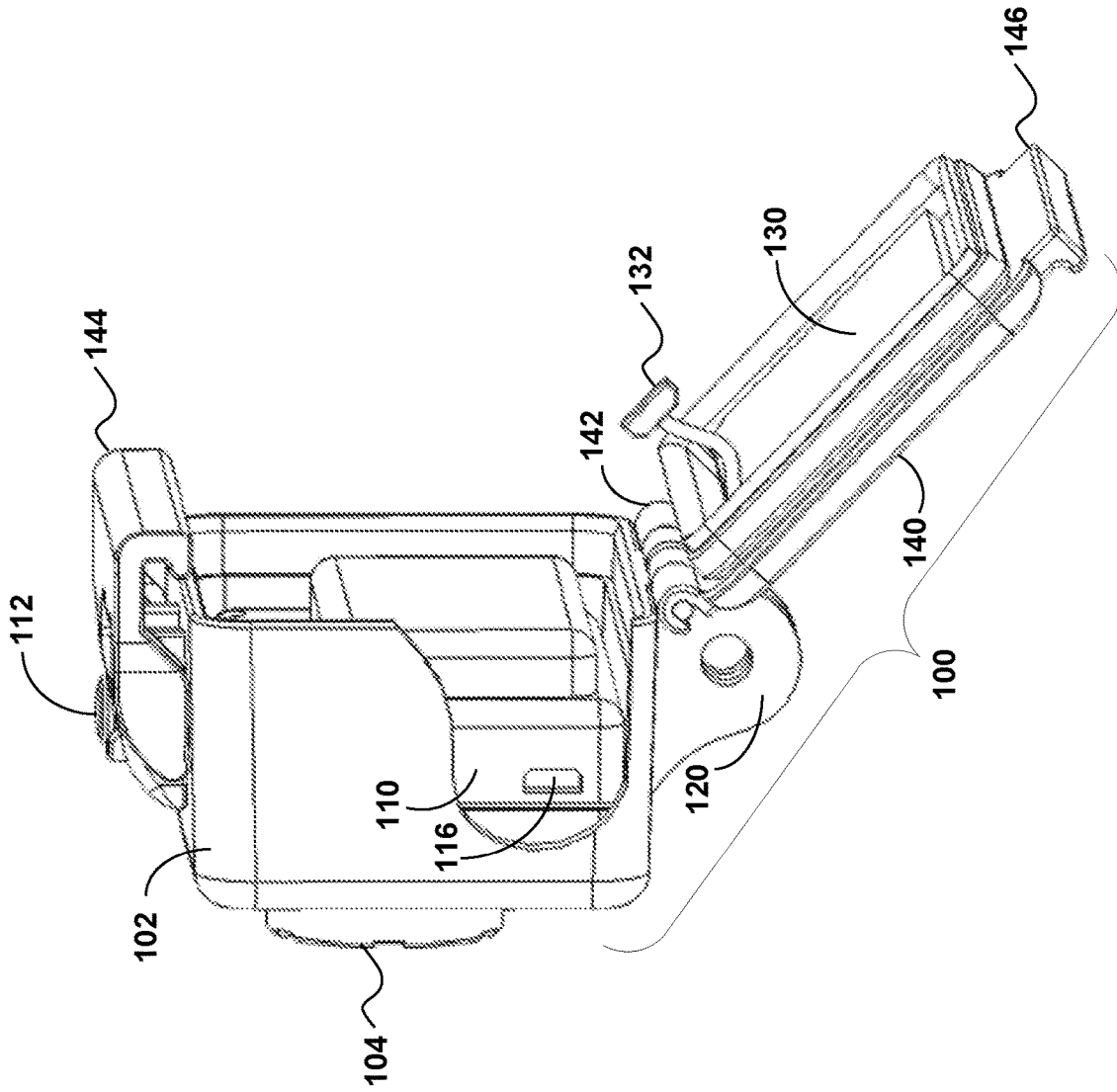

FIG. 1a

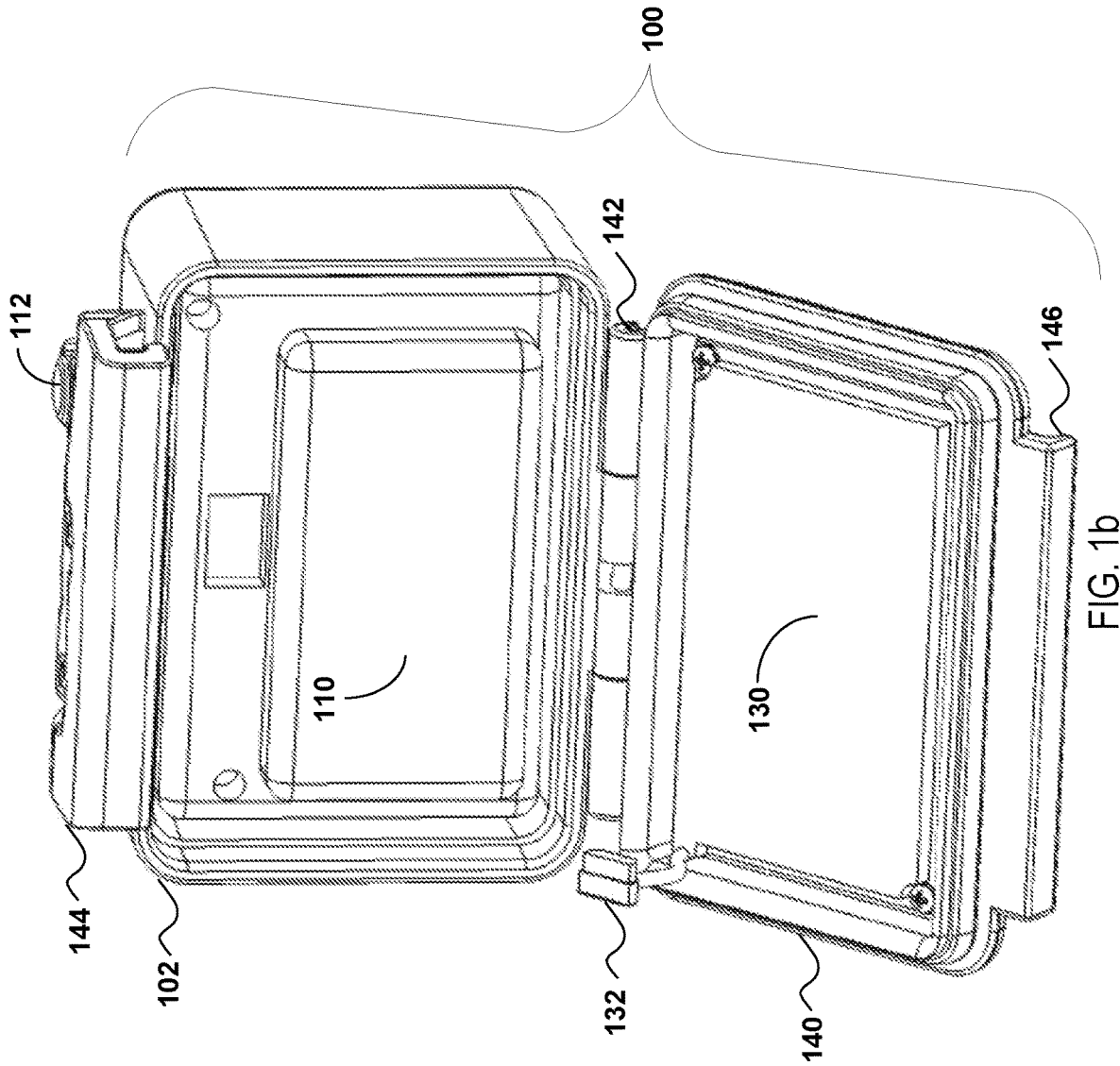

FIG. 1b

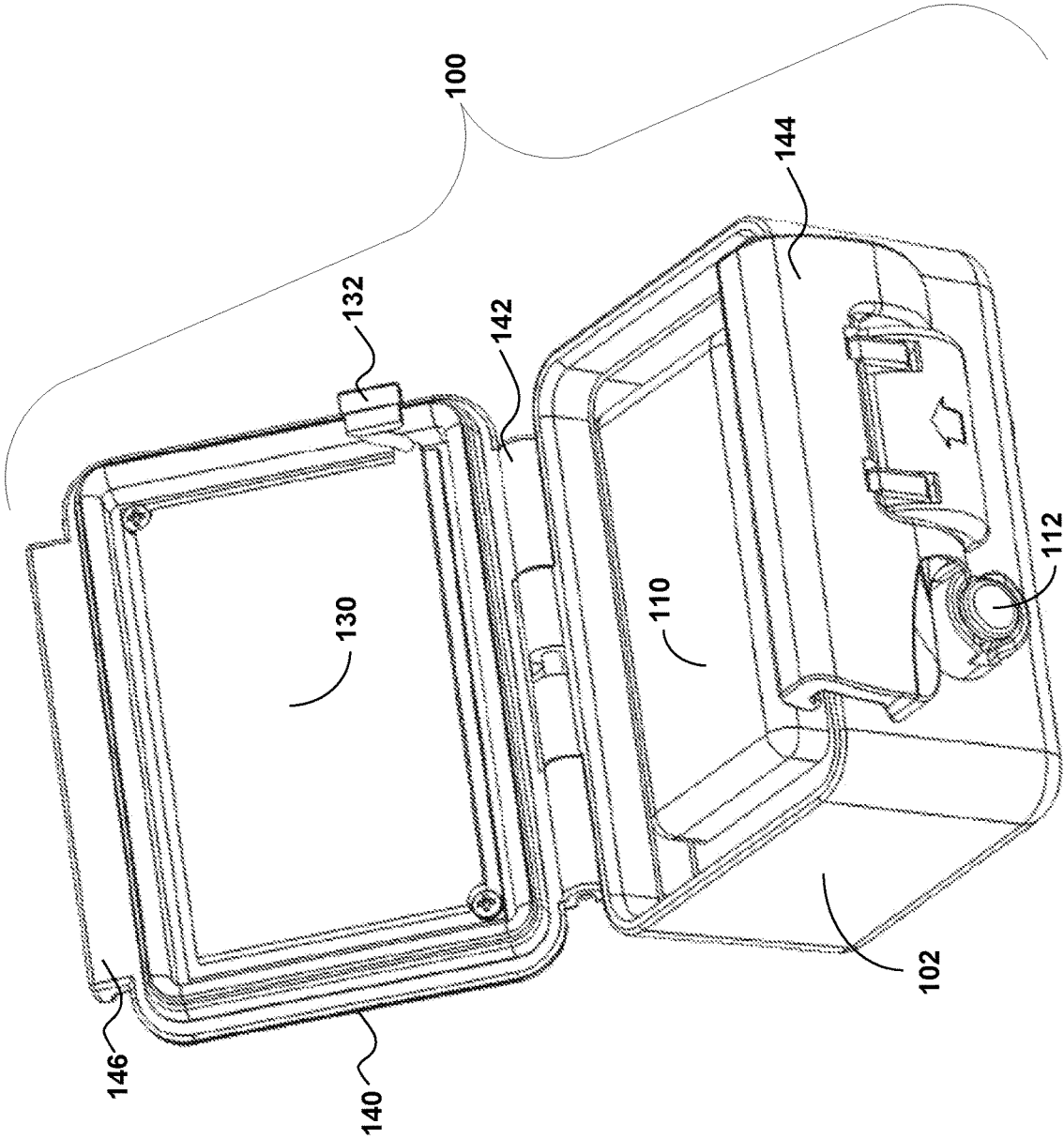

FIG. 1c

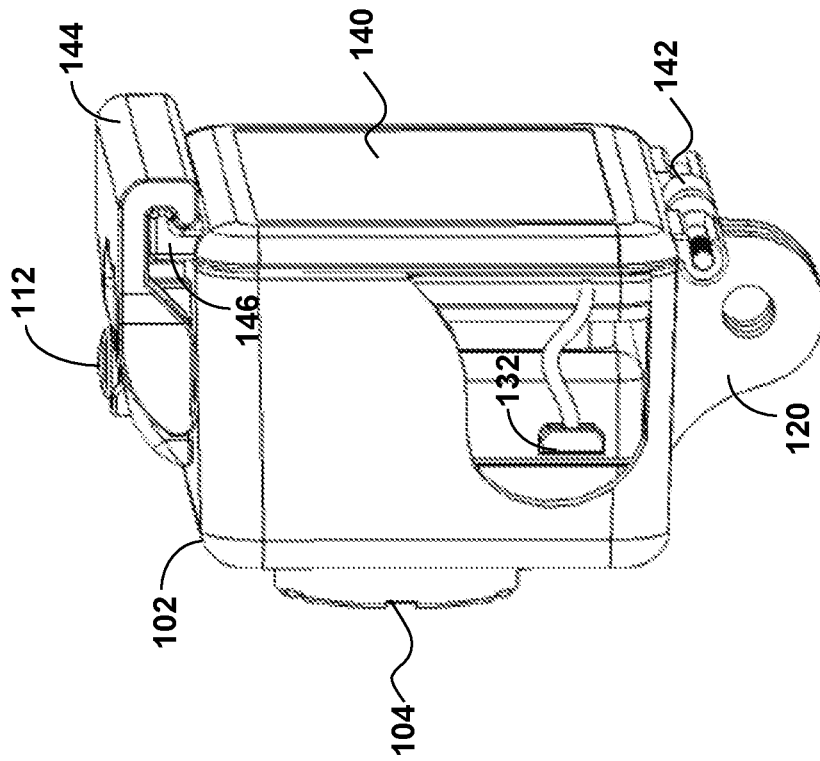

FIG. 2a

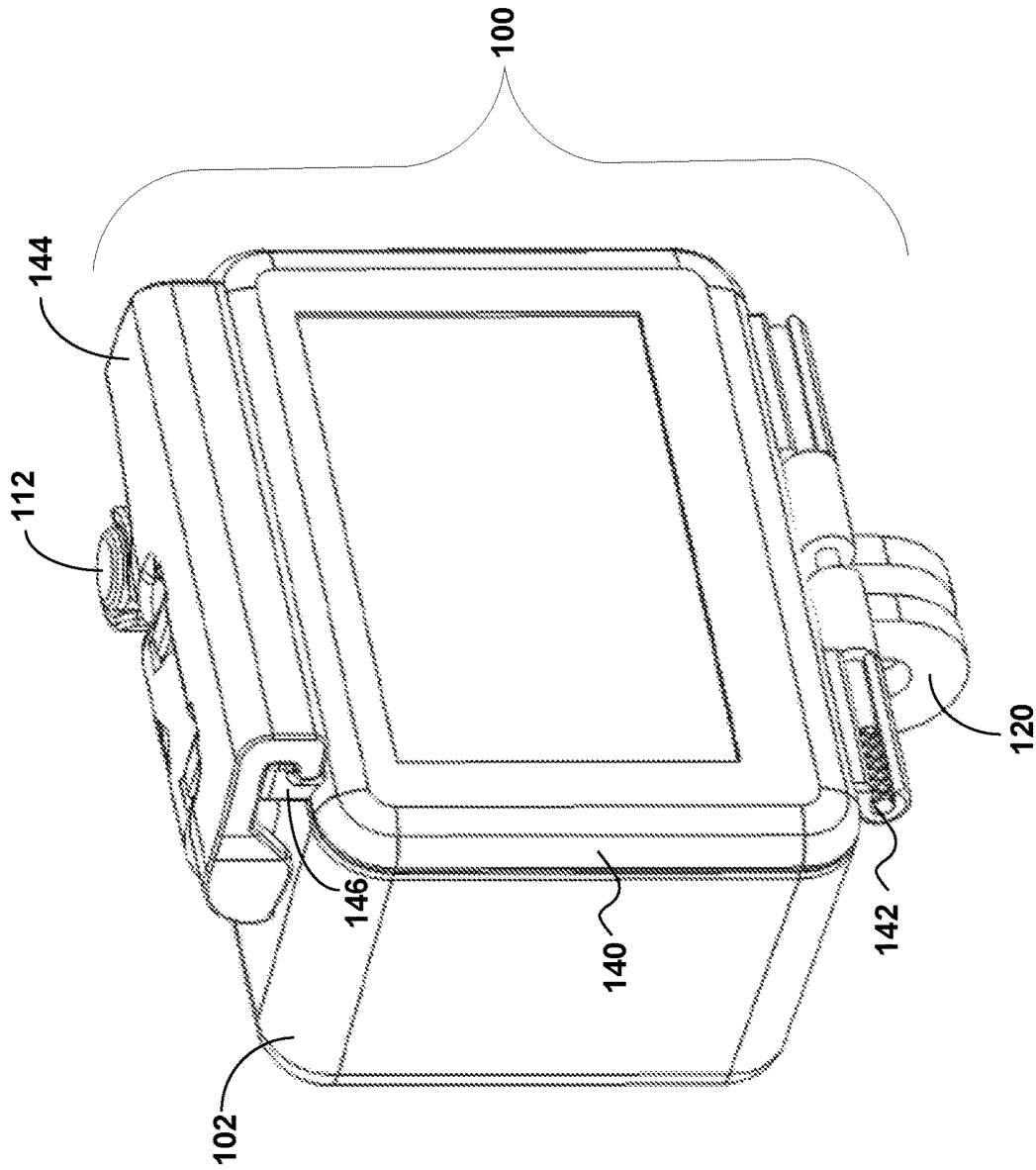

FIG. 2b



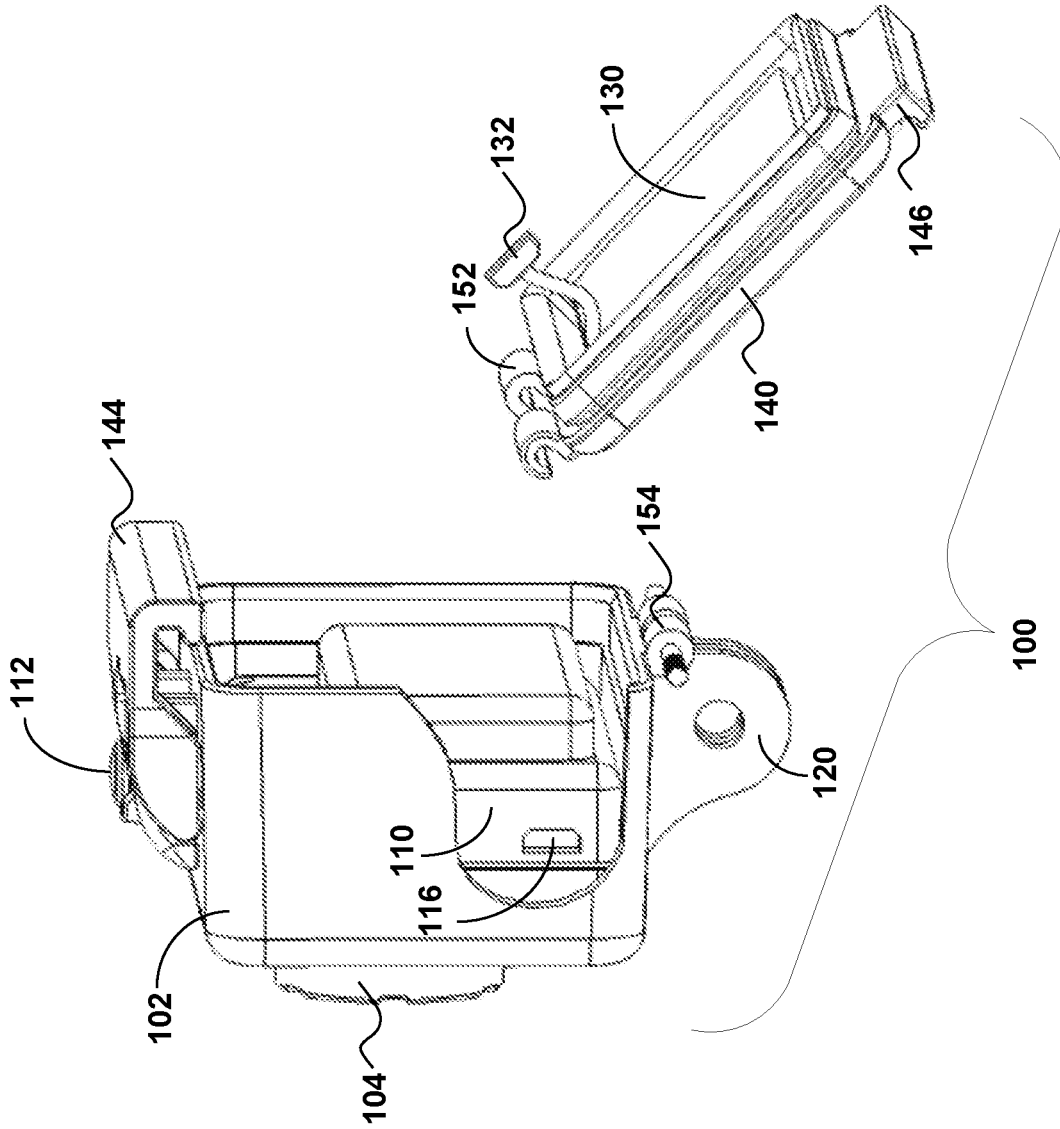

FIG. 3

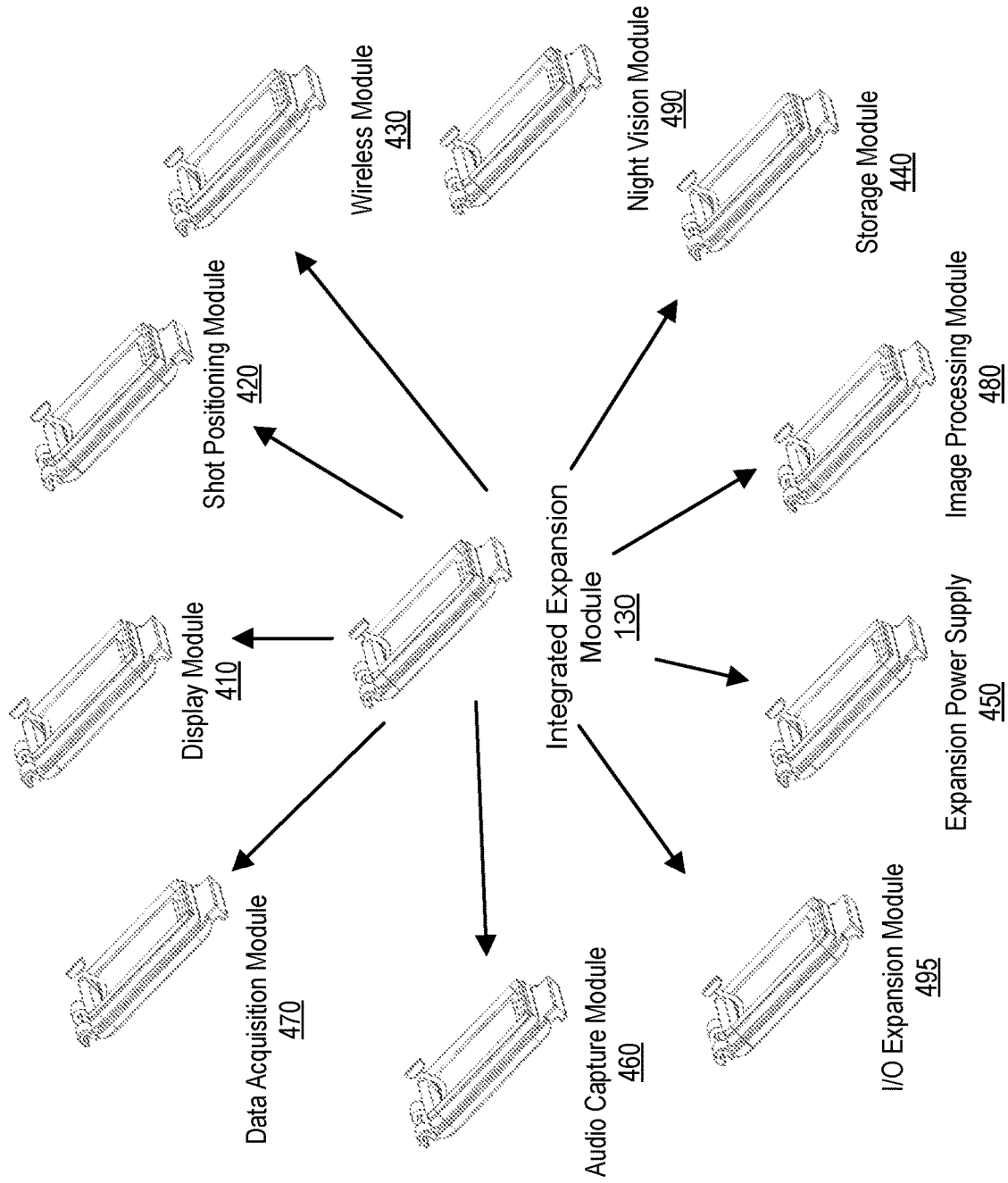

FIG. 4

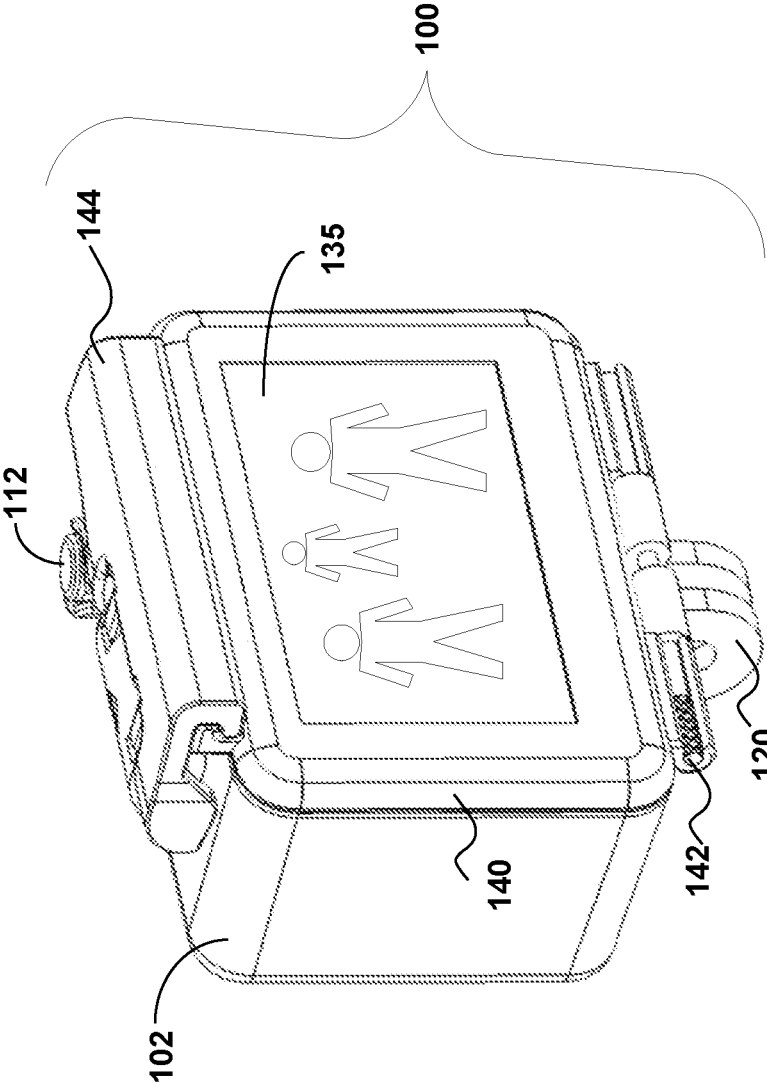

FIG. 5a

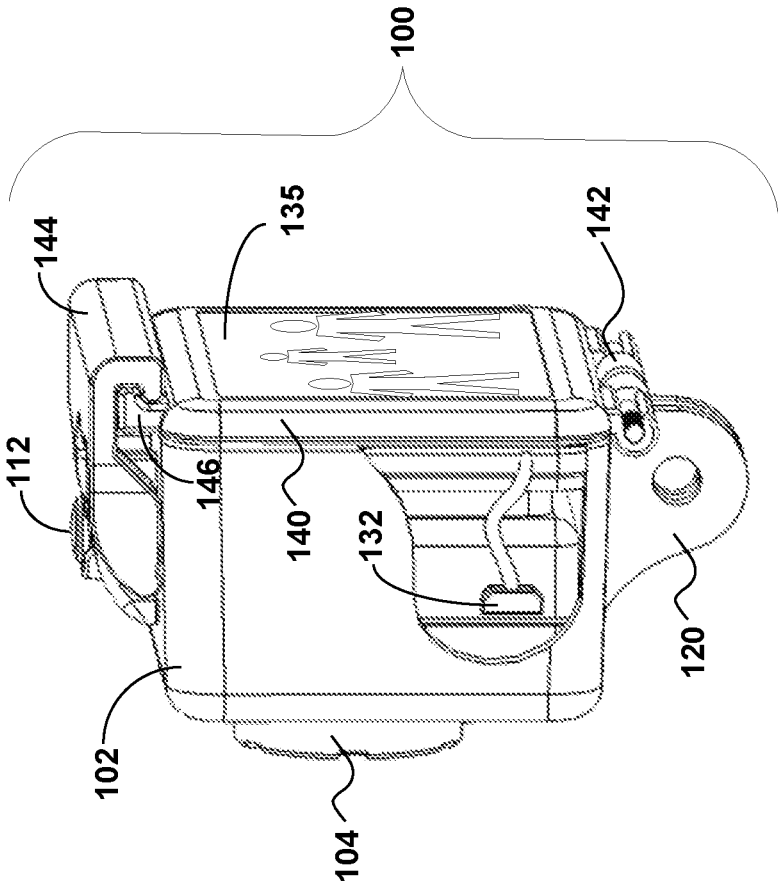

FIG. 5b

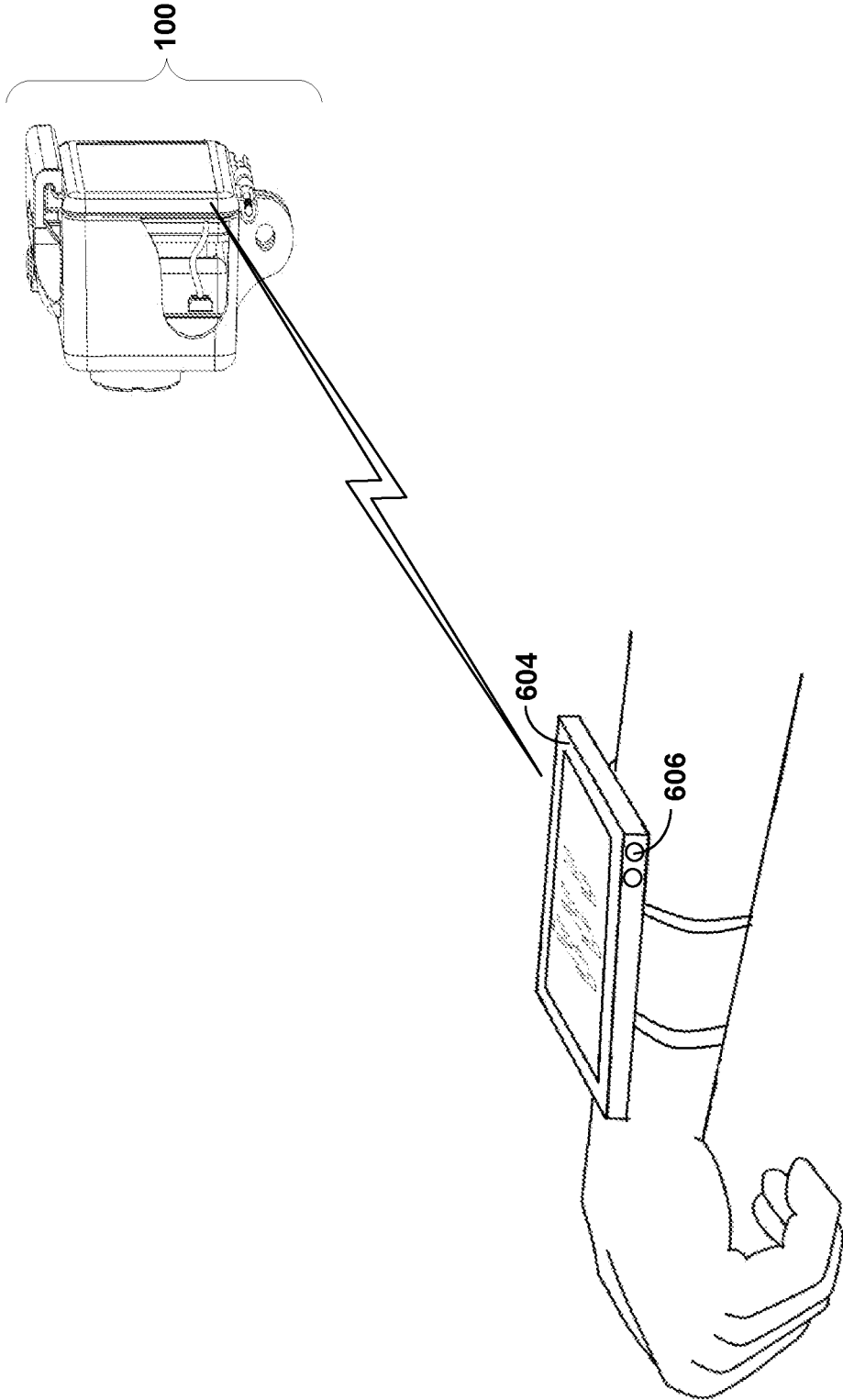

FIG. 6

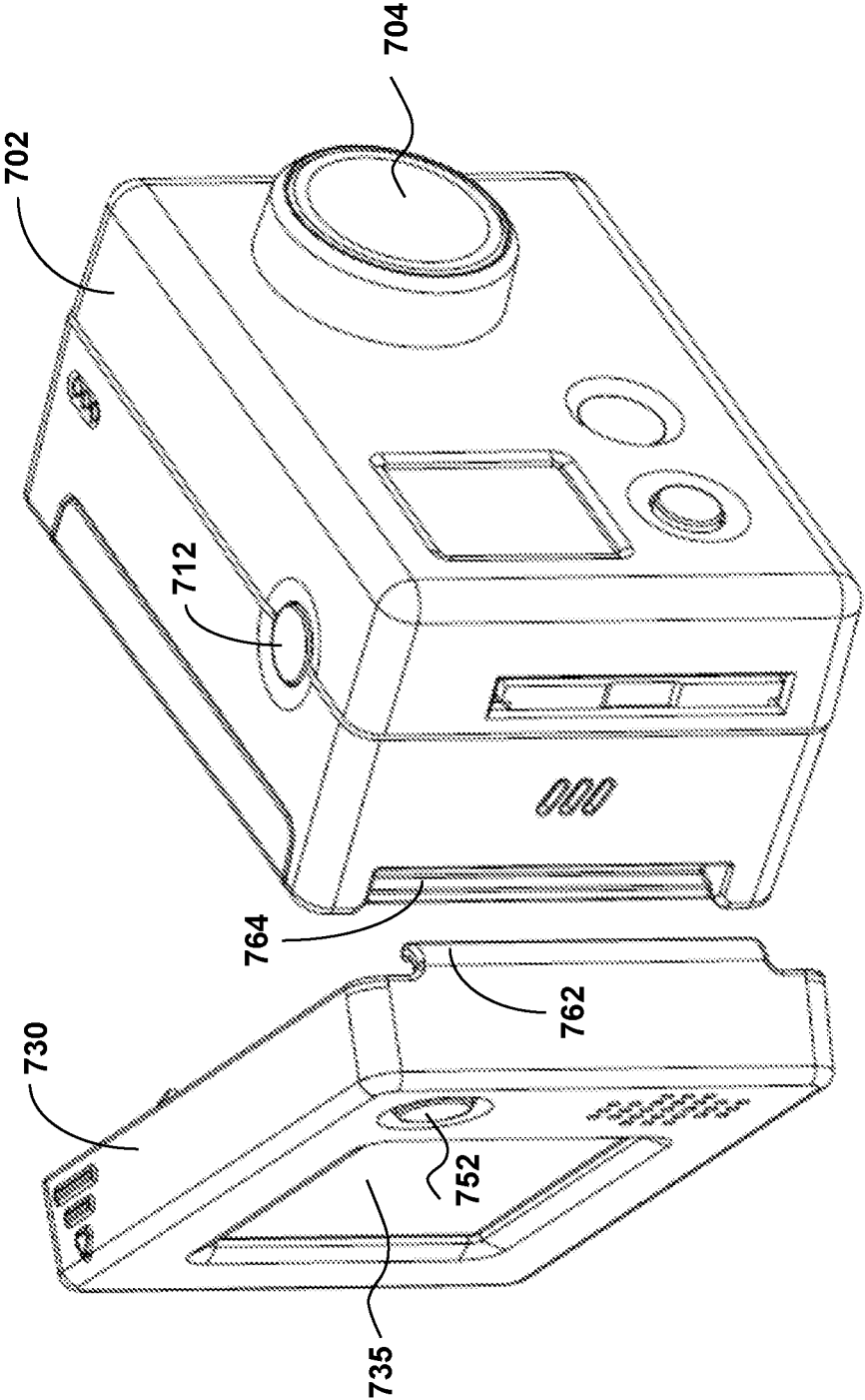

FIG. 7a

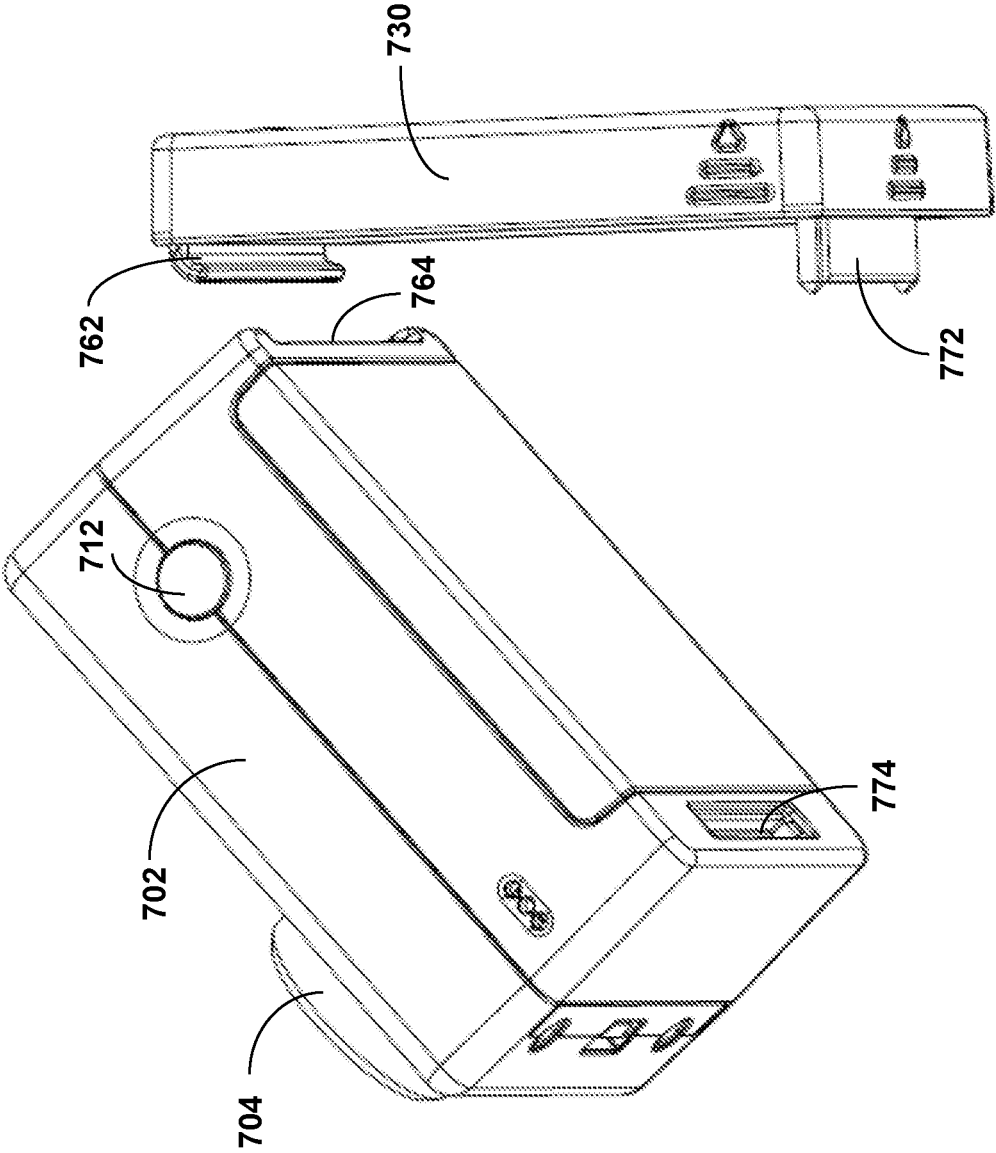

FIG. 7b

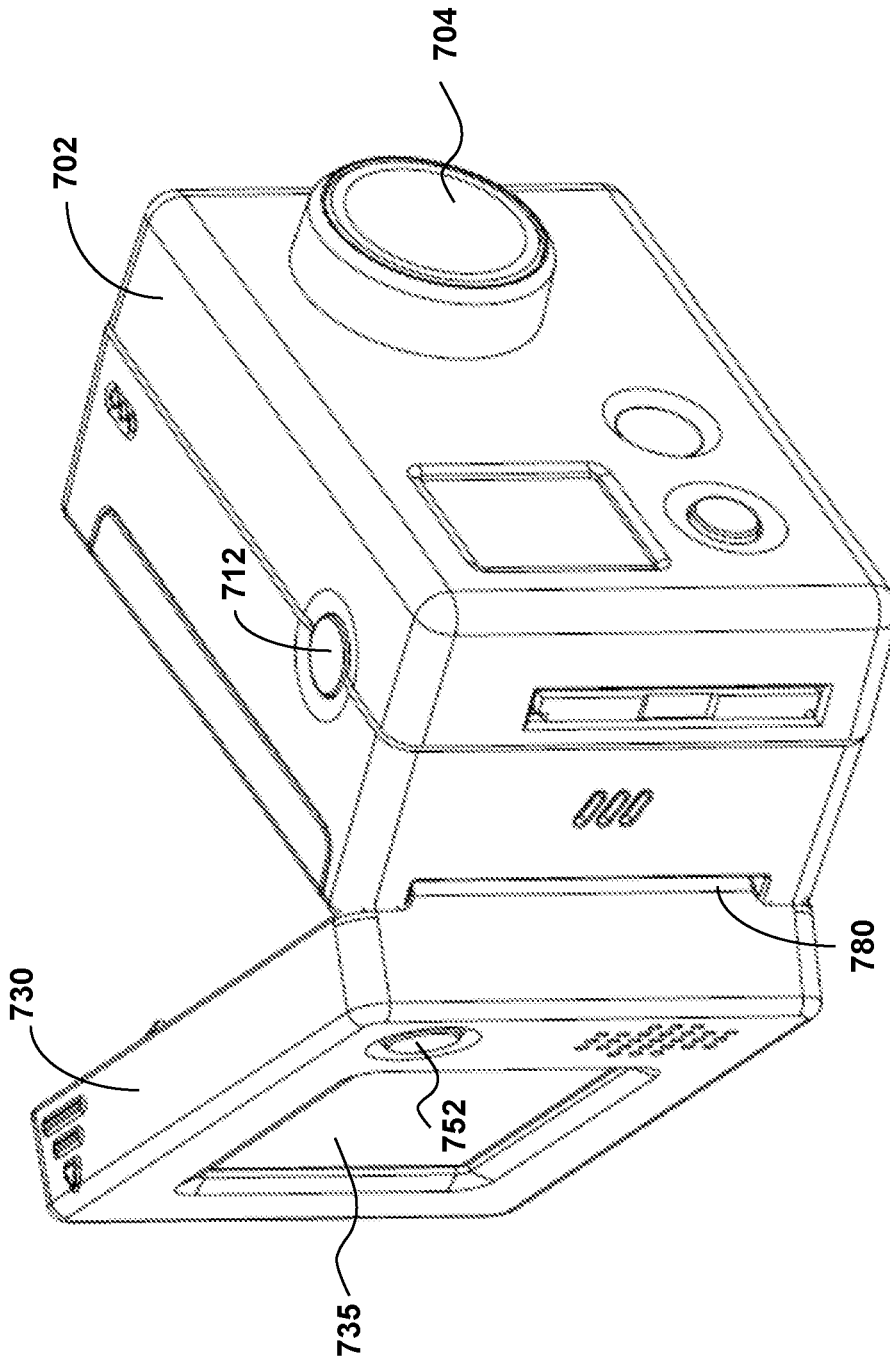

FIG. 8a



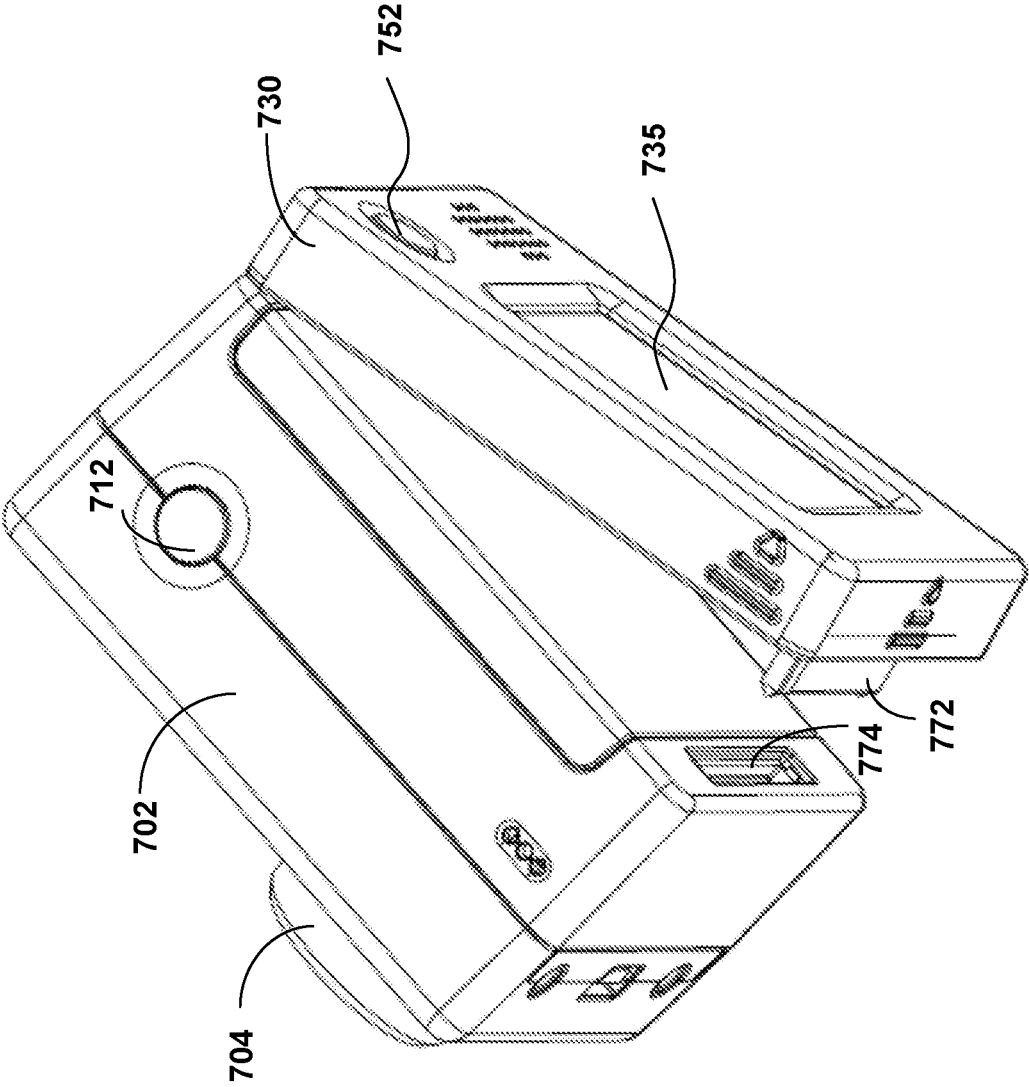

FIG. 8b

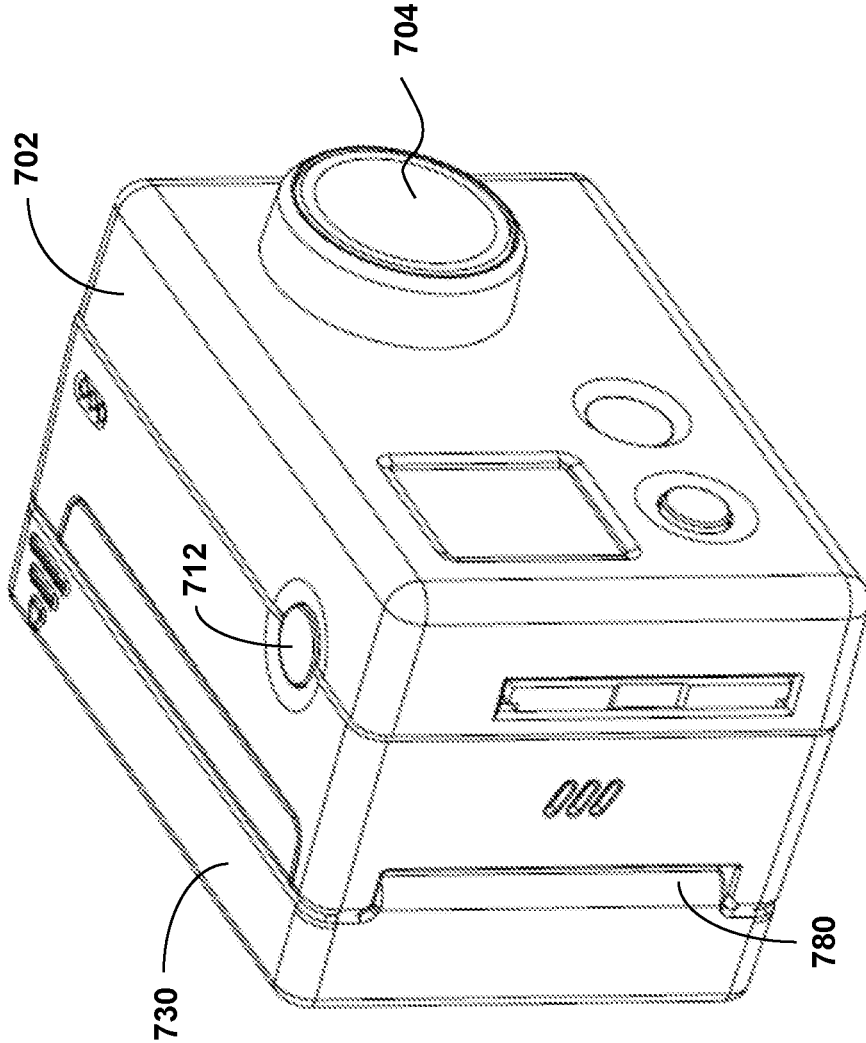

FIG. 9a

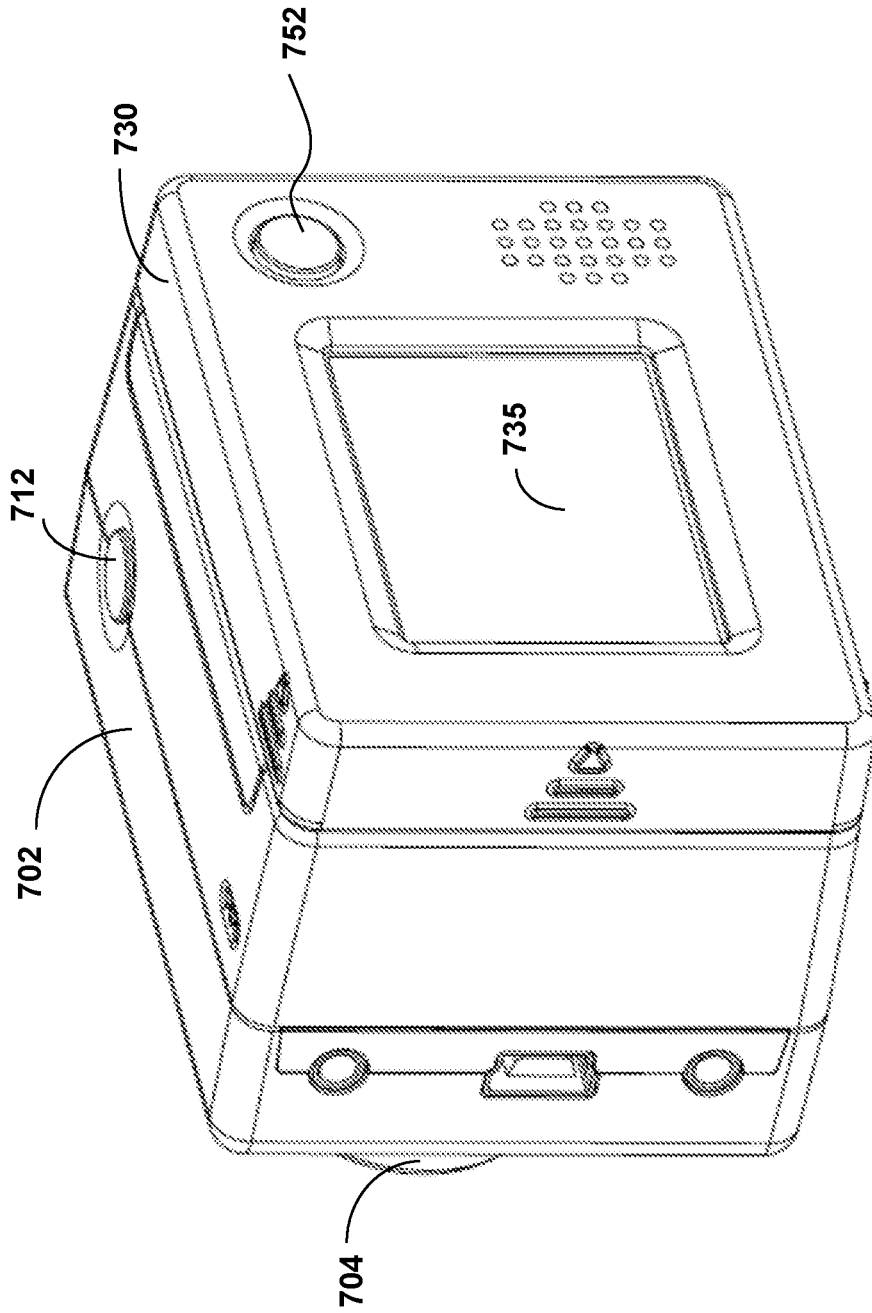

FIG. 9b

CAMERA HOUSING WITH EXPANSION  
MODULECROSS-REFERENCE TO RELATED  
APPLICATION(S)

This application is a continuation of U.S. patent application Ser. No. 16/516,846, filed on Jul. 19, 2019, which is a continuation U.S. patent application Ser. No. 16/426,065, filed on May 30, 2019, now U.S. Pat. No. 10,986,253, which is a continuation of U.S. patent application Ser. No. 15/612,917, filed on Jun. 2, 2017, now U.S. Pat. No. 10,356,291, which is a continuation of U.S. patent application Ser. No. 15/187,708, filed on Jun. 20, 2016, now U.S. Pat. No. 9,699,360, which is a continuation of U.S. patent application Ser. No. 14/132,554, filed on Dec. 18, 2013, now abandoned, which is a continuation of U.S. patent application Ser. No. 13/665,594, filed on Oct. 31, 2012, now U.S. Pat. No. 8,638,392, which is a continuation of U.S. patent application Ser. No. 13/469,926, filed May 11, 2012, now U.S. Pat. No. 8,325,270, which is a divisional of U.S. patent application Ser. No. 12/498,890, filed Jul. 7, 2009, now U.S. Pat. No. 8,199,251, which claims the benefit of U.S. Provisional Patent Application No. 61/078,756, filed on Jul. 7, 2008, the contents of which are each hereby incorporated by reference.

## BACKGROUND

## 1. Technical Field

This disclosure relates to a camera housing, and more specifically, to a camera housing with an integrated expansion module for adding expanded features to an existing camera.

## 2. Description of the Related Arts

The problem of conveniently carrying, accessing, and using a camera under various operating conditions has existed since the beginning of hand-held photography. It has become even more of a problem in recent years as a growing number of photographers attempt to take action photographs or videos while participating in fast-paced physical activities such as surfing, snorkeling, skiing, mountain biking, kayaking, rafting and so on.

In order to accommodate photography during such physical activities, camera manufacturers have produced cameras that are simple to operate, low cost, lightweight, and have compact form factors. These cameras can be secured using various mounts, harnesses, or straps to allow a user to keep one or more hands free for the physical activity. For example, camera wrist strap systems are available that provide a compact and lightweight camera together with a strap for securing the camera to a user's wrist. This configuration allows the user to easily access, operate, and then quickly secure the camera. Furthermore, the camera is small and light enough that it does not handicap the user while engaging in physical activity. Alternatively, helmet style camera systems allow a user to mount a compact and lightweight camera to a helmet. Other types of camera systems may include mounts for securing a camera to a bumper or windshield of a car to capture images or video while driving.

While such camera systems have become increasingly popular among photographers, these camera systems often lack features available in more traditional cameras. For

example, wrist-mounted or helmet mounted camera systems often lack display screens in order to keep the camera systems small, lightweight, and low cost. While features such as a display screen may be desirable in some scenarios, it may not be useful in other scenarios. For example, a display screen would not be useful when the camera is mounted to a helmet, but may be useful when the camera is strapped to a wrist. Thus, a user may be reluctant to purchase a camera that includes the feature, particularly if the feature adds to the cost, physical size, and weight of the camera. Furthermore, as camera manufacturers produce cameras with new and/or improved features, users may become frustrated by the need to periodically purchase new cameras in order to have the new features available to them. There is lacking, inter alia, a camera system that provides expanded electronic functionality to an existing camera.

## BRIEF DESCRIPTIONS OF THE DRAWINGS

The disclosed embodiments have other advantages and features which will be more readily apparent from the following detailed description of the invention and the appended claims, when taken in conjunction with the accompanying drawings, in which:

FIG. 1a illustrates a first view of an embodiment of a camera housing with a door in an open position.

FIG. 1b illustrates a second view of an embodiment of a camera housing with a door in an open position.

FIG. 1c illustrates a third view of an embodiment of a camera housing with a door in an open position.

FIG. 2a illustrates a first view of an embodiment a camera housing with a door in a closed position.

FIG. 2b illustrates a second view of an embodiment a camera housing with a door in a closed position.

FIG. 3 illustrates a view of an embodiment a camera housing with a door detached from the housing.

FIG. 4 illustrates a various embodiment of expansion modules for use with the camera system.

FIG. 5a illustrates a first view of an embodiment a camera housing with an integrated display module.

FIG. 5b illustrates a second view of an embodiment a camera housing with an integrated display module.

FIG. 6 illustrates an embodiment of camera system with a shot positioning module communicatively coupled to a remote preview screen.

FIG. 7a illustrates a first view of an embodiment a camera with an expansion module detached from the camera body.

FIG. 7b illustrates a second view of an embodiment a camera with an expansion module detached from the camera body.

FIG. 8a illustrates a first view of an embodiment a camera with an expansion module attached to the camera body in an open position.

FIG. 8b illustrates a second view of an embodiment a camera with an expansion module attached to the camera body in an open position.

FIG. 9a illustrates a first view of an embodiment a camera with an expansion module attached to the camera body in a closed position.

FIG. 9b illustrates a first view of an embodiment a camera with an expansion module attached to the camera body in a closed position.

## DETAILED DESCRIPTION

The Figures (FIGS.) and the following description relate to preferred embodiments by way of illustration only. It

should be noted that from the following discussion, alternative embodiments of the structures and methods disclosed herein will be readily recognized as viable alternatives that may be employed without departing from the principles of what is claimed.

Reference will now be made in detail to several embodiments, examples of which are illustrated in the accompanying figures. It is noted that wherever practicable similar or like reference numbers may be used in the figures and may indicate similar or like functionality. The figures depict embodiments of the disclosed system (or method) for purposes of illustration only. One skilled in the art will readily recognize from the following description that alternative embodiments of the structures and methods illustrated herein may be employed without departing from the principles described herein.

#### Configuration Overview

A camera system comprises a first portion of a camera housing structured to partially enclose a removable camera, and a second portion of a camera housing (i.e. a door) detachable from the first portion. The first portion of the camera housing includes a front face, a top face, a bottom face, a left side face, and a right side face. The door includes a back face structured to house an expansion module for interfacing with the camera to perform a camera function. An outer hinge structure located on a bottom edge of the door detachably couples to an inner hinge structure located on the bottom edge of the first portion of the housing. The outer and inner hinge structures form a hinge when coupled such that the door pivotally attaches to the first portion of the housing about the hinge. A first fastening structure is located on the top face of the first portion of the camera housing and detachably couples to a second fastening structure located on the top edge of the removable door such that the door is secured to the first portion of the camera housing in a closed position when the first fastening structure is coupled to the second fastening structure. An expansion interface cable communicatively couples to the expansion module for detachably coupling to a camera interface on the camera. The expansion interface cable facilitates communication of data between the expansion module and the camera when coupled to execute the camera function.

In a second aspect, an apparatus comprises a first housing portion having a front face with four sides structured to form a cavity to receive an electronic device, and a second housing portion detachably coupled with the first housing portion opposite the front face of the first housing portion. The first and second housing portion are collectively structured to enclose the electronic device within the cavity. The second housing portion further includes electronics including a communications interface. An interface cable has a first coupling interface for communicatively coupling the communication interface of the second housing portion and a second coupling interface for communicatively coupling the electronic device. The interface cable facilitates communication between the electronic device and the electronics within the second housing portion.

In a third aspect, a camera system comprises a camera body housing a camera. An expansion module detachably couples to the camera body for interfacing with the camera to perform a camera function. A first portion of a hinge structure positioned near an edge of the camera body detachably couples with a second portion of a hinge structure positioned near an edge of the expansion module. The first and second portions of the hinge structure form a hinge when coupled such that the expansion module is rotatable about the hinge. A first electrical connector positioned near

an edge of the camera body opposite the first portion of the hinge structure detachably couples to a second reciprocal electrical connector positioned near an edge of the expansion module opposite the second portion of the hinge structure. The first and second electrical connector electrically couple the camera and the expansion module when coupled to facilitate data communication between the camera and the expansion module for executing the camera function.

#### Camera System Configuration

A camera system includes a camera housing with an embedded expansion module for providing one or more expanded features to an existing camera. It is noted that the camera can be configured as a still picture camera or a moving picture camera (e.g., video). FIGS. 1a-c illustrate various views of the camera system in accordance with one embodiment. The camera system includes, among other components, a first housing portion **102** and a second housing portion **140** (i.e. door **140**), collectively referenced herein as housing **100**. In one embodiment, the first housing portion **102** includes a front face with four sides (i.e. a top side, bottom side, left side, and right side) structured to form a cavity that receives a camera **110** (e.g. a still camera or video camera). A second housing portion **140** (or door **140**) detachably couples with the first housing portion **102** opposite the front face of the first housing portion. The first housing portion **102** and second housing portion **140** are collectively structured to enclose the camera **110** within the cavity when the second housing portion **140** is secured to the first housing portion **102** in a closed position.

The camera housing **100** encloses and protects the camera **110**. The camera housing **100** is particularly advantageous when using the camera **110** during periods of physical activity when the camera **110** may be susceptible to damage. For example, without the housing **100**, the camera **110** may become scratched or otherwise damaged when used during physical activity. The camera **110** is removable from the housing **100** so that if the housing **100** becomes scratched or damaged, it can be easily replaced at a much lower cost than replacing the camera **110** itself.

In one embodiment, the camera **110** (and camera housing **100**) has a small form factor (e.g., a height of approximately 4 to 6 centimeters, a width of approximately 5 to 7 centimeters, and a depth of approximately 2 to 4 centimeters), and is lightweight (e.g., approximately 50 to 150 grams). The camera housing **100** can be rigid (or substantially rigid) (e.g., plastic, metal, fiberglass, etc.) or pliable (or substantially pliable) (e.g., leather, vinyl, neoprene, etc.). In one embodiment, the camera housing **100** may be appropriately configured for use in various elements. For example, the camera housing **100** may comprise a waterproof enclosure that protects the camera **110** from water when used, for example, while surfing or scuba diving.

Portions of the camera housing **100** may include exposed areas to allow a user to manipulate buttons on the camera **110** that are associated with the camera functionality. Alternatively, such areas may be covered with a pliable material to allow the user to manipulate the buttons through the camera housing **100**. For example, in one embodiment the top face of the camera housing **100** includes an outer shutter button **112** structured so that a shutter button of the camera **110** is substantially aligned with the outer shutter button when the camera **110** is secured within the camera housing **100**. The shutter button of the camera **110** is operationally coupled to the outer shutter button **112** so that pressing the outer shutter button **112** allows the user to operate the camera shutter button. In one embodiment, the front face of

the camera housing **100** includes a lens window **104** structured so that a lens of the camera **110** is substantially aligned with the lens windows **104** when the camera **110** is secured within the camera housing **100**. The lens window **104** can be adapted for use with either conventional lens of the camera **110**, a wide angle lens, or any other specialized camera lens. In one embodiment, the lens window **104** and/or lens of the camera **110** is removably attachable to the first portion of the camera housing **102** and comprises a third portion of the housing **100**. In this embodiment, the lens window **104** comprises a waterproof seal so as to maintain the waterproof aspect of the housing **100**. Alternatively, the lens window **104** is permanently fixed to the housing portion **102**.

In one embodiment, the camera housing **100** includes one or more securing structures **120** for securing the camera housing **100** to one of a variety of mounting devices. For example, in one embodiment the camera housing **100** can be secured to a wrist strap that secures the camera to a user's wrist. An example of such a camera system is described in U.S. Pat. No. 6,955,484 entitled "Harness System for Attaching Camera to User" to Nicholas Woodman, the content of which is incorporated by reference herein in its entirety. In another embodiment, the housing **100** couples to a helmet mount via the securing structure **120** for mounting the camera to a helmet. In yet another embodiment, a car mount for mounting the camera to a car couples to the securing structure **120**. In yet other embodiments, other type of mount, strap, or securing devices known to those of ordinary skill in the art couple to the securing structure **120** for securing the camera to various other apparatuses or body parts.

In one embodiment, the second housing portion **140** comprises a door **140** (shown in the open position in FIGS. 1a-c) that allows the camera **110** to be removed from the housing **100**. The door **140** of the housing **100** pivots around a hinge **142** that allows the door **140** to be opened or shut. In one embodiment, a first fastening structure **144** located on the top face of the camera housing **100** detachably couples to a second fastening structure **146** on the door **140** of the housing **100**. The fastening structures **144**, **146** secure the door **140** to the first portion **102** of the camera housing **100** in a closed position when coupled. FIGS. 2a-b illustrate embodiments of the camera housing **100** with the door **140** secured in the shut position using the fastening structures **144**, **146**. For example, in one embodiment, the fastening structure **144** comprises a hook-shaped lateral bar and the fastening structure **146** comprises an L-shaped bar. The fastening structure **144** can pivot upwards to allow the door **140** to close and can then be pressed down around the fastening structure **146** to hold the door **140** in the closed position. In different embodiments, fastening structures for securing the door **140** can include, for example, a button assembly, a buckle assembly, a clip assembly, a hook and loop assembly, a magnet assembly, a ball and catch assembly, and an adhesive assembly, or any other type of securing mechanism.

In one embodiment, the housing **100** includes a watertight seal so that the housing **100** is waterproof when the door **140** is shut. For example, in one embodiment, the door **140** includes a sealing structure positioned on edges of the door **140**. The sealing structure provides a watertight seal between the first portion of the camera housing **102** and the door **140** when the first securing structure **144** on the top face of the camera housing **100** is coupled to the second securing structure **146** on the top edge of the door **140**.

In one embodiment, the door **140** detachably couples from the first housing portion **102** at the hinge **142**. FIG. 3

illustrates an example embodiment of the camera housing **100** with the door **140** uncoupled from the first housing portion **102**. In one embodiment, an outer hinge structure **152** on the bottom edge of the door **140** detachably couples to an inner hinge structure **154** on the bottom edge of the first housing portion **102** to form the hinge **142**. For example, in one embodiment, the outer hinge structure **152** comprises one or more hook-shaped protrusions structured to securely fasten to a rod-shaped member of the inner hinge structure **154**. Other mechanisms for coupling the door **140** to the housing **100** may also be used in various alternative embodiments.

The door **140** of the camera housing **100** has an integrated expansion module **130** including a communications interface **132** for communicatively coupling to the camera **110**. The integrated expansion module **130** comprises electronics that add one or more functions to the camera **110**. The interface **132** facilitates data communication between the integrated expansion module **130** and a coupling interface **116** of the camera **110** in order to provide expanded functionality to the camera **110**.

In one embodiment, the interface **132** on the housing **100** communicatively couples to a camera interface **116** commonly available on existing camera **110**. For example, most digital cameras include an interface for transferring images and/or video captured by the camera to a PC or other storage device. Such an interface also often allows a user to supply firmware updates to the camera **110**. By applying appropriate firmware updates to the camera **110** and/or by receiving and manipulating image data retrieved from the camera **110**, the integrated expansion module **130** can provide the expanded features to the camera **110**. In addition, the interface can be used for various data transfers between the camera and the expansion module **130** to facilitate a variety of camera functions as will be described below. In one embodiment, the interfaces **132**, **116** comprises a Universal Serial Bus (USB) interface (e.g., USB A, USB B, mini USB (A or B) or micro USB (A, B or AB)). Alternatively, a different type of interface may be used such as, for example, a serial interface, a parallel interface, a FIREWIRE interface, an ETHERNET interface, and so on. In other embodiments, a wireless interface (e.g., BLUETOOTH) may be used.

In one embodiment, the integrated expansion module **130** is removable from the door **140** so that different expansion modules **130** providing different features to the camera can be swapped in and out. Alternatively, the entire door **140** is detachable from the first housing portion **102** (as illustrated in the embodiment of FIG. 3) and can be swapped with other doors **140** having different expansion modules **130** providing different features. Examples of different expansion modules for use with the camera system **100** are described in further detail below.

FIG. 4 illustrated a variety of different types of integrated expansion module **130** providing different functions to the camera **110** depending on the user's needs. According to various embodiments, the integrated expansion module **130** can comprise one or more of a display module **410**, a shot positioning module **420**, a wireless module **430**, a storage module **440**, an expansion power supply **450**, an audio capture module **460**, a data acquisition module **470**, an image processing module **480**, a night vision module **490**, and an expansion input/output (I/O) module **495**. An expansion module **130** may also comprise a module that includes a combination of functions (e.g., a storage module **440** and an audio capture module **460** enclosed within a single housing portion **140**). In a typical use, a user may have

several different types of expansion modules **410-495** (collectively referred to as expansion module **130** for ease of discussion) available. The user can then swap in and out the different expansion modules **130** depending on the desired functions. Embodiments of the camera system **100** using the different types of expansion modules **130** (e.g., **410-495**) are described in more detail below.

#### Camera Housing with Display Module

In one embodiment, the integrated expansion module **130** of the camera housing **100** comprises an integrated display module **410** to add display functions to a camera **110** that does not have a built in display. An example embodiment of a camera housing **100** with an integrated expansion module **130** having a display module **410** illustrated in FIGS. **5a-5b**. In this embodiment, the housing **100** includes a display screen **135** (e.g., a Liquid Crystal Display (LCD)) externally viewable from the back of the housing **100**. The display module **410** includes display control logic for adding display functions to the existing camera **110** without a built in display. For example, the display module **410** may digitally display the image currently in view of the camera lens on the display screen **135**. This provides the user with a preview image before taking a picture or while recording video and allows the user to operate the camera **110** without having to peer directly through a viewfinder. Additionally, the display module **410** may allow the user to view previously captured and stored images or video stored on the exterior display screen **135**.

#### Camera Housing with Shot Positioning System

In another embodiment, the integrated expansion module **130** of the camera housing **100** comprises a “shot” (e.g., photo or video shot) positioning module **420** configured to assist the user in aligning the camera when the viewfinder or external display is outside the user’s view (e.g., when the housing **100** is mounted to a helmet). One example embodiment of a system using the shot positioning module **420** is illustrated in FIG. **6**. In this embodiment, the shot positioning module **420** includes a communication interface that transmits image information from the camera **110** to a remote preview screen **604** that can be attached to a user’s arm or wrist. In one embodiment, the shot positioning module **420** includes a wireless interface (e.g., Bluetooth, Radio Frequency (RF), infrared (IR), **801.11a/b/g/n** or other wireless protocol) that communicates with the remote preview screen **504**.

The wireless interface transmits the image currently in view of the camera lens to the remote preview screen **604** for display. In one embodiment, the shot positioning module **420** communicates with the remote preview screen **604** via a two-way interface. In this embodiment, the remote preview screen **604** may have control buttons **606** that allow the user to control various camera operations from the remote preview screen **604**. Alternatively, the communication interface may be a one-way communication such that the remote preview screen **604** only receives and displays image information from the camera **110** but does not send any information or controls to the camera **110**. In this embodiment, the user still controls the camera **110** via the built-in camera buttons (e.g., the shutter button **114**).

#### Camera Housing with Wireless Module

In another embodiment, the integrated expansion module **130** comprises an integrated wireless module **430** that adds wireless connectivity to a camera **110** lacking wireless features. The wireless module **430** may include, for example a Bluetooth module, a Radio Frequency (RF) transceiver, an infrared (IR) transceiver, an **802.11a/b/g/n** transceiver, or any other wireless device. For example, the wireless module

**430** could be used to allow the user to wirelessly download stored images and/or video from the camera **110** to a personal computer (PC), e.g., a server computer, a desktop computer, a laptop, a netbook, or a smartphone. Alternatively, images and/or video can be captured and wirelessly downloaded in real-time from the camera **110**. The wireless module **430** may also allow a user to wirelessly control operation of the camera **110**. For example, if the camera **110** is mounted on a bumper of a car, the user could remotely control the camera **110** from inside the car via a remote control wirelessly coupled to the wireless module **430**.

#### Camera Housing with Storage Module

In another embodiment, the integrated expansion module **130** comprises an integrated storage module **440**. The storage module **440** provides additional storage space for storing captured images and/or movies. The storage module **440** may include any type of volatile or non-volatile memory including random access memories (RAMs), FLASH memory, magnetic or optical cards, or any type of media suitable for storing electronic data. Images or video captured by the camera **110** are transmitted to the integrated storage module **440** via the communication interface **132**.

#### Camera Housing with Expansion Power Supply

In another embodiment, the expansion module **130** comprises an expansion power supply **450** for providing power to the camera **110**. For example, the expansion power supply may include an expansion battery that supplements an internal battery of the camera **110** and provides additional battery life to the camera **110**. In another embodiment, the expansion power supply **450** can include a solar charger that captures solar energy to recharge a battery. The expansion power supply may also be configured so that rechargeable batteries providing power to the camera can be recharged through an expansion power supply **450** that comprises an inductive charging element or a capacitive charging element. In the case of inductive charging, the communication interface **132** may couple with an inductive coil plate that inductively couples with the inductive charger (which has its own coil). In the case of conductive charging, the communications interface **132** is configured to receive a discharge from a capacitive power source that is the expansion power supply **450**. Alternatively, the expansion power supply **450** couples directly to battery terminals of the camera **110** rather than coupling via the interface **132**.

#### Camera Housing with Audio Capture Module

In yet another embodiment, the integrated expansion module **130** can include an audio capture module **460** (e.g., a microphone or an interface for an external microphone) to capture and/or store audio data. In this embodiment, the audio capture module **460** captures audio concurrently with the camera **110** capturing video. Alternatively, the audio capture module **460** can capture audio alone without any corresponding video.

#### Camera Housing with Data Acquisition module

In yet another embodiment, the integrated expansion module **130** includes a data acquisition module **470** that acquires various data to store in association with images or video captured by the camera. For example, in one embodiment, the data acquisition module **130** capture Global Positioning System (GPS) data that provide positioning information. Such positioning information may be stored together with images and/or video so that the user can record where the images and/or video were taken. For example, in one embodiment, the GPS module automatically inserts a position stamp on a captured image or video indicating the location that the image or video was captured. Similarly, the data acquisition module **470** can include, for example, an

accelerometer, altimeter, clock, thermometer, humidity sensor, barometer, heart rate meter, light sensor, and so on. Any of the captured information can be stored with photographs or video or automatically inserted into the images or video to provide the user with information relating to the captured scene.

#### Camera Housing with Image Processing Module

In yet another embodiment, the integrated expansion module **130** includes an image processing module **480**. The image processing module **480** receives images and/or video from the camera and performs various image processing functions such as, for example, modifying brightness, contrast, saturation, hue, resolution, aspect ratio, and so on. In one embodiment, the image processing module converts images or videos captured in a 4:3 aspect ratio to an image or video 16:9 aspect ratio or vice versa. In one embodiment, the image processing module **480** includes a digital signal processor (DSP) chipset that is configured to “stretch” pixels gradually starting at a center of a captured image (stretch=0) working outward towards each edge and/or corner of the image (stretch=maximum\_set). The number of directions for the stretch can be any integer. However, in one embodiment the number of directions of stretch are a factor of 2 for a 4 sided picture radiating in opposite directions from the center of an image. For example, the processing module **480** can stretch an image in 2 directions (any two opposite edges), 4 directions (each edge), 8 directions (each edge and each corner) and the like.

In an alternate embodiment, a wide angle lens couples with the camera **110** and captures images in 16:9 format and the image processing module **480** converts it into a 4:3 format. In one embodiment the DSP is configured so that the captured 16:9 image is cropped into a 4:3 size. Alternately, the DSP is configured so that the pixels are “squeezed” with the maximum squeeze at the edges and corners (squeeze=maximum\_set) and the minimum or no squeeze closer to the center of the image (squeeze=0).

#### Camera Housing with Night Vision Module

In yet another embodiment, the integrated expansion module **130** can include a night vision module **490** to add night vision capabilities to an existing camera **110**. The night vision module **490** may utilize any conventional night vision technology such as, for example, infrared night vision, thermal night vision, and so on. In one embodiment, the night vision module **490** operates with a specialized lens designed for night vision image and/or video capture.

#### Camera Housing with Expansion I/O Module

In yet another embodiment, the integrated expansion module **130** can include an expansion input/output (I/O) module **495** that allows other external devices to communicate with the camera **110** through a variety of possible interfaces. For example, the expansion I/O module **495** may adapt the standard communication interface of the camera **110** to be able to communicate with external devices via interfaces such as, for example, a USB interface, a serial interface, a parallel interface, a FIREWIRE interface, an ETHERNET interface, a wireless interface, and so on. The external device can then perform functions such as controlling operation of the camera **110** or acquiring and/or processing data from the camera **110**.

#### Additional Embodiments

In other additional embodiments, the door **140** of the camera housing **100** can have various shapes and sizes to accommodate cameras **110** of different thicknesses and shapes. Thus, a user may have a set of removable doors **140** that can be swapped in and out depending on the size and shape of the camera **110** being used. In some embodiments,

the camera **110** may also accommodate various expansion modules that attach directly to the body of the camera, an example of which is described below with reference to FIGS. **8a-b** and **9a-b**. Thus, various additional embodiments of the housing door **140** can also be sized and shaped to accommodate expandable cameras having expansion modules of different sizes and shapes. In one embodiment, a door **140** may have various cut-outs, vents, or other pass-throughs to provide improved cooling to the camera **110** and/or better audio capture if the camera **110** is equipped with a microphone. Thus, a user may swap between a vented camera door or a solid-bodied waterproof back door depending on the circumstances and the type of camera **110** being used.

The described housing **100** may also be adapted for a wider range of devices of varying shapes, sizes and dimensions besides cameras. For example, the housing **100** with expansion module **130** may be used to add expanded features to electronic devices such as cell phones, music players, PDAs, GPS units, or other portable electronic devices.

#### Expansion Module for Camera Body

In alternative embodiments, an expansion module **730** can couple directly to a camera body **702** as illustrated in FIGS. **7-9**. The expansion module **730** can be functionally similar to the expansion module **130** described above. Although the illustrations show an expansion module **730** with a built-in display, the embodiments are not limited to display modules. Rather, the expansion module **730** can be functionally similar to any of the various expansion modules described above (i.e. display module **410**, shot positioning module **420**, wireless module **430**, storage module **440**, expansion power supply **450**, microphone **460**, data acquisition module **470**, image processing module **480**, night vision module **490**, and expansion I/O module **495**). In one embodiment, a user may swap in and out various types of the expansion module **730** depending on the functionality the user wishes to add to the camera.

FIGS. **7a-b** illustrate various views of an expansion module **730** detached from a camera body **702** according to this embodiment. The camera body **702** includes a shutter button **712**, a lens window **704**, a first portion of a hinge structure (e.g., hinge groove **764**) positioned near an edge of the camera body **702**, and a first portion of an electrical connector (e.g., electrical groove **774**) positioned near an edge of the camera body **702** opposite the hinge structure **764**. In order to simplify the description, other conventional features of the camera body **702** are omitted from the Figs and the description that follows. The expansion module **730** includes a preview screen **735**, an expansion function button **752**, a second portion of a hinge structure (e.g., hinge connector **762**) positioned near an edge of the expansion module **730**, and a second portion of an electrical connector (e.g., electrical connector **772**) that is reciprocal to the first portion of the electrical connector **774** on the camera body **702**, and is positioned near an edge of the expansion module **730** opposite the hinge connector **762**.

FIGS. **8a-b** illustrate various views of the expansion module **730** partially coupled to the camera body **702** (i.e. in an open position). As illustrated, the hinge connector **762** of the expansion module **730** detachably couples to the hinge groove **764** of the camera body **702** to form a hinge **780**. Once in place, the expansion module **730** is rotatable about the hinge **780** formed by the hinge connector **762** and hinge groove **764**. In one embodiment, the hinge connector **762** and hinge groove **764** snap together so as to form a secure coupling between the camera body **702** and expansion module **730**. The electrical connector **772** is adapted to fit



snugly into the electrical groove 774 on the camera body 702. When connected, the electrical connector 772 and electrical connection groove 774 serve to both secure the expansion module 730 to the camera body and provide an electrical connection between the expansion module 730 and the camera body 702.

FIGS. 9a-b illustrate various views of the expansion module 730 fully coupled to the camera body 702 (i.e. in a closed position). In this embodiment, the electrical connector 772 is securely connected to the electrical connection groove 774 to secure the expansion module 730 to the camera body 702 and to provide an electrical connection between the expansion module 730 and the camera body 702. The electrical connection allows for data flow between the camera body 702 and the expansion module 730 such as, for example, providing image data to the preview screen 735 of the expansion module 730. In various alternative embodiments, the electrical connection may provide for different types of data flow depending on the specific function of the expansion module 730.

It is note that some embodiments described herein have used the expression “coupled” and “connected” along with their derivatives. It should be understood that these terms are not intended as synonyms for each other. For example, some embodiments may be described using the term “connected” to indicate that two or more elements are in direct physical or electrical contact with each other. In another example, some embodiments may be described using the term “coupled” to indicate that two or more elements are in direct physical or electrical contact. The term “coupled,” however, may also mean that two or more elements are not in direct contact with each other, but yet still co-operate or interact with each other. The embodiments are not limited in this context.

Likewise, as used herein, the terms “comprises,” “comprising,” “includes,” “including,” “has,” “having” or any other variation thereof, are intended to cover a non-exclusive inclusion. For example, a process, method, article, or apparatus that comprises a list of elements is not necessarily limited to only those elements but may include other elements not expressly listed or inherent to such process, method, article, or apparatus. Further, unless expressly stated to the contrary, “or” refers to an inclusive or and not to an exclusive or. For example, a condition A or B is satisfied by any one of the following: A is true (or present) and B is false (or not present), A is false (or not present) and B is true (or present), and both A and B are true (or present).

In addition, use of the “a” or “an” are employed to describe elements and components of the embodiments herein. This is done merely for convenience and to give a general sense of the invention. This description should be read to include one or at least one and the singular also includes the plural unless it is obvious that it is meant otherwise.

Finally, as used herein any reference to “one embodiment” or “an embodiment” means that a particular element, feature, structure, or characteristic described in connection with the embodiment is included in at least one embodiment. The appearances of the phrase “in one embodiment” in various places in the specification are not necessarily all referring to the same embodiment.

Upon reading this disclosure, those of skill in the art will appreciate still additional alternative structural and functional designs for a camera expansion module as disclosed from the principles herein. Thus, while particular embodiments and applications have been illustrated and described, it is to be understood that the disclosed embodiments are not

limited to the precise construction and components disclosed herein. Various modifications, changes and variations, which will be apparent to those skilled in the art, may be made in the arrangement, operation and details of the method and apparatus disclosed herein without departing from the spirit and scope defined in the appended claims.

What is claimed is:

1. A camera expansion device, comprising:
  - a housing;
  - a power supply within the housing, the power supply configured to power an imaging device;
  - a securing structure extending from the housing for securing the housing to a separate mounting device; and
  - an interface configured to facilitate power transfer between the camera expansion device and the imaging device;
    - wherein the securing structure includes adjacent protrusions, each of which has an aperture, and
    - wherein the adjacent protrusions extend perpendicularly away from the housing, and
    - wherein the apertures in the adjacent protrusions are aligned.
2. The camera expansion device of claim 1, wherein the interface configured to facilitate power transfer is replaceable with an interface configured to facilitate data communications between the camera expansion device and the imaging device when the interface is removably coupled to a corresponding interface of the imaging device.
3. The camera expansion device of claim 1, wherein the interface is an electrical connector.
4. The camera expansion device of claim 1, wherein the interface is replaceable to provide one of a Universal Serial Bus (USB) interface, a mini USB, a micro USB, a serial interface, a parallel interface, a Firewire interface, an Ethernet interface, a wireless interface, a cable, or a Bluetooth interface.
5. The camera expansion device of claim 1, wherein the power supply includes at least one of a battery, a solar charger, an inductive charging element, or a capacitive charging element.
6. The camera expansion device of claim 1, wherein the camera expansion device is replaceable with at least one of a display module, a shot positioning module, a wireless module, a storage module, an audio capture module, a data acquisition module, an image processing module, a night vision module, an expansion input/output (I/O) module, or any combination thereof.
7. The camera expansion device of claim 6, wherein the camera expansion device includes the data acquisition module, and wherein the data acquisition module includes at least one of an accelerometer, an altimeter, a clock, a thermometer, a humidity sensor, a barometers, a heart rate meter, a light sensor, or any combination thereof.
8. The camera expansion device of claim 7, wherein the data acquisition module captures information associated with captured media and stores the information within the captured media.
9. The camera expansion device of claim 8, wherein the data acquisition module captures GPS data to automatically insert a position stamp on the captured media, the position stamp indicating a location associated with the captured media.
10. The camera expansion device of claim 1, further comprising:
  - an expansion function button located on the camera expansion device.

13

- 11. A camera system, comprising:
  - an imaging device configured to capture images and video; and
  - an expansion module configured to removably couple to the imaging device, the expansion module comprising:
    - a housing;
    - a cavity within the housing, the cavity configured to receive a portion of the imaging device;
    - an audio capture module disposed on the housing, the audio capture module configured to capture audio;
    - a communication interface within the cavity that is configured to extend outward from the cavity to facilitate audio transfer between the expansion module and the imaging device;
    - a hinge that rotatably couples the expansion module to the imaging device so that the expansion module is movable relative to the imaging device and the communication interface moves with the expansion module and
    - a storage module enclosed with the audio capture module within a single housing of the expansion module.
- 12. The camera system of claim 11, wherein the audio capture module captures or stores audio concurrently with the imaging device capturing video.
- 13. The camera system of claim 11, wherein the storage module is configured to provide additional storage space for storing captured images, video, and audio.
- 14. The camera system of claim 11, further comprising:
  - a securing structure configured to secure the imaging device and the expansion module to a separate mounting device.
- 15. A camera system, comprising:
  - an imaging device including a lens, an image sensor that detects light passing through the lens, a processor that receives image information from the image sensor, and a hinge connector;
  - a camera expansion device coupled to the hinge connector of the imaging device to enable additional camera functionality, wherein the camera expansion device is rotatable about the hinge connector, the camera expansion device comprising:

14

- a housing; and
- a night vision module that is coupled to the housing via a communication interface of the imaging device to add night vision capabilities to the imaging device, wherein the communication interface maintains a connection between the camera expansion device and the imaging device as the camera expansion device moves about the hinge connector;
- wherein the communication interface includes at least one of a Universal Serial Bus (USB) interface, a mini USB, a micro USB, a serial interface, a parallel interface, a Firewire interface, an Ethernet interface, a wireless interface, or a Bluetooth interface.
- 16. The camera system of claim 11, further comprising:
  - a night vision module is that is removable and an expansion input/output module that is connectable and includes a communication interface, wherein the communication interface includes at least one of a Universal Serial Bus (USB) interface, a mini USB, a micro USB, a serial interface, a parallel interface, a Firewire interface, an Ethernet interface, a wireless interface, or a Bluetooth interface.
- 17. The camera system of claim 15, wherein the night vision module includes at least one of infrared technology or thermal technology.
- 18. The camera system of claim 15, wherein the night vision module includes infrared night vision or thermal night vision.
- 19. The camera system of claim 15, wherein the communication interface extends out of a cavity of the imaging device to connect the imaging device with the night vision module.
- 20. The camera system of claim 15, further comprising:
  - a door on the housing;
  - wherein the communication interface in communication with the door so that when the door is opened, the night vision module is coupleable to the imaging device by the communication interface.

\* \* \* \* \*