



US00RE46403E

(19) **United States**
(12) **Reissued Patent**
Smith et al.

(10) **Patent Number:** **US RE46,403 E**
(45) **Date of Reissued Patent:** **May 16, 2017**

- | | |
|--|---|
| (54) DEVICES AND METHODS FOR PERCUTANEOUS TISSUE RETRACTION AND SURGERY | 3,044,461 A 7/1962 Murdock
3,788,318 A 1/1974 Kim et al.
3,807,393 A * 4/1974 McDonald 600/208
4,385,626 A * 5/1983 Danz 600/220
4,545,374 A 10/1985 Jacobson
4,716,901 A 1/1988 Jackson et al.
4,747,394 A 5/1988 Watanabe
4,765,311 A 8/1988 Kulik et al.
4,817,587 A 4/1989 Janese
4,899,729 A 2/1990 Gill et al.
5,139,511 A 8/1992 Gill et al.
5,158,545 A 10/1992 Trudell et al.
5,163,949 A 11/1992 Bonutti
5,171,279 A 12/1992 Mathews A61B 17/70
128/898 |
| (71) Applicant: WARSAW ORTHOPEDIC, INC.,
Warsaw, IN (US) | |
| (72) Inventors: Maurice M. Smith , Cordova, TN (US);
Kevin T. Foley , Germantown, TN (US);
Roy Lim , Germantown, TN (US);
Thomas E. Roehm , Braden, TN (US);
Richard G. Fessler , Winnetka, IL (US) | |
| (73) Assignee: Warsaw Orthopedic, Inc. , Warsaw, IN (US) | 5,197,971 A 3/1993 Bonutti
5,312,417 A 5/1994 Wilk
5,339,803 A 8/1994 Mayzels et al.
5,342,384 A * 8/1994 Sugarbaker 606/191
5,353,784 A 10/1994 Nady-Mohamed
(Continued) |
| (21) Appl. No.: 14/744,710 | |
| (22) Filed: Jun. 19, 2015 | |

Related U.S. Patent Documents

Reissue of:

- (64) Patent No.: **7,261,688**
 Issued: **Aug. 28, 2007**
 Appl. No.: **10/117,440**
 Filed: **Apr. 5, 2002**

FOREIGN PATENT DOCUMENTS

- DE 618652 9/1935
 DE 41 15 548 A1 11/1991
 (Continued)

Primary Examiner — Beverly M Flanagan

- (51) **Int. Cl.**
A61B 1/32 (2006.01)
A61B 17/02 (2006.01)
- (52) **U.S. Cl.**
 CPC *A61B 17/02* (2013.01); *A61B 17/0206* (2013.01)
- (58) **Field of Classification Search**
 CPC *A61B 17/02*; *A61B 17/0206*
 USPC 600/210, 190, 196
 See application file for complete search history.

(57) **ABSTRACT**

Methods and devices for performing percutaneous surgery in a patient are provided. A retractor includes a working channel formed by a first portion coupled to a second portion. The first and second portions are movable relative to one another from an unexpanded configuration to an expanded configuration to increase the size of the working channel along the length of the working channel while minimizing trauma to skin and tissue.

(56) **References Cited**

U.S. PATENT DOCUMENTS

- 52,014 A 4/1866 Bartlett
 1,222,478 A * 4/1917 Sheaff 600/220

71 Claims, 12 Drawing Sheets

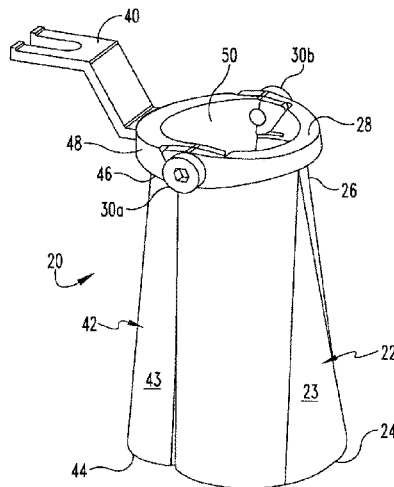

US RE46,403 E

(56)

References Cited

U.S. PATENT DOCUMENTS

5,389,080	A	2/1995	Yoon	
5,490,819	A	2/1996	Nicholas et al.	
5,512,038	A	4/1996	O'Neal et al.	
5,549,595	A	8/1996	Freitas	
5,573,517	A	11/1996	Bonutti et al.	
5,674,240	A	10/1997	Bonutti et al.	
5,688,223	A *	11/1997	Rosendahl	A61B 17/0293 600/201
5,707,359	A	1/1998	Bufalini	
5,755,732	A	5/1998	Green et al.	
5,785,648	A	7/1998	Min	
5,792,044	A	8/1998	Foley et al.	
5,823,947	A	10/1998	Yoon et al.	
5,846,249	A *	12/1998	Thompson	606/119
5,888,196	A	3/1999	Bonutti	
5,899,854	A *	5/1999	Slushman	600/219
5,944,658	A	8/1999	Koros et al.	
5,951,466	A	9/1999	Segermark et al.	
5,954,635	A	9/1999	Foley et al.	
5,961,499	A	10/1999	Bonutti et al.	
5,967,970	A *	10/1999	Cowan	A61B 17/0218 600/114
5,976,146	A	11/1999	Ogawa et al.	
6,024,696	A *	2/2000	Hofman et al.	600/224

6,027,518	A	2/2000	Gaber	
6,074,380	A	6/2000	Byrne et al.	
6,096,046	A	8/2000	Weiss	A61B 17/0206 600/110
6,099,547	A	8/2000	Gellman et al.	
6,162,236	A	12/2000	Osada	
6,171,299	B1	1/2001	Bonutti	
6,187,000	B1	2/2001	Davison et al.	
6,200,322	B1	3/2001	Branch et al.	
6,312,443	B1	11/2001	Stone	
6,325,812	B1	12/2001	Dubrul et al.	
6,354,995	B1 *	3/2002	Hofman	A61B 17/0293 600/219
6,371,911	B1	4/2002	Hossain et al.	
6,520,907	B1	2/2003	Foley et al.	
6,793,656	B1	9/2004	Mathews	
2001/0049498	A1	12/2001	Davison et al.	
2002/0173798	A1	11/2002	DiPoto	
2004/0176763	A1	9/2004	Foley et al.	
2004/0186346	A1	9/2004	Smith et al.	

FOREIGN PATENT DOCUMENTS

FR	2 785 518	5/2000
WO	WO83/03189	9/1983
WO	WO/0134019 A1 *	5/2001

* cited by examiner

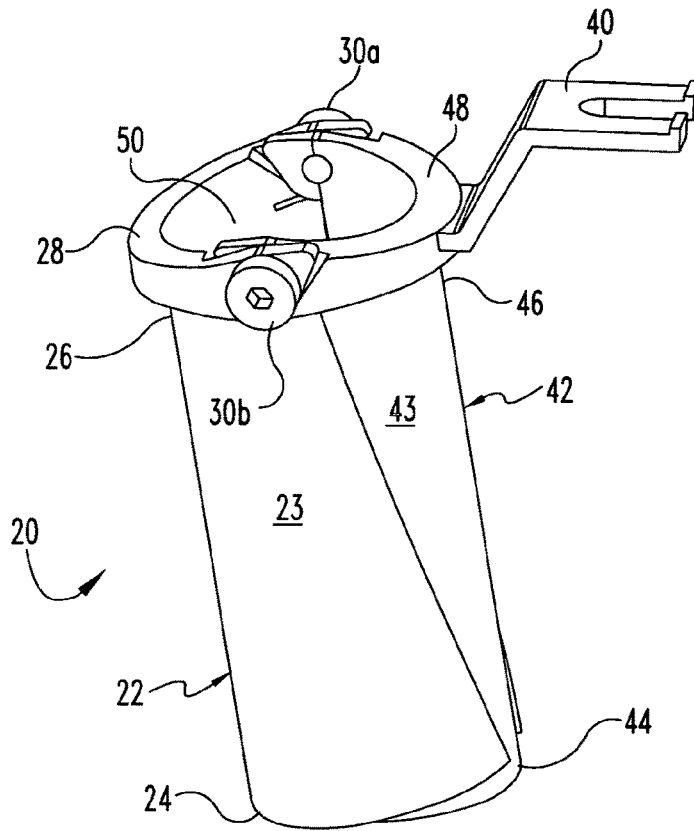

Fig. 1

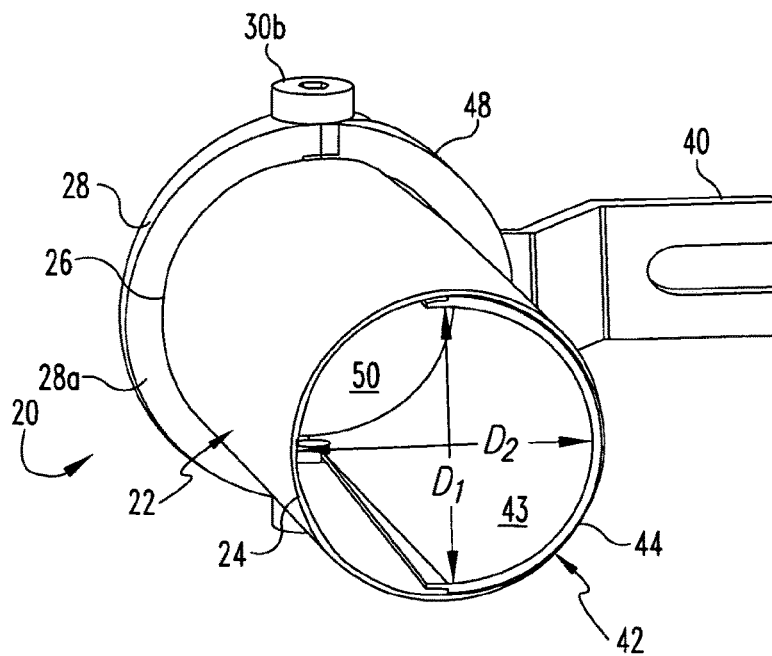

Fig. 2

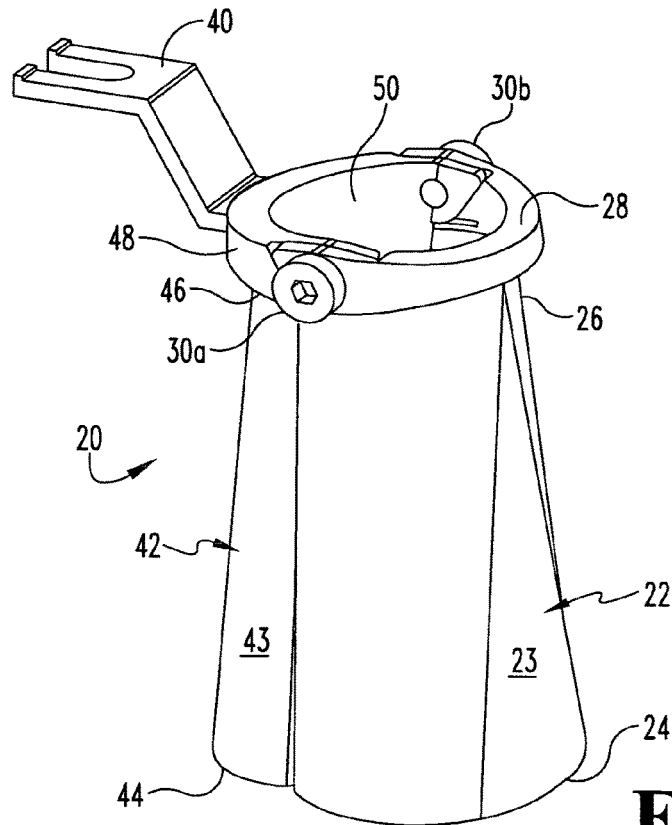

Fig. 3

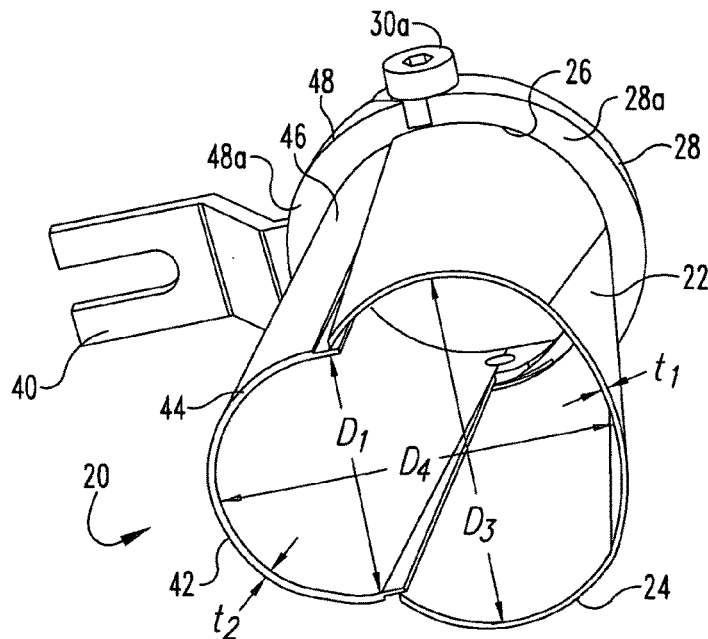

Fig. 4

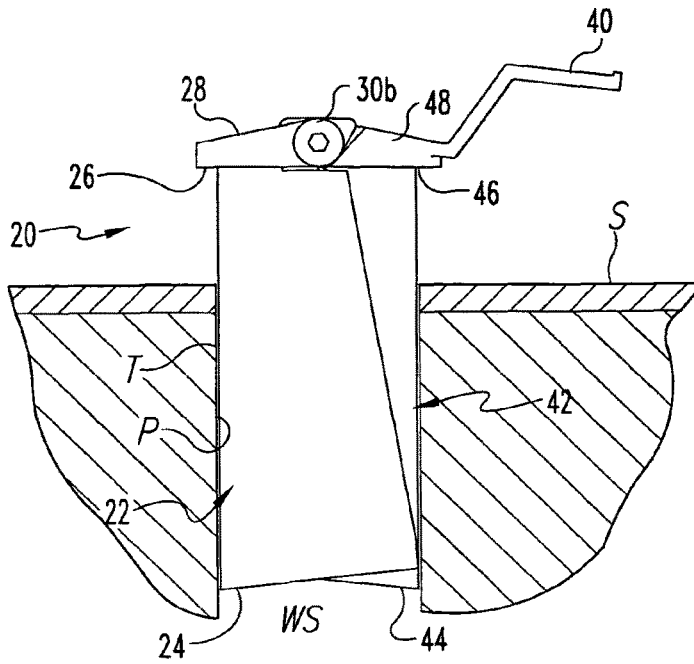

Fig. 5

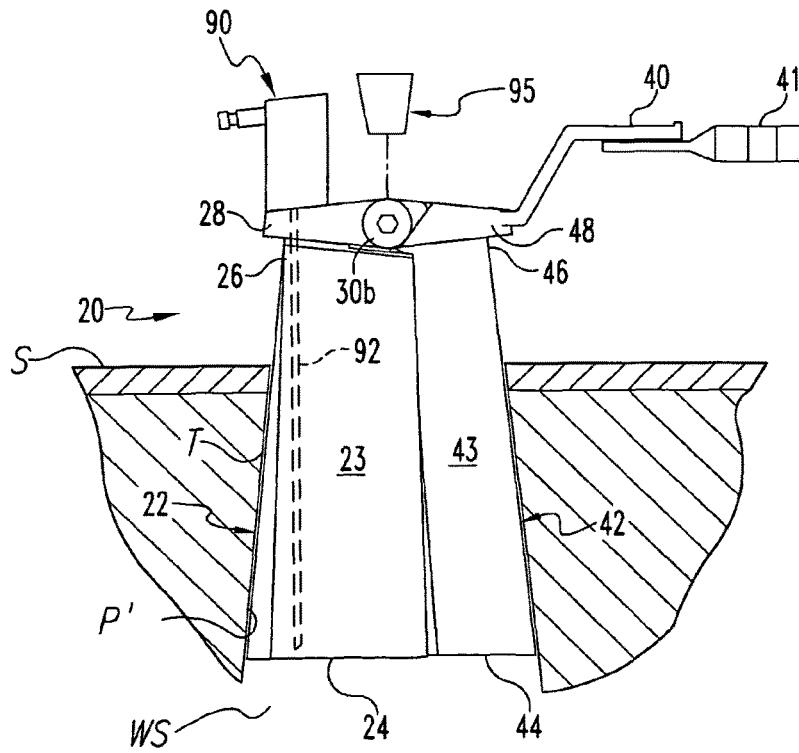

Fig. 6

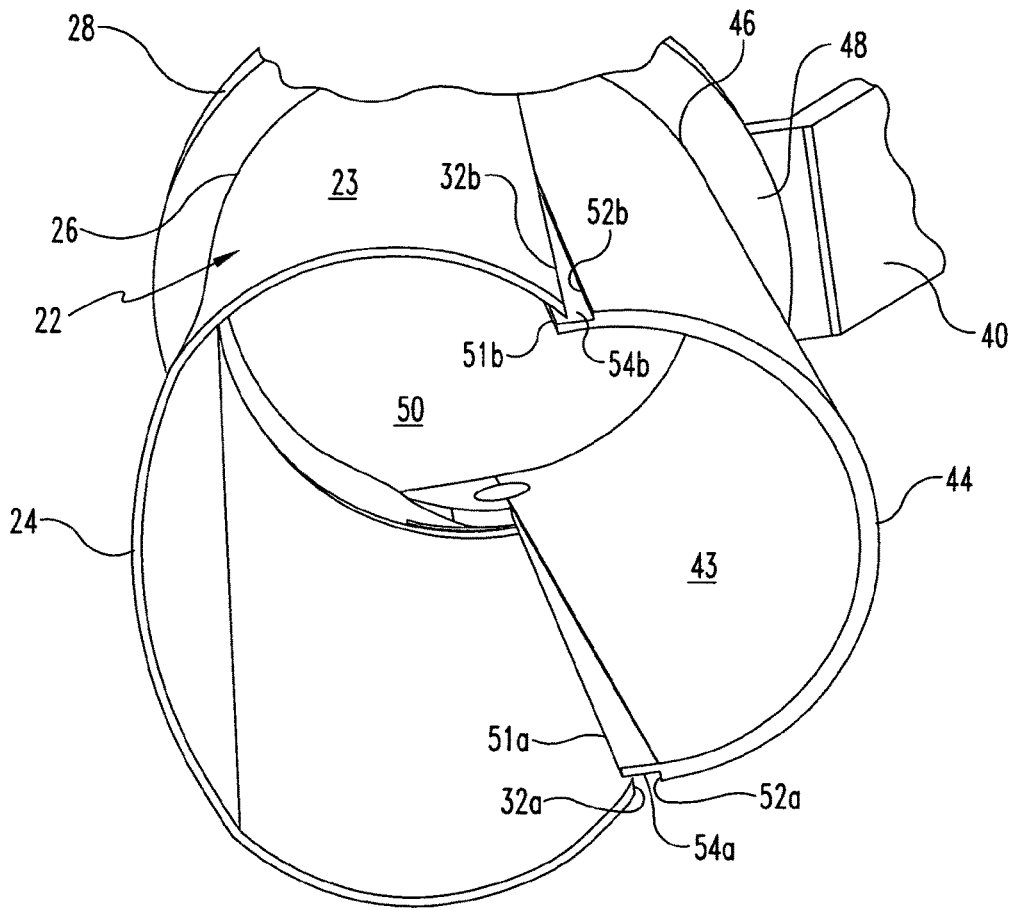

Fig. 7

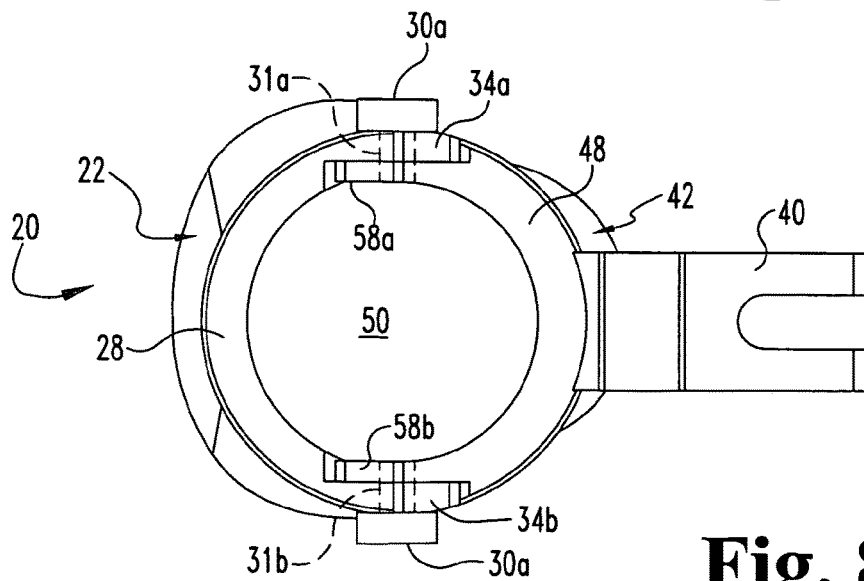

Fig. 8

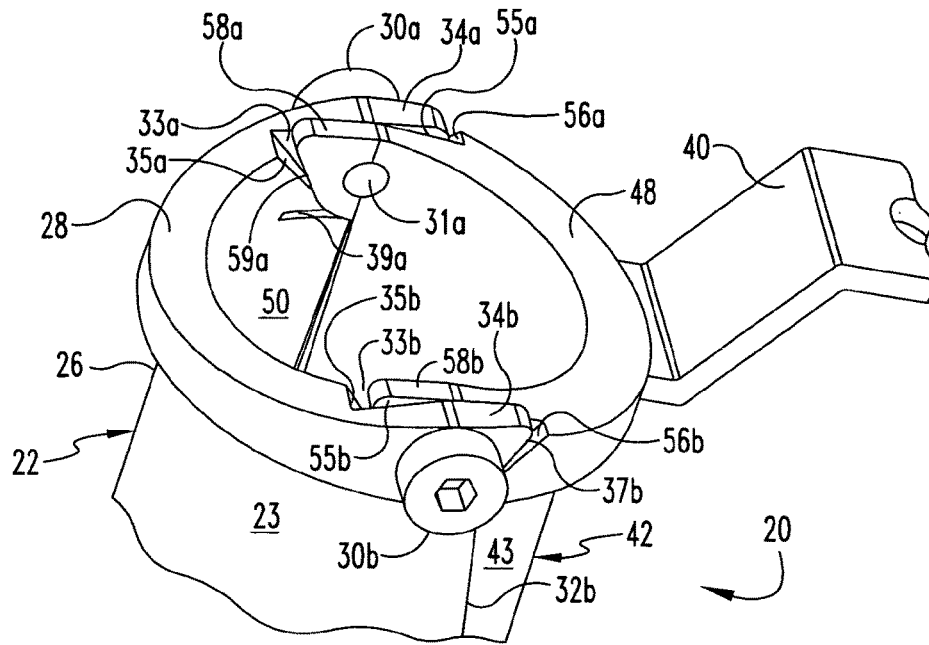

Fig. 9

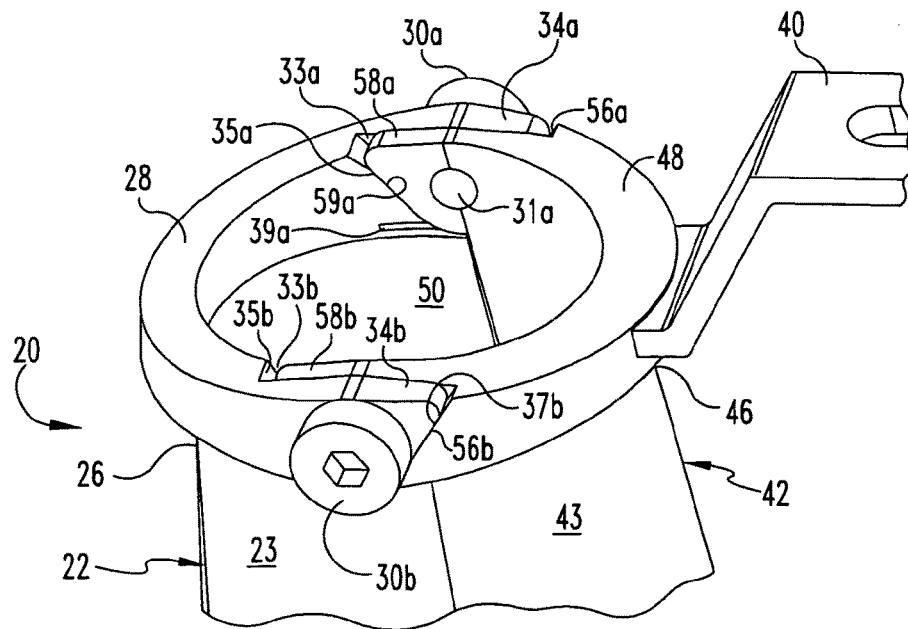

Fig. 10

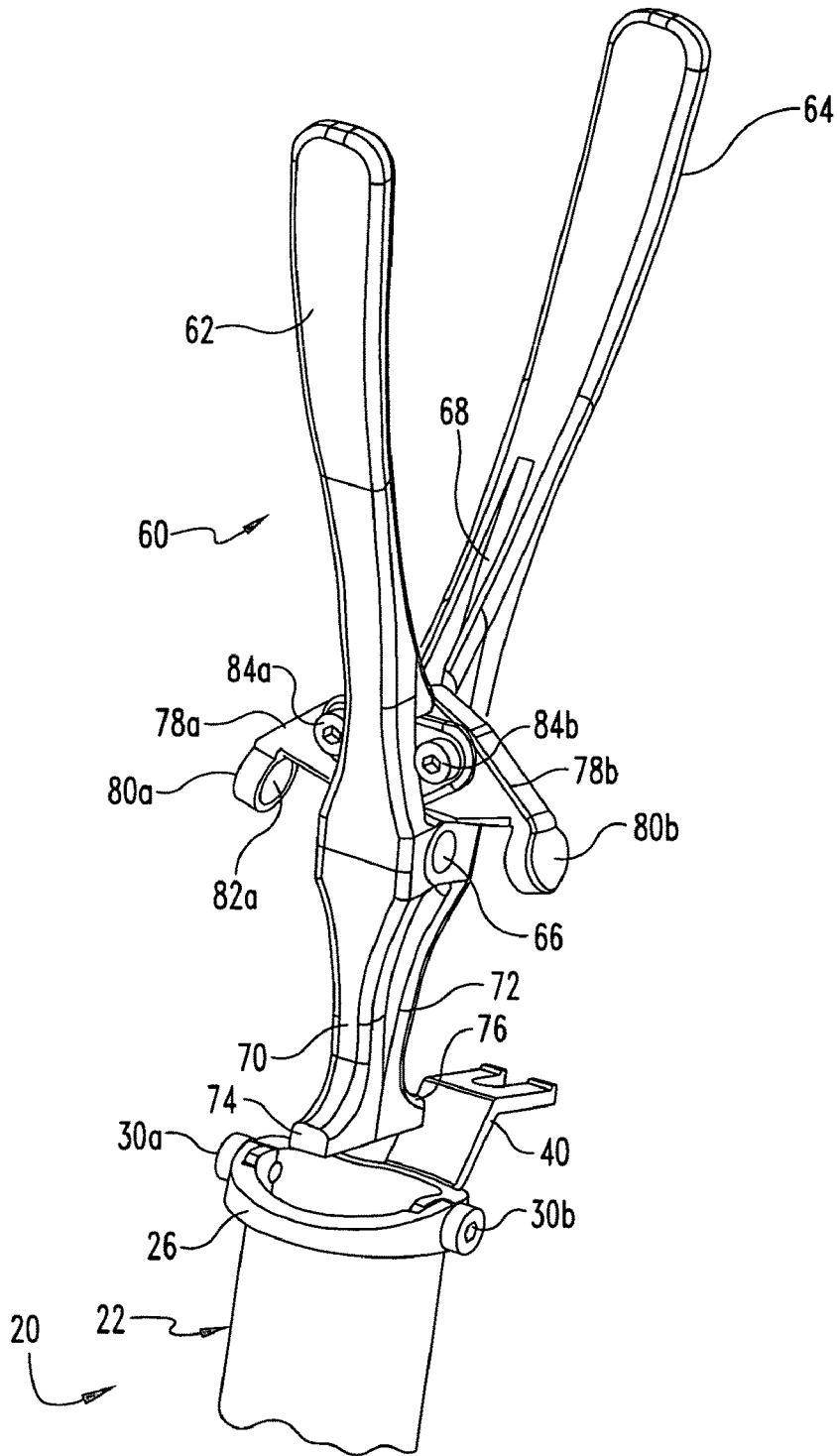

Fig. 11

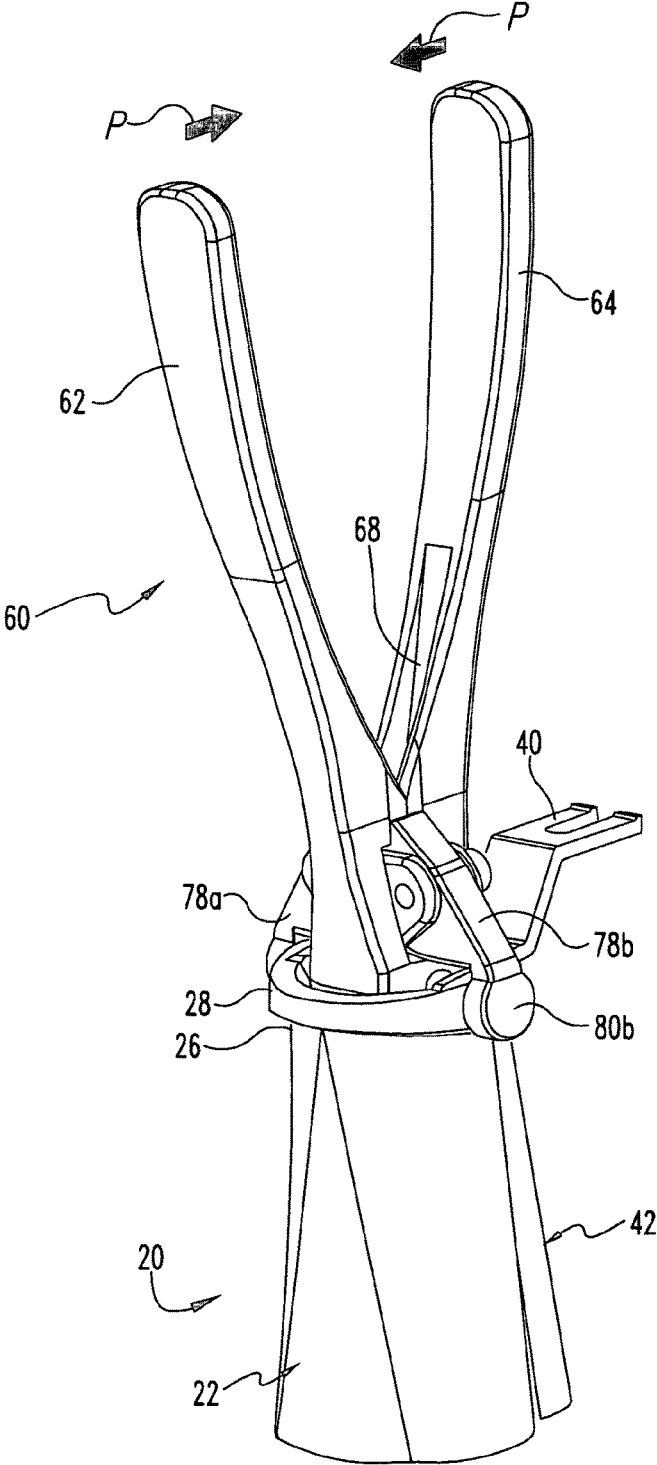

Fig. 12

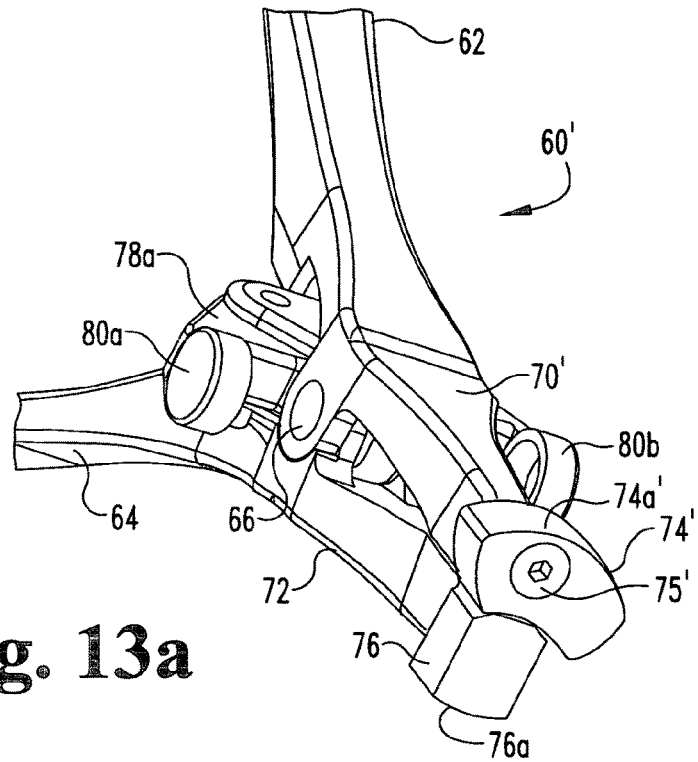

Fig. 13a

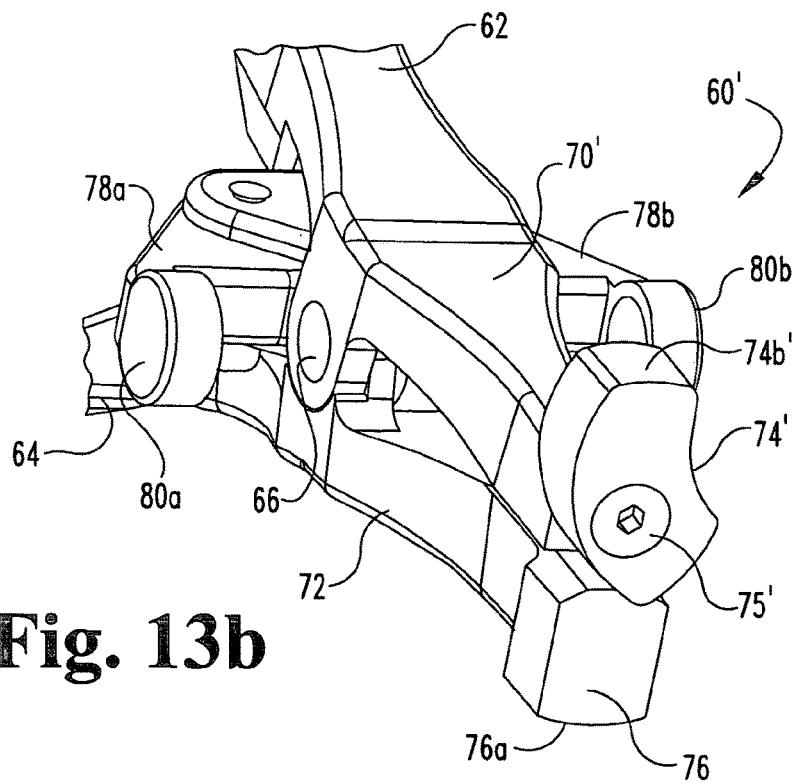

Fig. 13b

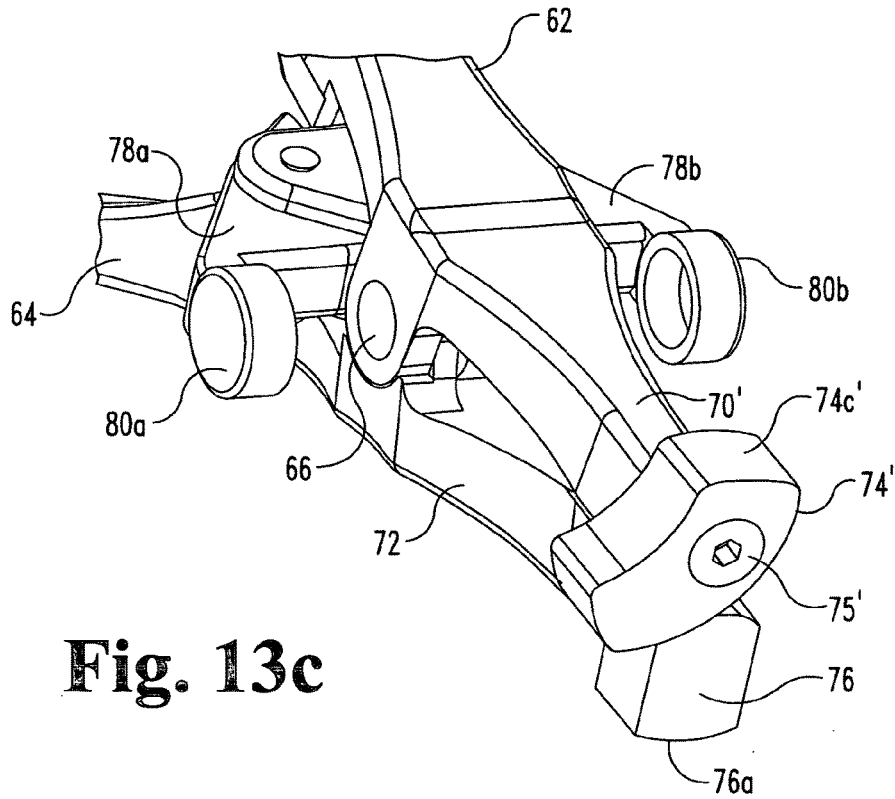

Fig. 13c

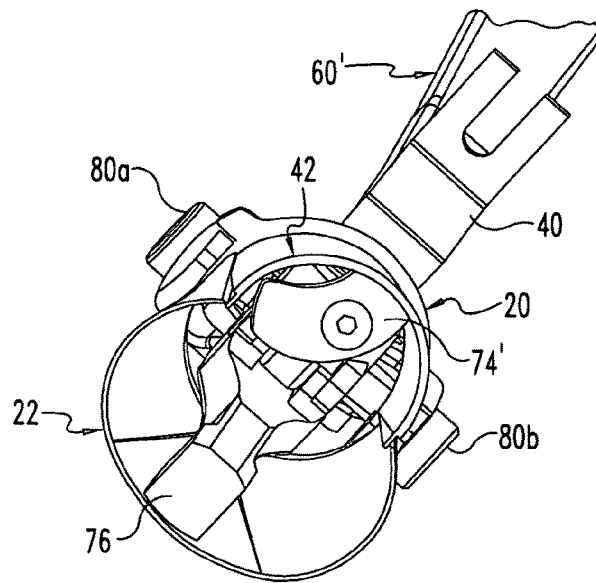

Fig. 13d

Fig. 14a

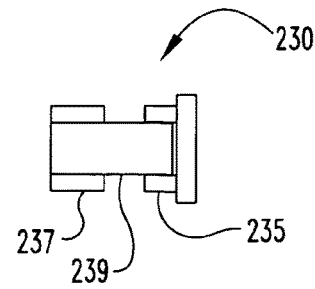
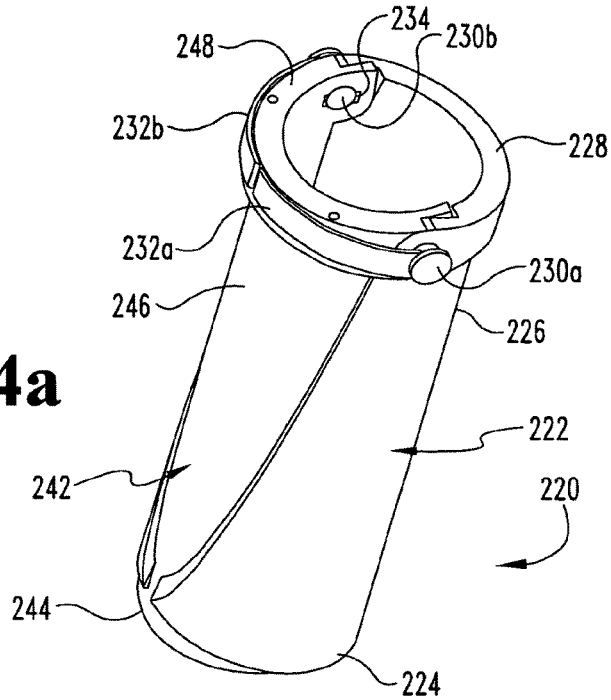
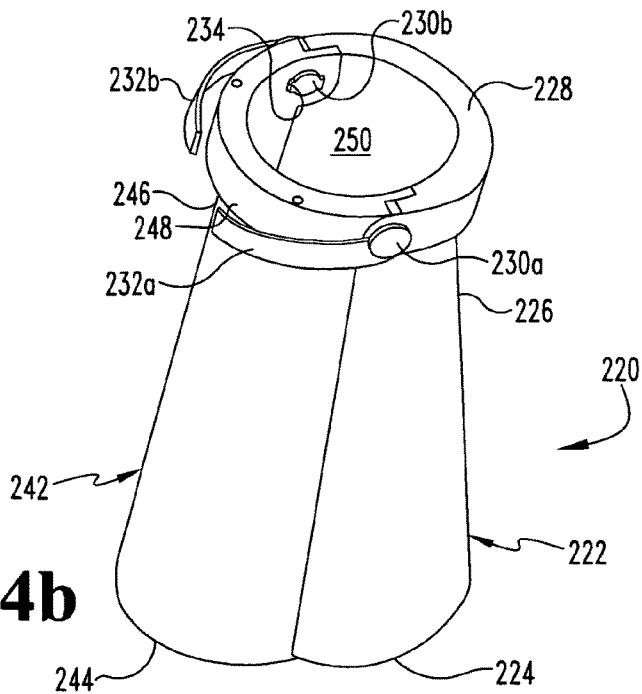

Fig. 14c

Fig. 14b



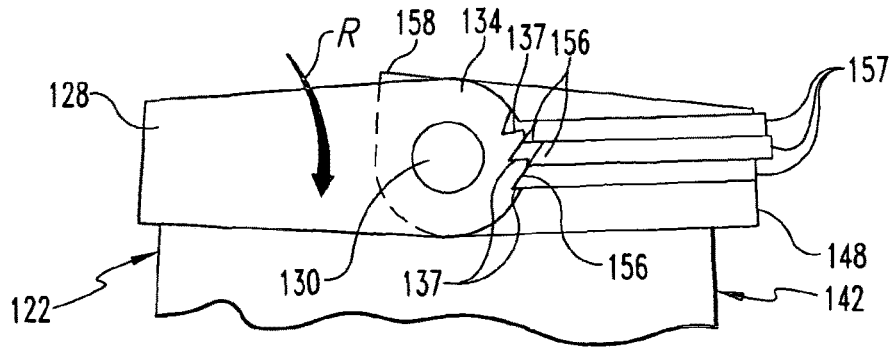

Fig. 15a

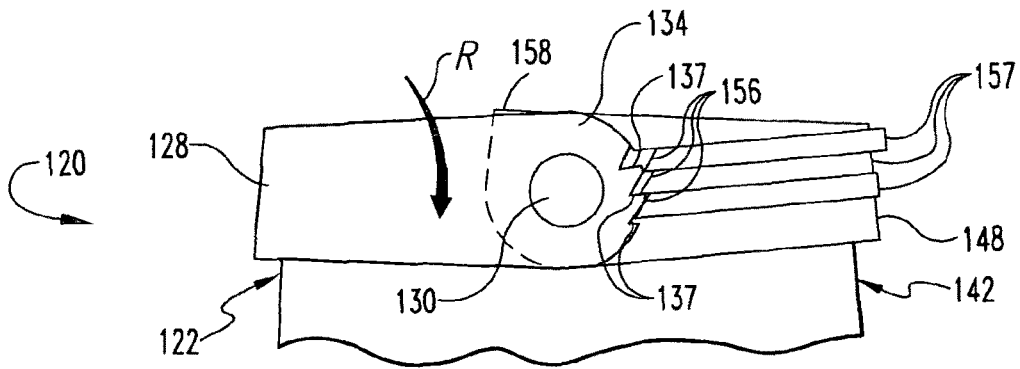

Fig. 15b

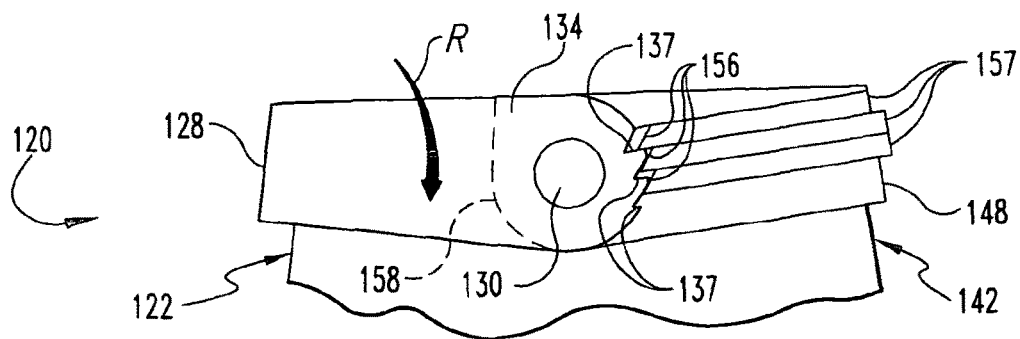

Fig. 15c

1

DEVICES AND METHODS FOR PERCUTANEOUS TISSUE RETRACTION AND SURGERY

Matter enclosed in heavy brackets [] appears in the original patent but forms no part of this reissue specification; matter printed in italics indicates the additions made by reissue; a claim printed with strikethrough indicates that the claim was canceled, disclaimed, or held invalid by a prior post-patent action or proceeding.

BACKGROUND

The present invention relates to devices, instruments and methods for performing percutaneous surgeries.

Traditional surgical procedures for pathologies located deep within the body can cause significant trauma to the intervening tissues. These open procedures often require a long incision, extensive muscle stripping, prolonged retraction of tissues, denervation and devascularization of tissue. These surgeries can require operating room time of several hours and several weeks of post-operative recovery time due to the use of general anesthesia and the destruction of tissue during the surgical procedure. In some cases, these invasive procedures lead to permanent scarring and pain that can be more severe than the pain leading to the surgical intervention.

The development of percutaneous procedures has yielded a major improvement in reducing recovery time and post-operative pain because minimal muscle and tissue dissection is required and the procedures can be performed under local anesthesia. For example, minimally invasive surgical techniques are desirable for spinal and neurosurgical applications because of the need for access to locations deep within the body and the danger of damage to vital intervening tissues. While developments in minimally invasive surgery are steps in the right direction, there remains a need for further development in minimally invasive surgical devices and techniques.

SUMMARY OF THE INVENTION

The present invention is directed to methods and devices for performing surgery in a patient. One specific application concerns devices, instruments and techniques for percutaneous, minimally invasive spinal surgery. A further specific application includes percutaneous tissue retraction to provide access to the surgical location in the patient. Another specific application includes surgery performed through the percutaneously retracted tissue under direct vision at any location in the body. Also contemplated are surgical methods and techniques employing the instruments and devices described herein.

DESCRIPTION OF THE FIGURES

FIG. 1 is a perspective view looking toward one side of a retractor in an unexpanded configuration.

FIG. 2 is a perspective view looking toward the bottom of the retractor of FIG. 1.

FIG. 3 is a perspective looking toward the other side of the retractor of FIG. 1 with the retractor in an expanded configuration.

FIG. 4 is a perspective view looking toward the bottom of the expanded retractor of FIG. 3.

2

FIG. 5 is a side view of the retractor shown in FIG. 1 inserted through an incision in a patient with the retractor in an unexpanded configuration.

FIG. 6 is the retractor of FIG. 5 in an expanded configuration and with viewing instruments diagrammatically shown.

FIG. 7 is a perspective view looking toward the bottom of the expanded retractor of FIG. 3.

FIG. 8 is a top plan view of the expanded retractor of FIG. 3.

FIG. 9 is a perspective view of the upper portion of the unexpanded retractor of FIG. 1.

FIG. 10 is a perspective view of the upper portion of the expanded retractor of FIG. 3.

FIG. 11 is a perspective view of the upper portion of the unexpanded retractor of FIG. 1 with an expansion instrument positioned adjacent thereto.

FIG. 12 is a perspective view of the retractor of FIG. 3 with the expansion instrument of FIG. 11 positioned therein to move the retractor to its expanded configuration.

FIGS. 13a-13dc illustrate another embodiment expansion instrument having an adjustable foot.

FIGS. 14a-14c illustrate another embodiment expandable retractor and a coupling member comprising a portion thereof.

FIGS. 15a-15c illustrate the proximal end of yet another embodiment expandable retractor.

FIGS. 16a-16b illustrate another embodiment expandable retractor.

DESCRIPTION OF THE ILLUSTRATED EMBODIMENTS

For the purposes of promoting an understanding of the principles of the invention, reference will now be made to the embodiments illustrated in the drawings and specific language will be used to describe the same. It will nevertheless be understood that no limitation of the scope of the invention is thereby intended. Any such alterations and further modifications in the illustrated devices and described methods, and such further applications of the principles of the invention as illustrated herein are contemplated as would normally occur to one skilled in the art to which the invention relates.

The present invention provides instruments and methods for performing percutaneous surgery, including spinal surgeries that include one or more techniques such as laminotomy, laminectomy, foramenotomy, facetectomy, discectomy, interbody fusion, spinal nucleus or disc replacement, and implant insertion, for example. The surgery is performed through a working channel or passageway provided by a retractor. Viewing of the surgical site at the working end of the retractor can be accomplished with optics mounted on the retractor, positioned over the retractor, and/or through a viewing system such as lateral fluoroscopy. The retractor is expandable in situ to increase the size of the working channel to facilitate access to the working space at the distal end of the retractor while minimizing trauma to tissue surrounding the retractor. The retractor can be used with any surgical approach to the spine, including anterior, posterior, posterior mid-line, lateral, postero-lateral, and/or anterolateral approaches, and in other regions besides the spine.

In FIGS. 1-2 there is illustrated a retractor 20 that includes a first portion 22 coupled to a second portion 42. First portion 22 has a distal end 24 and an opposite proximal end 26. Second portion 42 has a distal end 44 and an opposite proximal end 46. In the illustrated embodiment, first portion

22 is pivotally coupled to second portion 42 at proximal ends 26, 46. A working channel 50 is formed by first portion 22 and second portion 42. Working channel 50 extends between and opens at distal ends 24, 44 and proximal ends 26, 46. Retractor 20 is movable to an expanded configuration, as shown in FIGS. 3-4, by pivoting first portion 22 and second portion 42 relative to one another about proximal ends 26, 46. Other coupling arrangements are also contemplated that allow first portion and second portion 42 to be moved away from one another to expand retractor 20 and increase the size of working channel 50 between its distal and proximal ends.

Retractor 20 is insertable through skin and tissue of a patient to provide working channel 50 to the surgical site. It is contemplated that retractor 20 is inserted through the skin and tissue in an unexpanded configuration, such as shown in FIGS. 1-2. After insertion into the patient, retractor 20 is expanded through the skin and tissue to an expanded configuration that increases the size of working channel 50 from proximal ends 26, 46 to distal ends 24, 44.

First portion 22 includes a semi-cylindrical body 23 extending between distal end 24 and proximal end 26. A collar 28 extends about proximal end 26, and forms a lip 28a extending about the outer surface of body 23. Second portion 42 includes a semi-cylindrical body 43 extending between distal end 44 and proximal end 46. A collar 48 extends about proximal end 46 of second portion 42, and defines a lip 48a extending about the outer surface of body 43. A first coupling member 30a pivotally couples a first side of first portion 22 to second portion 42 at their proximal ends 26, 46. A second coupling member 30b opposite first coupling member 30a pivotally couples the other side of first portion 22 to second portion 42 at their proximal ends 26, 46 along another side of retractor 20.

In the illustrated embodiment, first and second coupling members 30a, 30b are pins that extend through aligned holes or passageways provided through collars 28, 48 to pivotally couple first portion 22 to second portion 42. Other coupling arrangements are also contemplated at proximal ends 26, 46 of first and second portions 22, 42. For example, proximal end 26 of first portion 22 may be hingedly attached to proximal end 46 of second portion 42 with one or more hinges at each side of retractor 20. In another embodiment, at least the proximal ends of first portion 22 and second portion 42 are formed of a single piece of material and a resilient hinge couples first portion 22 to second portion 42 at their proximal ends 26, 46. Other embodiments contemplate a slotted arrangement extending around the proximal end of one of the retractor portions and one or more pins from the other retractor portion received in the slotted arrangement.

A bracket 40 extends from and is integrally formed with or attached to collar 48 of second portion 42. Bracket 40 can also be provided on collar 28 in lieu of or in addition to bracket 40 on collar 48. Bracket 40 extends away from working channel 50 and is connectable to one end of a flexible or articulatable arm 41 (FIG. 6.) The opposite end of arm 41 (not shown) can be mounted on the surgical table or other support device. Arm 41 supports retractor 20 in the patient yet allows percutaneous manipulation and re-positioning of retractor 20.

Body 23 of first portion 22 extends around at least a portion of body 43 of second portion 42. Body 23 has a perimeter length along distal end 24 which is greater than the perimeter length of body 23 at proximal end 26. Body 43 of second portion 42 includes a perimeter length along distal end 44 which is the same or can be about the same as the perimeter length of body 43 adjacent proximal end 46. Body

23 of first portion 22 can be flexible enough to extend around second portion 42 in form fitting relationship when retractor 20 is the unexpanded configuration of FIGS. 1 and 2 to minimize the profile of retractor 20. Body 23 flexes outwardly and rides along the outer surface of body 43 of second portion 42 as first portion 22 and second portion 42 are pivoted relative to one another to the expanded configuration of retractor 20.

In one specific embodiment, first portion 22 and second portion 42 are each made from surgical grade stainless steel. Other materials are also contemplated for bodies 23, 43, including, for example, plastics and metals and metal alloys, such as, for example, spring steel, shape memory metals and alloys, and aluminum. It is contemplated that body 23 can be provided with a cross-sectional thickness t_1 that provides the desired flexibility, yet is sufficiently rigid to maintain retraction of the skin and tissue. Body 43 of second portion 42 can be provided with a thickness t_2 that can be the same or greater than thickness t_1 of first portion 22. The reduced thickness of body 23 provides it greater flexibility to flex inwardly and outwardly expand around body 43 of second portion 42. Thickness t_2 provides second portion 43 greater rigidity to resist bending or bowing under the forces exerted on it by body 23 during and after movement of retractor 20 to its expanded configuration.

In the unexpanded configuration, working channel 50 has a generally circular cross-section along retractor 20, as best shown in FIG. 2. Working channel 50 has a first width D1 between the opposite edges of second portion 42 positioned in first portion 22. A second width D2 is defined between the mid-portions of first body 23 and second body 43 in the direction of expansion of first portion 22 relative to second portion 42. In the illustrated embodiment, first and second widths D1 and D2 are substantially the same since unexpanded working channel 50 has a generally circular cross-section. In the expanded configuration, as shown in FIG. 4, the portion of the expanded working channel 50 extending along the opposite edges of second body 43 maintains first width D1. However, first body 23 is flexed outwardly relative to second body 43, and defines a third width D3 between the sides of first body 23 that is greater than first width D1. In the expanded configuration of working channel 50, first body 23 and second body 43 define a fourth width D4 in the direction of expansion of first portion 22 relative to second portion 42 that is greater than second width D2. It is further contemplated that width D4 can be greater than widths D1 and D3.

Various configurations for working channel 50 are contemplated. In the unexpanded configuration, working channel 50 can have a cylindrical shape with, for example, a circular, oval, elliptical, or polygonal cross-section. In the expanded configuration, working channel 50 can have a frusto-conical shape with, for example a cross-section that is figure-eight or snowman shaped, oval, elliptical, circular or polygonal. In at least the direction of expansion, the size of the cross-section of working channel 50 decreases from distal end to the proximal end of retractor 20.

In one specific application for spinal surgery, it is contemplated that, after insertion of retractor 20, first portion 22 and second portion 42 are expanded predominantly in one direction to retract muscle and tissue along pathway P. For example, retractor 20 can be primarily or predominantly expandable in the direction of the spinal column axis. Since the muscle tissue adjacent the spine has a fiber orientation that extends generally in the direction of the spinal column axis, the expansion of retractor 20 separates the muscle tissue along the fibers, thus minimizing their separation and

the resultant tearing and trauma to the muscle tissue is minimized. It is also contemplated in other techniques employing retractor **20** that working channel **50** expands primarily in a direction other than along the spinal column axis or in areas other than spine. Embodiments of retractor **20** are also contemplated in which working channel **50** is circular or polygonal in cross-section and expands substantially the same amount in all directions.

Referring now to FIGS. **5-6**, positioning of retractor **20** through the skin **S** and tissue **T** of the patient will be described. An incision is made in skin **S** adjacent the location of a patient's anatomy to be accessed. For example, in spinal surgery, the incision can be made at a vertebral level at a location that provides access to the disc space between adjacent vertebrae or to one or more vertebra through a desired approach. Prior to insertion of retractor **20**, skin **S** and tissue **T** can be sequentially dilated via guide-wires and/or one or more dilators of increasing size to form a pathway **P** through skin **S** and tissue **T** to the surgical site in the patient. In such procedures, retractor **20** is positioned over the last inserted dilator in pathway **P** for retractor **20**. Working channel **50** through retractor **20** provides access to a working space **WS** at the distal end of retractor **20** when the guidewires and dilators, if used, are removed therefrom.

For the entire surgery or for certain procedures, it may be desired by the surgeon to increase the size of working channel **50** to facilitate access working space **WS** below the distal end of retractor **20**, or to even provide a greater working space **WS**. Retractor **20** can be pivoted from its unexpanded, insertion configuration to an expanded configuration as shown in FIG. **6**. In the expanded configuration, first portion **22** and second portion **42** are pivoted away from one another about first and second coupling members **30a**, **30b** at proximal ends **26**, **46**. In the expanded configuration, pathway **P'** through skin **S** and tissue **T** is formed by first portion **22** and second portion **42**. The size of working space **WS** can be increased while minimizing trauma to the tissue and skin along pathway **P**.

Working channel **50** has a tapered configuration that reduces in size from the distal end of retractor **20** adjacent working space **WS** through skin **S** to the proximal end of retractor **20**. The tapered working channel provides the surgeon greater access and increased visualization of working space **WS**. The tapered working channel **50** also allows greater angulation of instruments placed through working channel **50**, more selection in positioning of instruments within working channel **50**, and the ability to position instruments adjacent the inner wall surfaces of the expanded first and second portions **22**, **42**, increasing the room available at working space **WS** for multiple instruments.

Viewing instruments can be positioned in or adjacent to working channel **50** to facilitate surgeon viewing of working space **WS** and the operative site. For example, an endoscopic viewing element **90** can be mounted on the proximal end of retractor **20** such that its scope portion **92** extends along working channel **50**. A microscopic viewing element **95** can also be positioned over the proximal end of retractor **20** for viewing working space **WS** and the surgical site. Other imaging techniques, such as lateral fluoroscopy, can be used alone or in combination with the endoscopic and microscopic viewing elements. Further examples of such viewing instruments and mounting or orienting the same relative to retractor **20** are provided in U.S. patent application Ser. No. 09/815,693 filed on Mar. 23, 2001, which is hereby incorporated herein by reference in its entirety. It is further contemplated that other instruments can be mounted on the proximal end of retractor **20**, such as nerve root retractors,

tissue retractors, irrigation and/or aspiration instruments, illumination instruments and the like for use in surgical procedures through retractor **20** in the working space.

Referring now to FIG. **7**, further details regarding the engagement of first portion **22** and second portion **42** when retractor **20** is in the expanded configuration will be provided. First body **23** of first portion **22** includes a first edge **32a** extending between distal end **24** and proximal end **26**. First body **23** of first portion **22** includes an opposite second edge **32b** extending between distal end **24** and proximal end **26**. Second portion **42** includes a first edge **51a** extending along one side of second body **43** and an opposite second edge **51b** extending along the opposite side of second body **43**. First edge **51a** includes a grooved portion **54a** extending from distal end **44** along at least a portion of the length of first edge **51a**. An engagement surface **52a** extends along grooved portion **54a**. Similarly, second edge **51b** includes grooved portion **54b** extending from distal end **44** along at least a portion of the length of second edge **51b**. An engagement surface **52b** extends along grooved portion **54b**.

With retractor **20** in its expanded configuration, first edge **51a** of second body **43** is adjacent first edge **32a** of first body **23**, and second edge **51b** of body **43** is adjacent second edge **32b** of first body **23**. First edge **32a** resides at least partially in grooved portion **54a**, and second edge **32b** resides at least partially in grooved portion **52b**. First edge **32a** contacts engagement surface **52a** along grooved portion **54a** to maintain retractor **20** in its expanded configuration. Similarly, second edge **32b** contacts engagement surface **52b** in grooved portion **54b** to maintain retractor **20** in its expanded configuration. The flexible second portion **22** tends to return toward its unexpanded configuration, thus first and second edges **32a**, **32b** frictionally engage the engagement surfaces extending along each of the grooved portions **54a**, **54b**. This locks first portion **22** with respect to second portion **42** in the expanded configuration, resisting collapse of the working channel by pressure of the surrounding tissue on first and second portions **22**, **42** and facilitating manipulation of retractor **20** in the tissue without collapse of the working channel.

Other means for locking first and second portion **22**, **42** in the expanded configuration are also contemplated. For example, second portion **42** can be provided with a ridge or protrusion at each of its opposite edges, and first portion **44** can engage the ridge or protrusion.

By maintaining a closed configuration for the working channel between first portion **22** and second portion **42** in the expanded configuration, migration of tissue into working channel **50** is prevented by the walls of first and second portions **22**, **42**. Other embodiments contemplate that working channel **50** is not completely enclosed.

Referring now to FIGS. **8-10**, further details regarding proximal ends **26**, **46** of first and second portions **22**, **42** will be described. Collar **28** includes a recess **33a** formed adjacent first edge **32a** on one side of first portion **22**, and a second recess **33b** opposite first recess **33a** on the other side of first portion **22**. Recess **33a** includes an engagement surface **35a** along an inner side thereof, and second recess **33b** includes an engagement surface **35b** extending along an inner side thereof. A first extension **34a** extends along the outside of first recess **33a**, and a second recess **34b** extends along the outside of second recess **33b**. First extension **34a** and second extension **34b** extend beyond the adjacent first edge **32a** and second edge **32b**, respectively, of body **23** of first portion **22**.

Second portion **42** includes a first recess **55a** along one side of second portion **42**, and a second recess **55b** along

another side of second portion 42. First recess 55a includes an engagement surface 56a, and second recess 55b includes an engagement surface 56b. A first extension 58a extends along the inner side of first recess 55a, and a second extension 58b extends along the inner side of second recess 55b. First extension 58a includes an engagement surface 59a, and second extension 55b also includes a similarly situated engagement surface. First extension 58a resides within first recess 33a adjacent first extension 34a of first portion 22, and second extension 58b resides within second recess 33b adjacent second extension 34b of first portion 22. First coupling member 30a includes a pin extending through passage 31a of first extension 34a of first portion 22 and pivotally couples first extension 58a of second portion 42 thereto. Second coupling member 30b includes a pin extending through passage 31b of second extension 34b of first portion 22 and pivotally couples second extension 58b of second portion 42 thereto.

With retractor 20 in its unexpanded configuration as shown in FIG. 9, a gap is formed between engagement surfaces 35a, 35b of first portion 22 and engagement surfaces 59a, 59b of extensions 58a, 58b of second portion 42. As retractor 20 is moved to its expanded configuration as shown in FIG. 10, engagement surfaces 59a, 59b contact engagement surfaces 35a, 35b of first portion 22. Also, engagement surfaces 37a, 37b of extensions 34a, 34b of first portion 22 contact engagement surfaces 56a, 56b of second portion 42. The contact between the engagement surfaces of the recesses and extensions limit the pivotal movement of first portion 22 relative to second portion 42. First portion 22 can include a relieved portion 39a below first engagement surface 59a and a similar relief under second engagement surface 35b. The reliefs allow some flexing of engagement surfaces 35a, 35b to ensure engagement surfaces 59a, 59b of extensions 58a, 58b fully seat on engagement surfaces 35a, 35b.

Referring now to FIGS. 11-12 there is shown retractor 20 with an expansion instrument 60. Expansion instrument 60 includes a first handle 62 pivotally coupled to a second handle 64 with pin 66. A leaf spring 68 can extend between first handle 62 and second handle 64 to bias handles 62, 64 in a closed position as shown in FIG. 11. Extending distally from the pivotal connection of first handle 62 and second handle 64 are first distal portion 70 and second distal portion 72, respectively. Distal portion 70 includes a foot 74 at a distal end thereof, and distal portion 72 includes a foot 76 at a distal end thereof. Feet 74, 76 extend toward first portion 22 and second portion 42, respectively when expansion instrument 60 is inserted in working channel 50 of retractor 20.

Expansion instrument 60 includes a first arm 78a and a second arm 78b above pin 66. First arm 78a is pivotally coupled to first and second handles 62, 64 via coupler 84a, and second arm 78b is pivotally coupled to first and second handles 62, 64 via coupler 84b. First and second arms 78a, 78b extend transversely to the orientation of feet 74, 76. First arm 78a includes an engagement member 80a having a receptacle 82a positionable over the head of first coupling member 30a. Second arm 78b includes an engagement member 80b having a receptacle positionable over the head of second coupling member 30b.

As shown in FIG. 12, expansion instrument 60 is mountable on retractor 20 by pivoting first arm 78a so that first coupling member 30a is captured in receptacle 82a of engagement member 80a, and second coupling member 30b is captured in receptacle 82b of engagement member 80b. The engagement of expansion instrument 60 to retractor 20

ensures that expansion instrument 60 is not inserted too far into working channel 50 before and during insertion, and allows the application a steady and uniform expansion force without expansion instrument 60 slipping relative to retractor 20. With expansion instrument 60 mounted on retractor 20, handles 62, 64 are pressed toward one another in order to move feet 74, 76 away from one another transverse to the pivot axis of first portion 22, second portion 42 and into contact with adjacent first portion 22 and second portion 42. Feet 74, 76 apply a force on first portion 22 and second portion 42 to pivot first and second portions 22, 42 about their proximal ends to move retractor 20 to its expanded configuration. Retractor 20 can be locked in the expanded configuration by engagement of edges 32a, 32b of first portion 22 with the respective engagement surfaces of second portion 42.

To collapse retractor 20 to its unexpanded configuration, expansion instrument 60 is rotated 90 degrees so the feet 74,76 can apply an expansion force to first portion 22 in the direction of the pivot axis of first portion 22 and second portion 42. The expansion of first portion 22 in this direction disengages or unlocks edges 32a, 32b from engagement surfaces 52a, 52b of second portion 42 and allows first portion 22 and second portion 42 to pivot relative to one another to unexpand retractor 20. Retractor 20 can then be withdrawn from the tissue in its unexpanded condition, minimizing pressure on the adjacent tissue as retractor 20 is withdrawn.

Referring now to FIGS. 13a-13d, there is shown another embodiment expansion instrument 60'. Except as otherwise provided, expansion instrument 60' can be similar to expansion instrument 60 discussed above, and like elements between expansion instruments 60 and 60' are designated with the same reference numeral. Expansion instrument 60' includes a movable foot 74' coupled to distal portion 70'. In the illustrated embodiment, foot 74' is rotatable about pin 75' relative to distal portion 70' in order to position selected ones of the retractor portion contact surfaces 74a', 74b' or 74c' adjacent one of the retractor portions 22, 42.

The contact surfaces 74a', 74b' and 74c' are located at differing distances from pin 75' to allow the surgeon to select the desired amount of expansion for retractor 20. Foot 74' is rotated about pin 75' to select the desired contact surface by orienting the desired contact surface away from contact surface 76a of foot 76. For example, as shown in FIG. 13a, contact surface 74a' is selected to provide minimum expansion since it is located closest to pin 75'. In FIG. 13b contact surface 74b' is selected to provide maximum expansion since it is located furthest away from pin 75'. In FIG. 13c contact surface 74c' is selected to provide intermediate expansion since it has a distance from pin 75' that is between the distances of contact surface 74a' and contact surface 74b'. FIG. 13d shows expansion instrument 60' mounted on retractor 20 with contact surface 74c' of foot 74 in contact with second portion 42 and contact surface 76a of foot 76 in contact with first portion 22 of retractor 20.

It is further contemplated that the amount of expansion provided by each of the contact surfaces 74a', 74b' and 74c' can correspond to a particular retractor length. For example, with expansion instrument 60' mounted on the retractor, the depth which expansion instrument 60' extends into the retractor is the same no matter the length of the retractor. Thus, to provide the same size opening at the distal end of the retractor, the first and second portions of a shorter retractor will be separated a greater amount at the depth of feet 74', 76 than will a longer retractor. Accordingly, contact surface 74a' can be selected for a longer length retractor,

contact surface 74b' can be selected for a shorter length retractor, and contact surface 74c' can be selected for an intermediate length retractor.

Of course, expansion instruments 60, 60' can be oriented so that feet 74, 74' contact first portion 22 and foot 76 contacts second portion 42. It is further contemplated that expansion instruments 60, 60' can be provided so that they are not mountable on the retractor, but rather are held in position at the desired depth in the retractor for expansion of the retractor.

It is contemplated that for spinal surgery various retractors 20 can be provided in a kit with lengths ranging from 20 millimeters to 100 millimeters in increments of 10 or 20 millimeters. It is further contemplated that retractor 20 can be provided in a kit with various diameters, such as 14, 16, 18, 20, 21 or 25 millimeters in its unexpanded configuration. It should be understood, however, that the present invention contemplates that retractor 20 can have other lengths and diameters and can be provided in a kit with different increments. The appropriate length for retractor 20 will depend on the depth of the desired surgical location below the skin S of the patient, the anatomical location of the surgery, and the patient's anatomy. These factors in retractor selection can be evaluated through pre-operative planning prior to surgery by x-rays or other known imaging technique, and can be adjusted during the surgical procedure if necessary since retractors of differing lengths and diameters can be made available.

In FIGS. 14a-14b, there is shown another embodiment expandable retractor 220. In FIG. 14a, retractor 220 is in its unexpanded configuration and in FIG. 14b retractor 220 is in its expanded configuration. Retractor 220 is similar in many respects to retractor 20 discussed above. Retractor 220 includes a first portion 222 having a distal end 224, a proximal end 226, and a collar 228 at proximal end 226. Retractor 220 further includes a second portion 242 having a distal end 244, a proximal end 246, and a collar 248 at proximal end 246. First coupling member 230a and second coupling member 230b pivotally couple first portion 222 to second portion 242. A first lever arm 232a is connected with and extends from first coupling member 230a around collar 248, and a second lever arm 232b is connected with and extends from second coupling member 230b around collar 248.

In the unexpanded configuration, lever arms 232a, 232b are adjacent collar 248, and coupling members 230a, 230b project outwardly from collar 228 as shown in FIG. 14a. Coupling members 230a, 230b, as shown in FIG. 13c, have a first keyed portion 237 configured to engage slotted hole 234 of collar 248. The cylindrical portions 239 of coupling members 230a, 230b rotatably reside in the slotted hole (not shown) extending through collar 228 of first portion 222. This allows first portion 222 to be pivoted relative to second portion 242 about coupling members 230a, 230b.

When first portion 222 is pivoted relative to second portion 242 to the expanded configuration, the slotted portions of slotted hole 234 and the slotted hole through collar 228 are aligned. Coupling members 230a, 230b can be pressed inwardly so that a second keyed portion 235 of coupling members 230a, 230b engages the slotted hole formed through collar 228, while the first keyed portion 237 remains engaged in slotted hole 234 of collar 248, thus fixing first portion 222 relative to second portion 242. Lever arms 232a, 232b extend away from collar 248 when first portion 222 is locked relative to second portion 242. To move retractor 220 to the unexpanded configuration, lever arms 232a, 232b are pressed toward collar 248 to move

coupling members 230a, 230b and their second keyed portions 235 out of engagement with the slotted holes in collar 228 of first portion 222. First portion 222 can then pivot toward second portion 242 to collapse retractor 220 for withdrawal from the patient.

In this embodiment, rather than providing an engagement surface along the opposite edges of second portion 242, the keyed engagement of coupling members 230a, 230b and first and second portions 222, 242 locks retractor 220 in its expanded configuration. However, the provision of a grooved portion and engagement surface is not precluded.

Other means for maintaining first and second portions of the retractor in an expanded configuration are also contemplated. For example, in FIGS. 15a-15c another embodiment expandable retractor 120 is shown with a ratchet and pawl type mechanism at the proximal ends of first portion 122 and second portion 142. In this embodiment, rather than providing a grooved portion and engagement surface along the opposite edges of second portion 142, the ratchet and pawl mechanism maintains retractor 120 in its expanded configuration. However, the provision of a grooved portion and engagement surface is not precluded.

First portion 122 includes a collar 128 at its proximal end. Collar 128 includes an extension 134 extending from each side thereof, it being understood that only one side is shown in FIGS. 15a-15c. Similarly, second portion 142 includes an extension 158 extending from each side thereof that is positionable alongside extension 134 of first portion 122, it being understood that only one side is shown in FIGS. 15a-15c. A pin 130 pivotally couples extensions 134, 158 to one another. Extension 134 includes a number of teeth 137 formed at the end thereof that are engageable with ends 156 of pawls 157 extending around collar 148. Pawls 157 are biased into engagement with teeth 137 and moveable relative to collar 148 for disengagement of ends 156 with teeth 137.

When in the unexpanded configuration (not shown) teeth 156 are not engaged by any of the pawls 157. In FIG. 15a, retractor 120 is expanded by pivoting first portion 122 in the direction of arrow R relative to second portion 142 so that lower pawl 157 is biased into engagement with lower tooth 137. In FIG. 15b, first portion 122 is further pivoted in the direction of arrow R relative to second portion 142 to expand retractor 120 with the end 156 of middle pawl 157 in engagement with the middle tooth 137. In FIG. 15c first portion 122 is further pivoted in the direction of arrow R relative to second portion 142 to expand retractor 120 with the end 156 of upper pawl 157 in engagement with the upper tooth 137. It is contemplated that teeth 137 and pawls 157 can be spaced so that retractor 120 is expanded incrementally. In one specific embodiment, the teeth 136 and pawls 157 are spaced so that first portion 122 is pivoted in 5 degree increments relative to second portion 142, ranging from 0 degrees to 15 degrees. Other increments are also contemplated.

FIGS. 16a-16b illustrate another embodiment retractor 320 that is similar to retractor 20 but includes another proximal end configuration. In FIG. 16b, retractor 320 is in its unexpanded configuration and in FIG. 16a retractor 320 is in its expanded configuration. Retractor 320 includes a first portion 322 having a distal end 324, a proximal end 326, and a collar 328 at proximal end 326. Retractor 320 further includes a second portion 342 having a distal end 344, a proximal end 346, and a collar 348 at proximal end 346. First coupling member 330a and second coupling member 330b pivotally couple first portion 322 to second portion 342 about a pivot axis A. Collars 328, 348 have a height that is

less than the height of collars **28, 48** of retractor **20**, reducing the retractor length. Viewing instruments and other instruments can be positioned in, over, and/or attached to retractor **320** as discussed above with respect to retractor **20**.

Collar **328** includes a first extension **334a** extending along one side thereof and above collar **328**, and a second extensions **334b** extending along the other side thereof and above collar **328**. First extension **334a** and second extension **334b** are offset laterally with respect to collar **328** to form recesses for receiving respective ones of the extensions **358a, 358b** of collar **348** therealong so that extensions **358a, 358b** do not protrude into the working channel of retractor **320**. Extensions **358a, 358b** extend above collar **348**. Aligned holes are provided through adjacent extensions **334a, 358a** and adjacent extensions **334b, 358b** to receive coupling members **330a, 330b**. Pivot axis A is thus offset proximally from the proximal ends of collars **328, 348** so that first portion **322** and second portion **342** are expandable through their respective proximal ends to coupling members **330a, 330b**.

Collar **328** includes a first contact surface **335a** below first extension **358a** of collar **348**, and a second contact surface **335b** below second extension **358b** of collar **348**. Collar **348** includes a first lateral extension **356a** that provides a contact surface below first extension **334a** of collar **328**, and an opposite second lateral extension that provides a contact surface below second extension **334b** of collar **328**. With retractor **320** in its unexpanded configuration as shown in FIG. **16b**, a gap is formed between the adjacent extensions and engagement surfaces of collars **328, 348**. When retractor **320** is expanded sufficiently, extensions **334a, 334b** engage respective ones of the contact surfaces of collar **348**, and extensions **358a, 358b** engage respective ones of the contact surfaces of collar **328**, preventing over-expansion of retractor **320**.

While the invention has been illustrated and described in detail in the drawings and foregoing description, the same is to be considered as illustrative and not restrictive in character, it being understood that only the preferred embodiment has been shown and described and that all changes and modifications that come within the spirit of the invention are desired to be protected. For example, certain embodiments contemplate that the first and second portions of the retractor are not provided with proximal end collars. Other embodiments contemplate the first and second portions are not pivotally coupled to one another, but rather to intermediate members extending between the first and second portions along each side of the retractor.

What is claimed is:

1. A retractor for percutaneous surgery in a patient, comprising:

- a first portion having a proximal end and a distal end;
- a second portion having a proximal end coupled to said proximal end of said first portion, said second portion having a distal end and including opposite edges overlapping adjacent edges of said first portion at least adjacent said distal ends to form a working channel, said working channel having a length between said distal ends and said proximal ends of said first and second portions and a size between said first portion and said second portion along said length, wherein:
 - said first and second portions are positionable in an unexpanded configuration with said distal ends of said first and second portions in the patient and said proximal ends of said first and second portions outside the patient; and
 - said first and second portions are movable to an expanded configuration wherein said working channel tapers in

size from said distal ends in the patient to said proximal ends outside the patient and said opposite edges of said second portion overlap adjacent edges at said distal end of said first portion in said expanded configuration.

2. The retractor of claim 1, further comprising an endoscopic viewing instrument extending through said working channel.

3. The retractor of claim 1, further comprising a microscopic viewing instrument over said working channel.

4. The retractor of claim 1, wherein one of said first and second portions includes a bracket extending from said proximal end thereof that is engageable to a flexible arm.

5. The retractor of claim 1, wherein said first portion and said second portion extend completely about said working channel from said proximal ends of said first and second portions to said distal ends of said first and second portions.

6. The retractor of claim 1, further comprising a ratchet and pawl mechanism at said proximal ends of said first and second portions to maintain said first and second portions in said expanded configuration.

7. The retractor of claim 1, further comprising:

a pair of coupling members engaging said first portion to said second portion;

a lever arm extending from respective ones of each of said pair of coupling members; and

said coupling members each have a first position wherein said first portion is pivotal relative to said second portion and are moveable to a second position wherein said coupling members fix said first portion relative to said second portion, said lever arms being moveable to move said coupling members from said second position to said first position.

8. The retractor of claim 1, wherein said first portion is pivotally coupled to said second portion about a pivot axis located proximally of said proximal ends of said first and second portions.

9. The retractor of claim 1, wherein said second portion includes a partial cylindrical body and said first portion includes a partial cylindrical body positioned about said partial cylindrical body of said second portion.

10. The retractor of claim 1, wherein said working channel has a figure eight shape along said length in said expanded configuration.

11. The retractor of claim 10, wherein in said unexpanded configuration said working channel has a generally circular cross-section along said length and in said expanded configuration said working channel has a dimension in said second portion transverse to a primary expansion direction of said first and second portions that is less than a dimension of said working channel in said first portion transverse to said primary expansion direction.

12. The retractor of claim 1, wherein said second portion includes a semi-cylindrical body and said first portion includes a semi-cylindrical body positioned about said semi-cylindrical body of said second portion.

13. The retractor of claim 12, wherein said body of said first portion is flexible.

14. The retractor of claim 12, wherein said body of said first portion includes opposite edges extending therealong between said proximal end and said distal end of said first portion.

15. The retractor of claim 14, wherein said body of said first portion has a perimeter length between said opposite edges, said perimeter length being greater at said distal end of said first portion than at said proximal end of said first portion.

13

16. The retractor of claim 14, wherein said body of said second portion includes opposite edges extending therealong between said proximal end and said distal end, said body of said second portion further including an engagement surface extending along at least a portion of each of said opposite edges thereof.

17. The retractor of claim 16, wherein said opposite edges of said first portion engage adjacent ones of said engagement surfaces of said second portion when in said expanded configuration.

18. The retractor of claim 1, wherein said first portion includes a collar at said proximal end thereof and said second portion includes a collar at said proximal end thereof.

19. The retractor of claim 18, wherein said first portion and said second portion are pivotally coupled to one another at said collars.

20. The retractor of claim 19, wherein:

said collar of said first portion includes first and second extensions extending therefrom on opposite sides of said first portion; and

said collar of said second portion includes first and second recesses therein on opposite sides of said second portion, said first and second extensions positionable in respective ones of said first and second recesses.

21. The retractor of claim 20, wherein said collar of said second portion includes first and second extensions extending along said first and second recesses of said second collar, said first and second extensions of said first portion are each pivotally coupled to an adjacent one of said first and second extensions of said second portion in respective ones of said first and second recesses of said second portion.

22. The retractor of claim 21, wherein said collar of said first portion includes first and second recesses therein adjacent respective ones of said first and second extensions of said first portion, said first and second extensions of said second portion are positionable in respective ones of said first and second recesses of said first portion.

23. The retractor of claim 22, wherein:

said first and second extensions of said first portion each contact an engagement surface in each of said first and second recesses of said second portion in said expanded configuration; and

said first and second extensions of said second portion each contact an engagement surface in each of said first and second recesses of said first portion in said expanded configuration.

24. A retractor for percutaneous surgery in a patient, comprising:

a first portion having opposite edges extending between a proximal end and a distal end;

a second portion coupled to said first portion and having opposite edges extending between a proximal end and a distal end, said second portion including an engagement surface extending along at least a portion of each of said opposite edges thereof, said first and second portions forming a working channel having a length extending between said distal ends and said proximal ends of said first and second portions;

said first and second portions having an unexpanded configuration wherein said edges of said first portion extends around said second portion; and

said first and second portions being pivotal relative to one another about said proximal ends to an expanded configuration wherein said opposite edges of said first portion engage adjacent ones of said engagement surfaces of said second portion.

14

25. The retractor of claim 24, wherein:

said first and second portions are positionable in the patient in said unexpanded configuration with said distal ends of said first and second portions in the patient and said proximal ends of said first and second portions outside the patient; and

said expanded configuration increases a size of said working channel between said first portion and said second portion along said entire length of said working channel.

26. The retractor of claim 24, wherein in said unexpanded configuration said working channel has a generally circular cross-section along said length and in said expanded configuration said working channel has a dimension in said second portion transverse to a pivot direction of said first and second portions that is less than a dimension of said working channel in said first portion transverse to said pivot direction.

27. The retractor of claim 24, wherein said first portion is pivotally coupled to said second portion about a pivot axis located proximally of said proximal ends of said first and second portions.

28. The retractor of claim 24, wherein said second portion includes a semi-cylindrical body and said first portion includes a semi-cylindrical body positioned about said semi-cylindrical body of said second portion.

29. The retractor of claim 28, wherein said body of said first portion is flexible.

30. The retractor of claim 28, wherein said body of said first portion has a perimeter length between said opposite edges, said perimeter length being greater at said distal end of said first portion than at said proximal end of said first portion.

31. The retractor of claim 28, wherein said body of said first portion has a thickness that is less than a thickness of said body of said second portion.

32. The retractor of claim 24, wherein said first portion includes a collar at said proximal end thereof and said second portion includes a collar at said proximal end thereof.

33. The retractor of claim 32, wherein:

said collar of said first portion includes first and second extensions extending therefrom on opposite sides of said first portion; and

said collar of said second portion includes first and second recesses therein on opposite sides of said second portion, said collar of said second portion including first and second extensions along each of said first and second recesses, said first and second extensions of said first portion are positioned in respective ones of said first and second recesses of said second portion and pivotally engaged to first and second extensions of said second portion.

34. The retractor of claim 33, wherein said collar of said first portion includes first and second recesses along said first and second extensions thereof, said first and second extensions of said second portion are each positioned in respective ones of said first and second recesses of said first portion.

35. The retractor of claim 34, wherein:

said first and second extensions of said first portion each contact an engagement surface in each of said first and second recesses of said second portion in said expanded configuration; and

said first and second extensions of said second portion each contact an engagement surface in each of said first and second recesses of said first portion in said expanded configuration.

15

36. A retractor for percutaneous surgery in a patient, comprising:

a first portion extending between a proximal end and a distal end, said first portion including a collar extending about said proximal end; and

a second portion extending between a proximal end and a distal end, said second portion including a collar extending about said proximal end, said first and second portions forming a working channel having a length extending between said distal ends and said proximal ends of said first and second portions and a size between said first and second portions, wherein said collar of said first portion is pivotally coupled to said collar of said second portion and said first and second portions are pivotal relative to one another between an unexpanded configuration and an expanded configuration and in at least said unexpanded configuration said first portion overlaps said second portion between said proximal and distal ends to enclose said working channel along said first and second portions.

37. The retractor of claim 36, wherein:

said first and second portions are positionable in said unexpanded configuration with said distal ends of said first and second portions in the patient and said proximal ends of said first and second portions outside the patient; and

said expanded configuration increases said size of said working channel between said first portion and said second portion from said proximal ends of said first and second portions to said distal ends of said first and second portions.

38. The retractor of claim 36, further comprising a viewing element selected from the group comprising: an endoscopic viewing instrument and a microscopic viewing instrument.

39. The retractor of claim 36, wherein said first portion includes opposite edges extending therealong between said proximal end and said distal end.

40. The retractor of claim 36, wherein said second portion includes a partial cylindrical body and said first portion includes a partial cylindrical body positioned about said partial cylindrical body of said second portion.

41. The retractor of claim 36, wherein said second portion includes a semi-cylindrical body and said first portion includes a semi-cylindrical body positioned about said semi-cylindrical body of said second portion.

42. The retractor of claim 41, wherein said body of said first portion is flexible.

43. The retractor of claim 41, wherein:

said body of said first portion has a perimeter length between opposite edges thereof that is greater at said distal end of said first portion than at said proximal end of said second portion; and

said body of said second portion has a perimeter length between opposite edges thereof that is generally the same at said distal end and said proximal end of said second portion.

44. The retractor of claim 36, wherein said collar of first portion is pivotally coupled to said collar of said second portion about a pivot axis located proximally of said proximal ends of said first and second portions.

45. The retractor of claim 44, wherein:

said collar of said first portion includes first and second extensions extending therefrom on opposite sides of said first portion; and

said collar of said second portion includes first and second recesses therein on opposite sides of said second por-

16

tion, said collar of said second portion including first and second extensions along each of said first and second recesses, said first and second extensions of said first portion are positioned in respective ones of said first and second recesses of said second portion and pivotally engaged to first and second extensions of said second portion.

46. The retractor of claim 45, wherein said collar of said first portion includes first and second recesses along said first and second extensions thereof, said first and second extensions of said second portion are each positioned in respective ones of said first and second recesses of said first portion.

47. The retractor of claim 46, wherein:

said first and second extensions of said first portion each contact an engagement surface in each of said first and second recesses of said second portion in said expanded configuration; and

said first and second extensions of said second portion each contact an engagement surface in each of said first and second recesses of said first portion in said expanded configuration.

48. A retractor for percutaneous surgery in a patient, comprising:

a first portion extending between a proximal end and a distal end, said first portion including a collar extending about said proximal end; and

a second portion extending between a proximal end and a distal end, said second portion including a collar extending about said proximal end, said first and second portions forming a working channel having a length extending between said distal ends and said proximal ends of said first and second portions and a size between said first and second portions, wherein said collar of said first portion is pivotally coupled to said collar of said second portion and said first and second portions are pivotal relative to one another between an unexpanded configuration and an expanded configuration, wherein in said unexpanded configuration said working channel includes a generally circular cross-section along said length and in said expanded configuration said working channel has a dimension in said second portion transverse to a pivot direction of said first and second portions that is less than a dimension in said first portion transverse to said pivot direction.

49. A retractor for percutaneous surgery in a patient, comprising:

a first portion extending between a proximal end and a distal end, said first portion including a collar extending about said proximal end; and

a second portion extending between a proximal end and a distal end, said second portion including a collar extending about said proximal end, said first and second portions forming a working channel having a length extending between said distal ends and said proximal ends of said first and second portions and a size between said first and second portions, wherein said collar of said first portion is pivotally coupled to said collar of said second portion and said first and second portions are pivotal relative to one another between an unexpanded configuration and an expanded configuration, wherein said first portion includes opposite edges extending therealong between said proximal end and said distal end and said first portion has a perimeter length between said opposite edges, said perimeter length being greater at said distal end of said first portion than at said proximal end of said second portion.

17

50. A retractor for percutaneous surgery in a patient, comprising:

a first portion extending between a proximal end and a distal end, said first portion including a collar extending about said proximal end; and

a second portion extending between a proximal end and a distal end, said second portion including a collar extending about said proximal end, said first and second portions forming a working channel having a length extending between said distal ends and said proximal ends of said first and second portions and a size between said first and second portions, wherein said collar of said first portion is pivotally coupled to said collar of said second portion and said first and second portions are pivotal relative to one another between an unexpanded configuration and an expanded configuration, wherein said first portion includes opposite edges extending therealong between said proximal end and said distal end and said second portion includes opposite edges extending therealong between said proximal end and said distal end, said second portion further including an engagement surface extending along at least a portion of each of said opposite edges thereof, *said second portion being positioned between said opposite edges of said first portion when said first and second portions are in said expanded configuration.*

51. The retractor of claim 50, wherein said opposite edges of said first portion engage adjacent ones of said engagement surfaces of said second portion when said first and second portions are in said expanded configuration.

52. A method for performing a surgical procedure at a location in a patient, comprising:

making an incision in the skin and tissue of the patient to access the location;

forming a working channel through the incision to the location by sequentially dilating tissue and inserting a distal end of a retractor into the patient with a proximal end of the retractor located outside of the patient; and pivoting a first portion of the retractor relative to a second portion of the retractor about a pivot axis adjacent the proximal end of the retractor *such that edges of the second portion overlap edges of the first portion* to expand the working channel through the incision.

53. The method of claim 52, further comprising: mounting an expansion instrument on the proximal end of the retractor before pivoting the first portion relative to the second portion.

54. The method of claim 52, further comprising: positioning a viewing element to view the location through the retractor.

55. The method of claim 52, wherein forming the working channel includes sequentially dilating skin and tissue through the incision before inserting the distal end of the retractor.

56. The method of claim 52, wherein the pivot axis is located proximally of the proximal end of the retractor.

57. The method of claim 56, wherein the retractor defines a working channel therethrough that is substantially enclosed by the retractor.

58. The method of claim 56, wherein the retractor is expanded by pivoting a first portion of the retractor relative to a second portion of the retractor about a pivot axis adjacent the proximal end of the retractor.

59. The method of claim 56, wherein the location is adjacent the spinal column of the patient.

18

60. A surgical method for accessing a location in a patient, comprising:

sequentially dilating tissue of the patient to the location; placing an unexpanded retractor through the sequentially dilated tissue;

expanding the retractor predominantly in a first direction through the tissue *by pivoting a first portion of the retractor relative to a second portion of the retractor about a pivot axis such that edges of the second portion overlap edges of the first portion*; and performing a surgical procedure through the expanded retractor.

61. A surgical method for accessing a location in a patient, comprising:

placing an unexpanded retractor through sequentially dilated tissue to the location;

expanding the retractor to an expanded configuration *by pivoting a first portion of the retractor relative to a second portion of the retractor about a pivot axis such that edges of the second portion overlap edges of the first portion*;

unexpanding the retractor before removing the retractor; and

removing the retractor from the patient.

62. The method of claim 61, further comprising locking the retractor in the expanded configuration.

63. The method of claim 62, further comprising unlocking the retractor before unexpanding the retractor.

64. The method of claim 61, wherein the retractor is expanded by pivoting a first portion of the retractor relative to a second portion of the retractor about a pivot axis adjacent a proximal end of the retractor.

65. The method of claim 64, wherein the pivot axis is located proximally of the proximal end of the retractor.

66. A tissue retractor for surgery in a patient, comprising: a first portion and a second portion coupled to said first portion, said first and second portions each having a length *extending along a longitudinal axis* between a distal end and a proximal end thereof such that said proximal ends are positionable outside the patient and said distal ends are positionable in the patient, *said first portion being pivotable relative to said second portion about a pivot axis that extends transverse to said longitudinal axes*;

a working channel extending therealong between said distal ends and said proximal ends of said first and second portions; and

said first and second portions have an unexpanded configuration wherein said working channel has a generally circular cross-section and an expanded configuration wherein said working channel has a non-circular cross-section tapering from said distal end to said proximal end, wherein said first portion substantially envelopes said second portion in said unexpanded configuration.

67. The retractor of claim 66, wherein said first and second portions are locked in said expanded configuration.

68. The retractor of claim 66, wherein said first portion has a flexible body.

69. The retractor of claim 66, wherein said first portion is pivotally coupled to said second portion at said proximal ends thereof.

70. The retractor of claim 66, wherein said [first portion is pivotally coupled to said second portion along a] pivot axis is located proximally of said proximal ends of said first portion and said second portion.

71. A tissue retractor for surgery in a patient, comprising:
a first portion and a second portion coupled to said first
portion, said first and second portions each having a
length *extending along a longitudinal axis* between a
distal end and a proximal end thereof such that said
proximal ends are positionable outside the patient and
said distal ends are positionable in the patient, *said first
portion being pivotable relative to said second portion
about a pivot axis that extends transverse to said
longitudinal axes;*
a working channel extending therealong between said
distal ends and said proximal ends of said first and
second portions; and
said first and second portions have an unexpanded con-
figuration wherein said working channel has a gener-
ally circular cross-section and an expanded configura-
tion wherein said working channel has a non-circular
cross-section tapering from said distal end to said
proximal end, wherein said second portion includes a
partial cylindrical body and said first portion includes a
partial cylindrical body positioned about said partial
cylindrical body of said second portion.

* * * * *