



US00D870271S

(12) **United States Design Patent**
Kheradpir et al.

(10) **Patent No.:** **US D870,271 S**
(45) **Date of Patent:** **** Dec. 17, 2019**

- (54) **SHUNT STYLET**
- (71) Applicant: **SYNAPTIVE MEDICAL (BARBADOS) INC.**, Bridgetown (BB)
- (72) Inventors: **Leila Kheradpir**, Toronto (CA); **Kyle Richard Dupont**, Toronto (CA); **Jakub Jankowski**, Toronto (CA); **Manish Ahuja**, Toronto (CA); **Jessica Phillips**, Toronto (CA); **Charles Houssiere**, Toronto (CA); **Ashok Gowda**, Toronto (CA)
- (73) Assignee: **SYNAPTIVE MEDICAL (BARBADOS) INC.**, Bridgetown (BB)

6,599,237	B1 *	7/2003	Singh	A61B 1/0008
				600/114
D629,515	S *	12/2010	Laurence	D24/130
D643,921	S *	8/2011	Davila	D24/133
8,147,452	B2 *	4/2012	Nardeo	A61M 25/0014
				604/161
D679,803	S *	4/2013	Carter	D24/112
8,753,313	B2 *	6/2014	Kimmel	A61M 25/0043
				604/161
D720,847	S	1/2015	Mladenovic et al.	
8,998,883	B1 *	4/2015	Feloney	A61M 25/0017
				604/540
D779,432	S *	2/2017	Wong	D10/97
D788,908	S *	6/2017	Abusaif	D24/112
D800,583	S *	10/2017	Ahong	D10/52
D818,576	S *	5/2018	Melendez	D24/119

(**) Term: **15 Years**

* cited by examiner

Primary Examiner — David G Muller

(21) Appl. No.: **29/621,600**

(74) *Attorney, Agent, or Firm* — Perry + Currier Inc.

(22) Filed: **Oct. 10, 2017**

(51) **LOC (12) Cl.** **24-02**

(52) **U.S. Cl.**

USPC **D24/112**

(58) **Field of Classification Search**
 USPC D24/112–114, 108, 130, 127, 133, 186;
 606/181, 185; 604/264, 523–528, 272,
 604/164.01–164.11, 187, 93.01; 600/101,
 600/139, 143; 128/200.24, 207.14,
 128/207.15
 CPC .. A61M 25/065; A61M 5/42; A61M 25/0612;
 A61M 25/00; A61M 39/00; A61M 27/00;
 A61M 25/0043; A61M 25/0067; A61M
 25/0097; A61F 2/958
 See application file for complete search history.

(56) **References Cited**

U.S. PATENT DOCUMENTS

D381,420	S *	7/1997	Musgrave	D24/108
D450,839	S *	11/2001	Junker	D24/130

(57) **CLAIM**

We claim the ornamental design for a shunt stylet, as shown and described.

DESCRIPTION

FIG. 1 is a front perspective view of a suction tool, showing our new design;
 FIG. 2 is a back perspective view thereof;
 FIG. 3 is a front elevation view thereof;
 FIG. 4 is a back elevation view thereof;
 FIG. 5 is a top plan view thereof;
 FIG. 6 is a bottom plan view thereof;
 FIG. 7 is a right side elevation view thereof; and,
 FIG. 8 is a left side elevation view thereof.

1 Claim, 6 Drawing Sheets



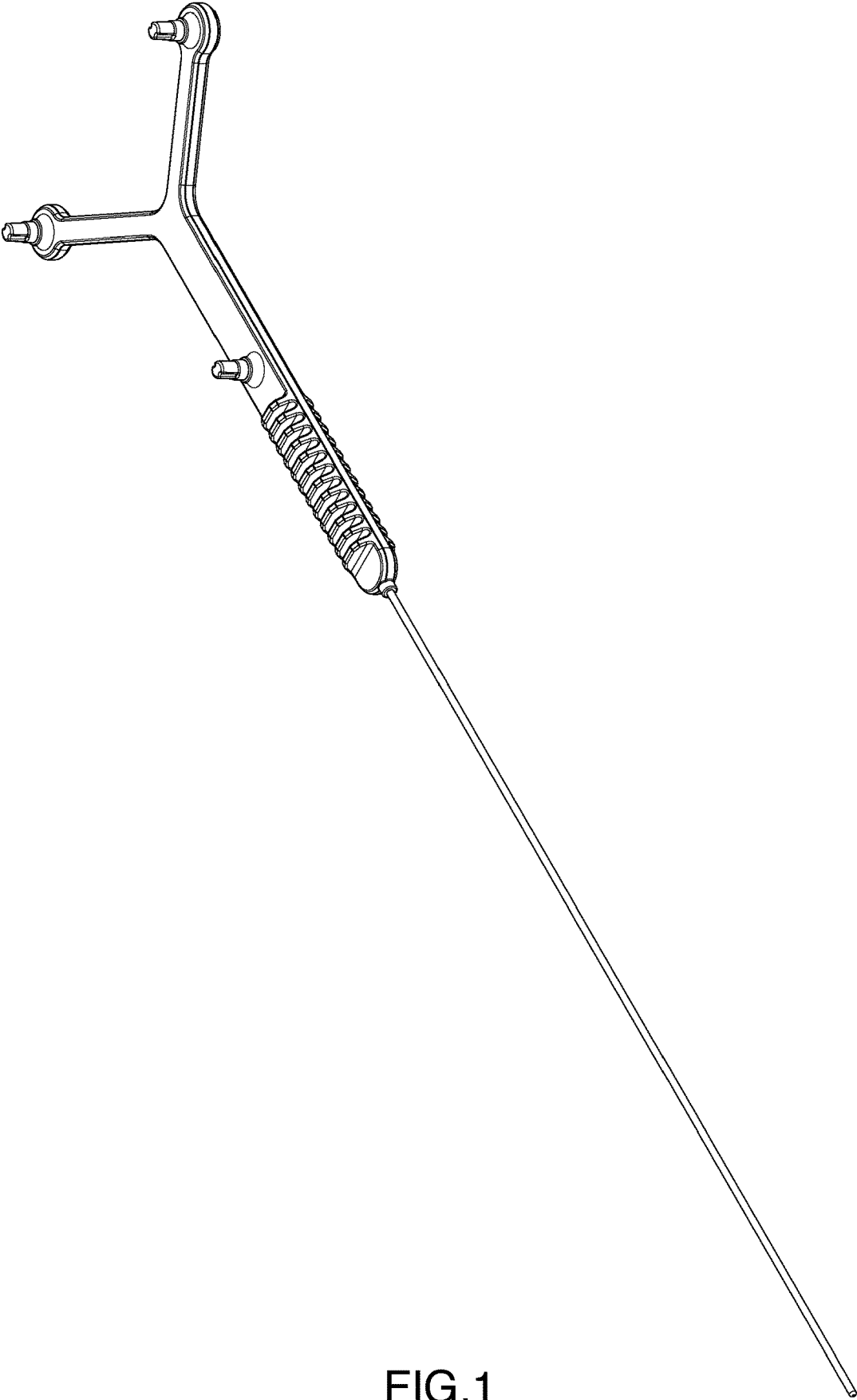

FIG.1



FIG. 2

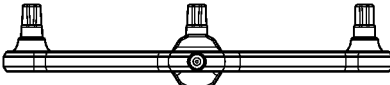

FIG. 3



FIG. 4

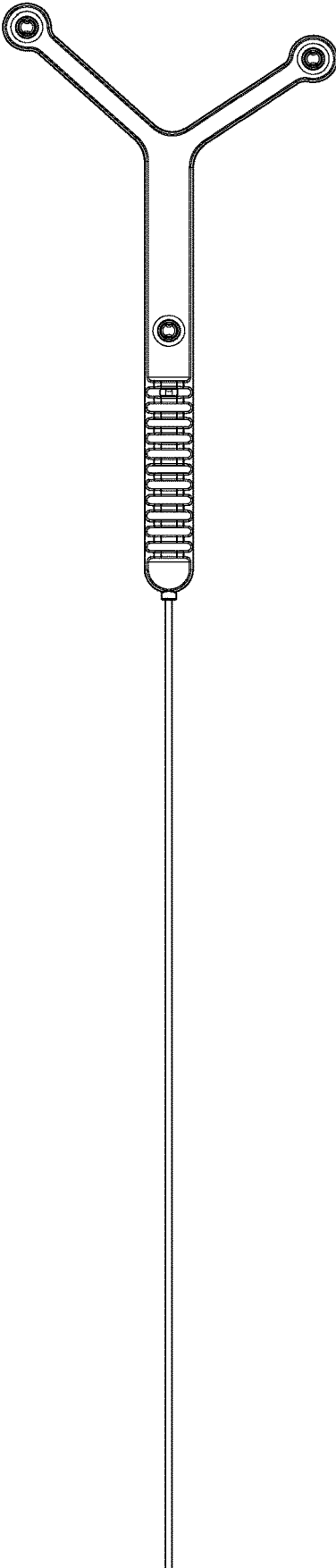

FIG. 5

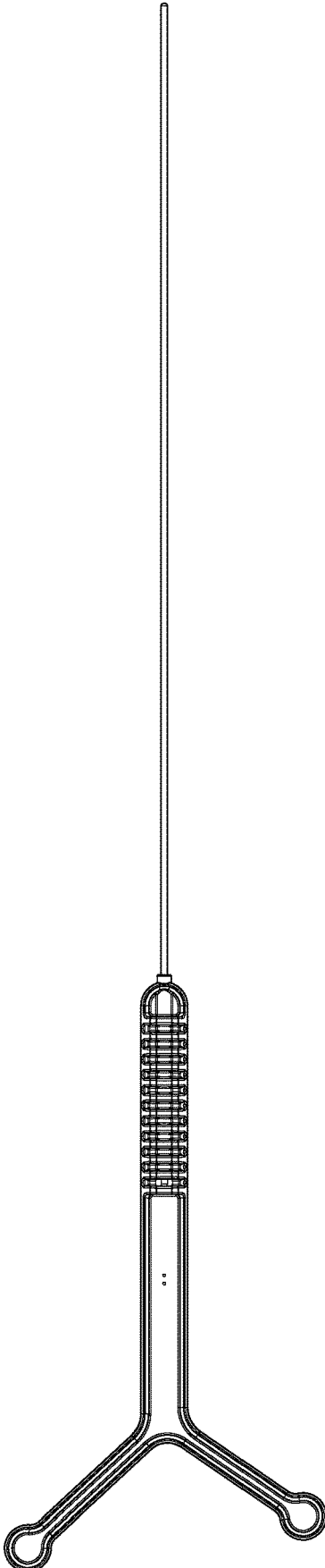

FIG.6

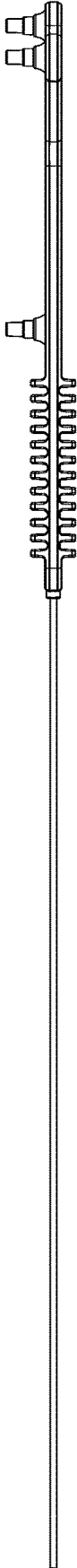

FIG. 7

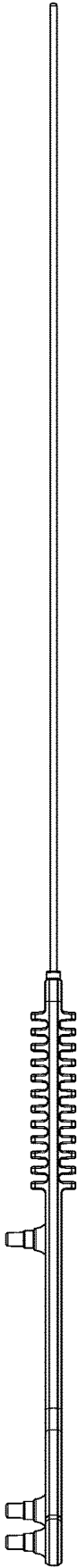

FIG. 8