

No. 867,428.

PATENTED OCT. 1, 1907.

A. E. SHROY.
SAW SUPPORT FOR UNDERCUTTING.
APPLICATION FILED MAY 2, 1907.

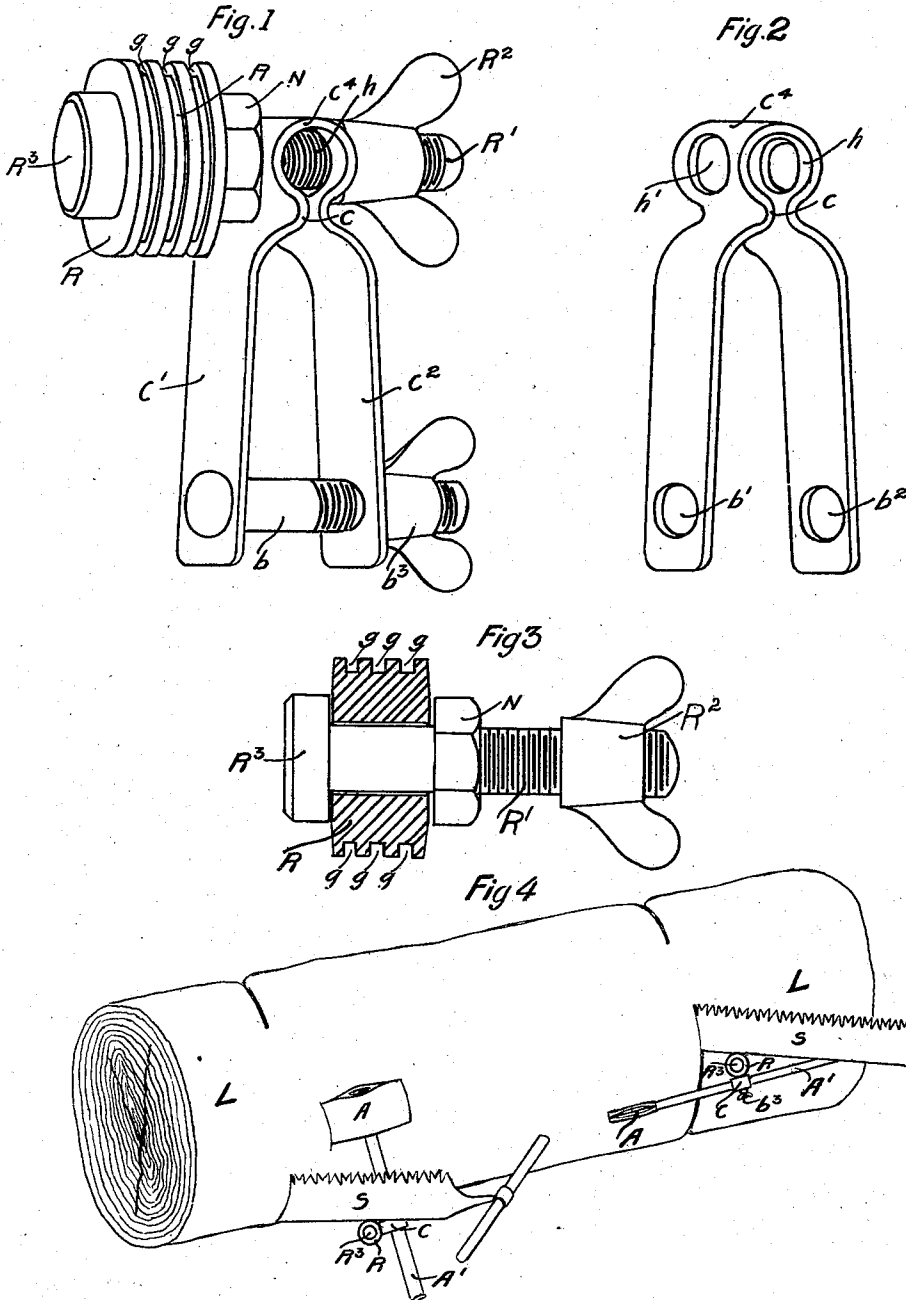

Witnesses

A. K. Hoff
R. B. Foster

Inventor

Angus E. Shroy

UNITED STATES PATENT OFFICE.

ANGUS E. SHROY, OF LA CENTER, WASHINGTON.

SAW-SUPPORT FOR UNDERCUTTING.

No. 867,428.

Specification of Letters Patent.

Patented Oct. 1, 1907.

Application filed May 2, 1907. Serial No. 371,539.

To all whom it may concern:

Be it known that I, ANGUS E. SHROY, a citizen of the United States, residing at La Center, in the county of Clarke and State of Washington, have invented a new and useful Improvement in Saw-Supports for Undercutting, of which the following is a specification, reference being had to the accompanying drawings.

My invention relates to improvements in supports for saws when in use for cutting a felled log from beneath.

It has for its object to provide means for guiding and supporting the saw blade in proper position which can be easily and quickly applied by the workman in connection with his ax.

The invention consists in the features of construction and combinations of parts hereinafter described and specified in the claims.

In the accompanying drawing illustrating the preferred embodiment of my invention: Figure 1 is a perspective view of the clamp and roller attachment. Fig. 2 is a perspective view of the clamp alone. Fig. 3 is a detailed view of the roller carrying pin or bolt, showing the roller in section, and Fig. 4 shows the clamp applied for use.

Referring more particularly to the drawings, C designates the clamp which is preferably made of a strip of resilient metal bent as shown to form arms C¹ and C² and a head C⁴. The arms of the clamp are adapted to grip the handle A¹ of the ax A by means of the bolt b passed through holes b¹ and b² in the ends of said arms and carrying a thumb nut b³. The head of said clamp is bent to form a loop h which is substantially circular in cross section and adapted to receive the bolt or pin R¹ carrying the roller R between its head and a nut N. Said bolt R¹ is secured in place by means of a thumb nut R². The opposite sides of said loop h are provided with openings or passages h¹ also adapted to receive the bolt or pin R¹. It will thus be seen that said bolt may be arranged either in line with said

clamp or at right angles thereto to suit different requirements as the log L is being cut through as illustrated in Fig. 4.

The roller R should revolve freely on the unthreaded portion of the bolt R¹. Said roller has a series of square grooves g in its outer surface, in any one of which the rear edge of the saw S (Fig. 4) is adapted to run. The grooves should be wide and deep enough to permit the back of the saw to slide easily therein when operated.

At the left hand side of Fig. 4, the ax is driven into the log in a vertical position and the bolt R¹ is passed through the openings h¹ of the head of the clamp.

At the right hand side of Fig. 4, the ax is driven into the log in a horizontal position and the bolt R¹ is passed through the loop h.

The clamp is of course adjustable on the ax handle to allow the saw sufficient play when resting in one of the grooves.

I claim:

1. A clamp of the character described, adapted to be fastened upon a support, said clamp having resilient arms and a head provided with passages arranged at right angles to each other, a clamping bolt passed through perforations in the ends of said arms, a bolt adapted to be passed through and rigidly secured in either of said passages in said head, and a grooved roller mounted freely on said bolt and adapted to hold and guide a saw for undercutting.

2. A clamp of the character described, adapted to be fastened upon a support, said clamp comprising a strip of resilient metal bent to form arms and a looped head having openings or passages through the opposite sides thereof, a bolt adapted to be passed through and secured either in said loop or in said passages, and a grooved roller mounted freely on said bolt and adapted to hold and guide a saw for under cutting.

In testimony whereof I have signed my name to this specification in the presence of two subscribing witnesses.

ANGUS E. SHROY.

Witnesses:

A. OHLHOFF,
R. RUETTER.