

Oct. 9, 1934.

W. C. POETSCH

1,976,034

TABLE WITH ADJUSTABLE RACK

Filed Aug. 6, 1932

3 Sheets-Sheet 1

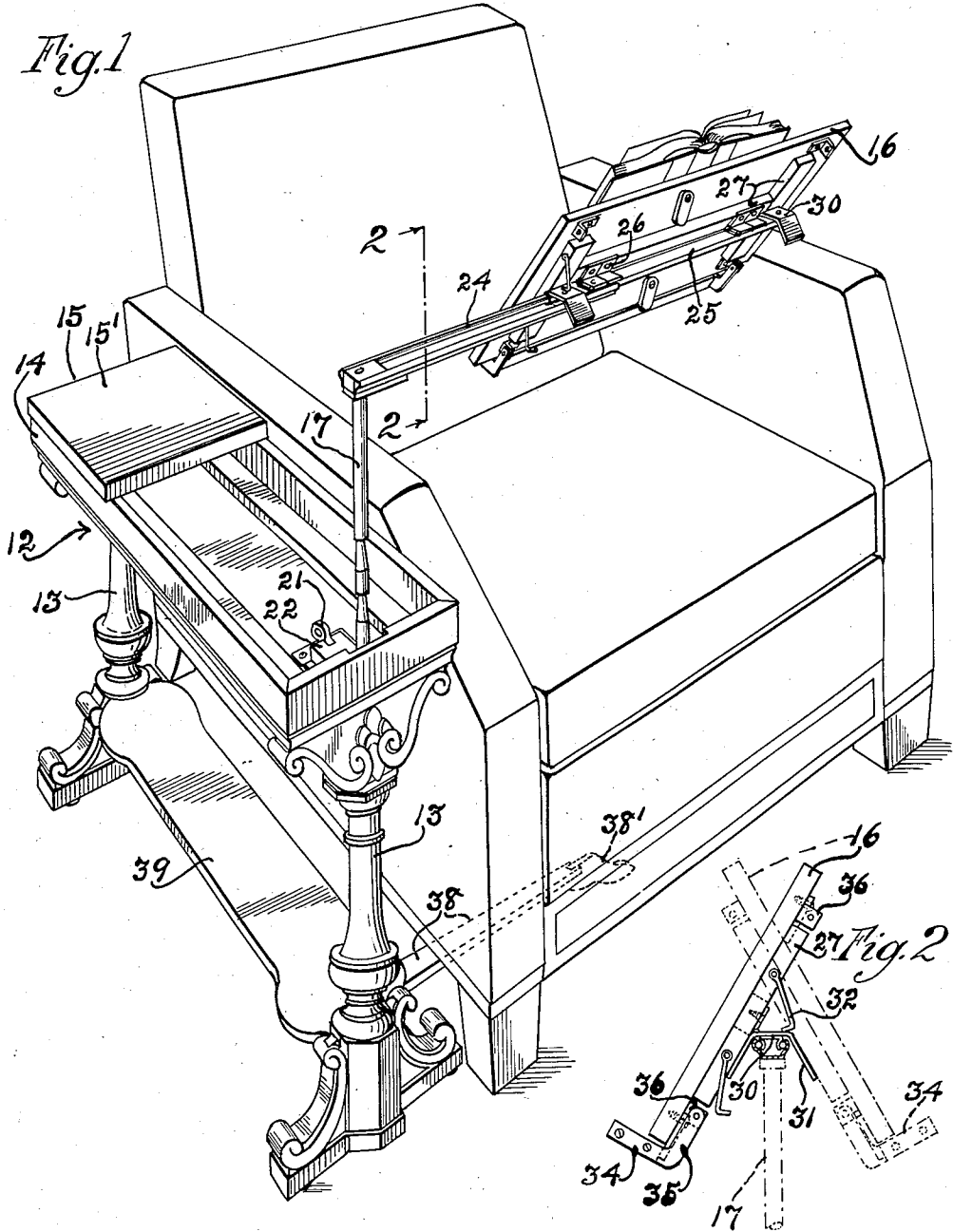

Inventor
William C. Poetsch
by J. Daniel Stawe
Attorney.

Oct. 9, 1934.

W. C. POETSCH

1,976,034

TABLE WITH ADJUSTABLE RACK

Filed Aug. 6, 1932

3 Sheets-Sheet 3

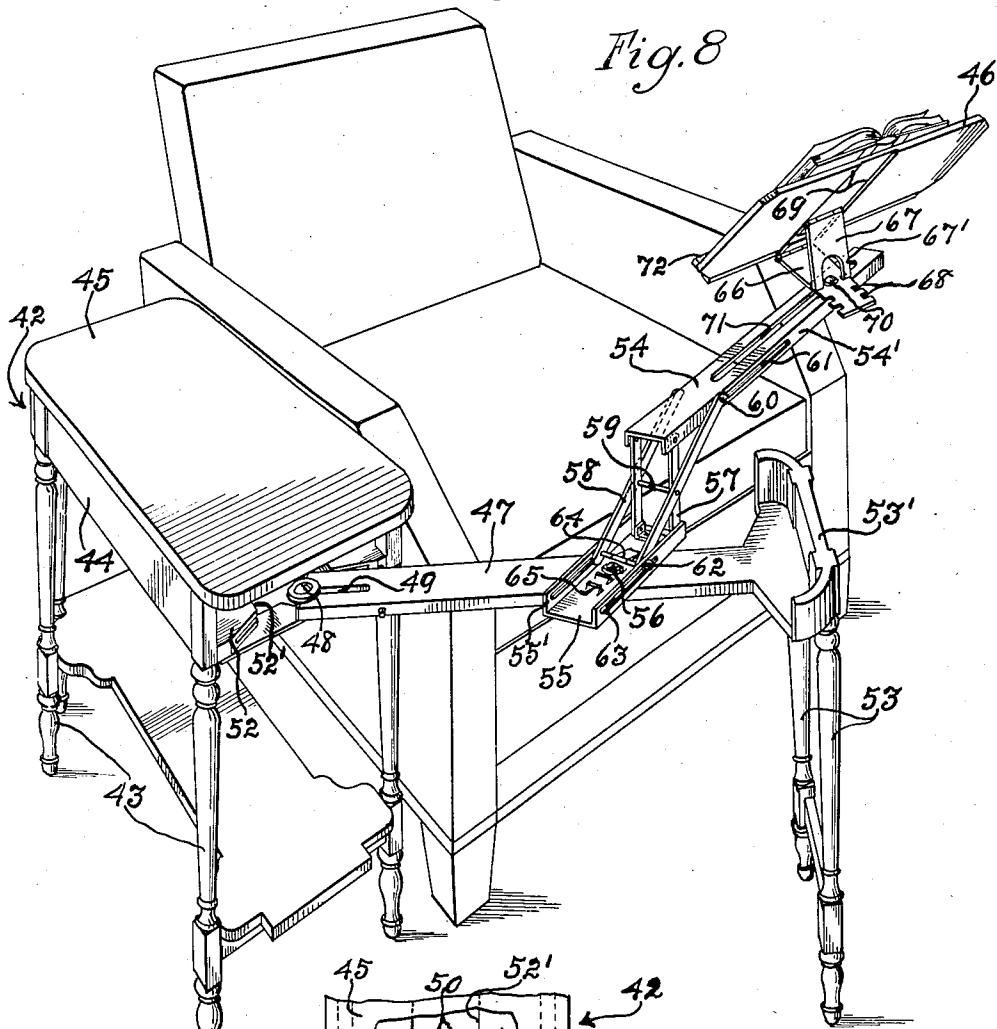

Fig. 8

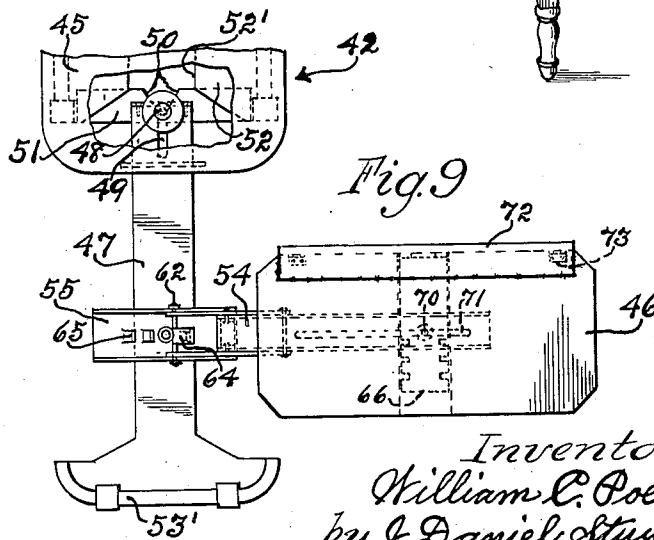

Fig. 9

Inventor
William C. Poetsch
by J. Daniel Stuewe
Attorney.

UNITED STATES PATENT OFFICE

1,976,034

TABLE WITH ADJUSTABLE RACK

William C. Poetsch, Chicago, Ill.

Application August 6, 1932, Serial No. 627,686

19 Claims. (Cl. 45—60)

This invention relates to a table with adjustable rack.

The main object of this invention is to provide a supporting device of great utility, which is adapted to be used, alongside a chair, sofa, bed, etc., and is preferably in the form of a table provided with an adjustable supporting member or rack thereon which may be placed in various positions, so as to fully adapt the device for many different purposes, such as reading, writing, sewing, card playing, at the bedside, and the like.

Another object is to provide a table having a supporting rack mounted thereon to be concealed thereby when folded, and which is swingable and adjustable vertically, and is tiltable for use as a book rest, reading rack, sheet music holder, or sketching board, etc., or which may be positioned horizontally for use as a stand or table for card playing, sewing, writing, bedside table, and the like.

These and various other objects and advantages will become apparent from the following description, taken in connection with the accompanying drawings, in which the invention is shown in its preferred forms, it being understood that various other arrangements and forms of construction may be resorted to for carrying out the objects and purposes of this invention.

In the drawings:

Fig. 1 is a perspective view of my invention in its preferred form of construction, showing the table alongside a chair and the rack tilted for supporting a book in front of the chair.

Fig. 2 is an enlarged vertical sectional view, taken along line 2—2 of Fig. 1.

Fig. 3 is a longitudinal vertical sectional view, showing the rack in the concealed inoperative position.

Fig. 4 is a vertical cross-sectional view, taken along line 4—4 of Fig. 3.

Fig. 5 is a partial sectional view, showing the rack elevated and horizontal.

Fig. 6 is a vertical cross-sectional view, taken along line 6—6 of Fig. 5.

Fig. 7 is an enlarged sectional view on line 7—7 of Fig. 5.

Fig. 8 is a perspective view of a modified form of my invention, shown in a position similar to Fig. 1.

Fig. 9 is a partial plan view of this form.

In the drawings I have illustrated my invention in two of its various forms of construction, each essentially constituting a supporting device of multiple utility including a supporting table which is adapted to serve as a side table and which has an auxiliary supporting member or supporting rack adjustably mounted thereon so as to be normally concealed by the table when not in use, and to be tiltable, swingable and ex-

tensible from the table to serve as a reading rack, sheet music holder, sewing or writing desk, and the like, while the table is utilized adjacent a chair or seat, and which is also adapted to be used as a bedside rack or tray at the sickbed, whilst the table is used as an ordinary side table alongside the bed.

The form of construction illustrated in Figs. 1 to 7 inclusive comprises a table 12 including a pair of legs 13 supporting thereon a housing 14 with a top member or top board 15 provided thereupon. A portion 15' of this top member is secured on the housing 14, while a portion 16 is movably mounted on the housing and is adapted to function as an auxiliary supporting member or supporting rack.

The means provided for adjustably supporting this rack portion 16 on the table comprises a rod or shaft 17 which is slidable in a channel 18 formed in one of the legs 13. The shaft is held for vertical adjustment in said channel and leg, as for example, by providing reduced portions 19 on the shaft to form several shoulders 20 adapted to rest upon a spring-pressed catch 21 mounted with a casing 22 in housing 14, whereby said shaft is held in the selected vertical position. A horizontal supporting member or arm 24 is mounted on the upper end of shaft 17 and has an inner bar or arm part 25 telescoping or slidably mounted on the main portion, so that this arm is extendible and adjustable for length and may be contracted to conceal it within housing 14. The top portion or rack 16 is movably mounted on this arm, this being preferably done by the use of a pair of double acting friction hinges 26 which have one leaf attached to arm part 25 and the other leaf to reinforcing means 27 under rack 16. Said construction enables rack 16 to be slid or moved with portion 25 longitudinally on the main arm portion 24 for placing the rack in the desired position outward of the table.

The rack or supporting member 16 is also mounted to be held either horizontally or tilted on said arm, and for this purpose the arm portion 25 is preferably provided with supporting plates 30 each having a horizontal top and ends 31 slanting downwardly and outwardly therefrom and from the arm at a suitable angle, so that the rack may be firmly supported on said bent ends in a considerably tilted position, as shown in Fig. 2, and due to the friction hinges it may also be supported in various less tilted positions if desired. The rack is adapted to be supported in a horizontal position upon said horizontal top portions of members 30, and hooks 32 are further provided on the rack to engage under the lower edges of bent ends 31, as best shown in Fig. 6, to positively hold the rack in its horizontal position.

This rack is thus adapted to be used horizontally as a stand or table for playing cards, sewing, writing, and the like, as shown in Figs. 5 and 6; and it is likewise adapted to be tilted at several angles and to be securely held in the lower tilted position, as shown in Fig. 21, to serve as a reading rack, sheet music holder, artist's sketching board, and the like, and for this purpose a ledge or supporting strip 34 is mounted at the lower edge of the rack, preferably by the use of angle bars 35 which are pivoted to lugs 36 under the rack. The ledge 34 is thus swingable underneath the rack when the rack is to be folded in housing 14, and it is movable to the lower edge of the rack to serve as a supporting ledge. A set of lugs 36 is provided adjacent each side edge of the rack, so that ledge 34 with angle members 35 may be secured to either set of lugs for use at either side of the board desired.

For the purpose of providing sufficient support for the table when the rack is fully extended an additional supporting leg 38 with a foot 38' is mounted under the lower supporting shelf 39 provided on the table, so that said leg and foot are swingable outwardly into the supporting position, the same being readily movable out of the way under a chair and the like, as indicated in Fig. 1, and being likewise movable into a concealed position underneath shelf 39, as indicated in Fig. 3 of the drawings.

In Figs. 8 and 9 of the drawings I have shown my invention in a modified form of construction which comprises a table 42 including legs 43 supporting an upper frame or housing 44 with a top member 45 thereon, and an auxiliary supporting member or supporting rack 46 is adjustably mounted on the table, so as to be concealed by the frame 44 and top 45 while in its folded or inoperative position.

The means provided for adjustably supporting rack 46 on the table in this form of construction comprises a bar 47 swingable on a bolt or pivot pin 48 which is mounted with its upper part in a slot 49 provided at the inner end of said bar, and which is engageable with its lower part in a notch 50 cut in a cross-bar 51 at the end of the table whenever said bar is fully extended or withdrawn from its guide slot 52' provided in the lower wall means 52 of frame 44. A pair of legs 53 and end board 53' supports the outer end of said bar. A horizontal arm 54 is adjustably mounted on bar 47, so as to be elevated and swung thereon and this is preferably accomplished by the use of a plate 55 swingably mounted on bar 47 with a pin 56, and a pair of supporting links 57 connect arm 54 with plate 55. Diagonal links 58 are pivotally connected by a pin 59 to links 57 and have their upper ends connected by a pin 60 which is slidable in slots 61 provided in depending flanges 54' on arm 54. The lower ends of links 58 are connected by a pin 62 which is slidable in slots 63 provided in upturned flanges 55' on plate 55. A latch 64 on pin 62 has its downturned end engaging one of a series of lips 65 which are struck up from plate 55, for holding arm 54 adjustably in the desired vertical position.

The supporting rack 46 is adjustably and tiltably mounted on horizontal arm 54 by means of a plate 66 hinged on its lower edge and a plate 67 hinged on the intermediate part of said rack, while spaced fingers 67' on plate 67 are selectively placeable in either pair of a set of notches 68 provided in plate 66, whereby the rack may be set at the desired tilt or angle on said arm. Plate

67 may also be rested in groove 69 on the under side of the rack and said rack rested in a horizontal position upon plate 66. A bolt 70 extends through plate 66 and through a slot 71 provided in arm 54, for securing the rack in the adjusted position longitudinally of said arm.

In order to adapt this rack for a reading and a sketching rack a ledge 72 is mounted with hinge means 73 on the lower edge of the rack, to engage the lower part of a book, paper, etc., so that the same will be properly supported on the rack when in the tilted position, said ledge being foldable on top of the rack, as indicated in Fig. 9, for moving the rack and supporting elements in the concealed position under the table top.

I claim as my invention:

1. A device comprising a table adapted for use alongside a chair and including fixed top board means constantly adapted to support articles, a supporting rack mounted on the table to be folded thereon in its inoperative position, a member and means for securing the rack tiltable in opposite directions thereon, and means for mounting said member on the table, said member being swingable on the table about a substantially vertical axis and being extendible from the table, whereby said rack is adjustably supportable in various operative positions in front of the chair and the table is adapted to be placed at either side of the chair.

2. A table adapted for use alongside a chair, a supporting rack mounted on the table to be folded thereon in its inoperative position, a member and means for mounting it on the table so that it is swingable on the table about a substantially vertical axis and is extendible from the table, and means for mounting said rack horizontally and also tiltable in opposite directions of said member, whereby to adjustably support said rack in various operative positions and at different sides of the table, so that the latter is adapted to be used at either side of the chair.

3. A device comprising a table including table top means which is constantly stationary for supporting articles, a supporting rack, a horizontal member and a member connected therewith and with the table for supporting the horizontal member swingable and vertically adjustable on the table, means for mounting said rack tiltable and adjustable longitudinally of said horizontal member, and ledge means adapted to be mounted on either side of the rack, whereby said rack is adapted to be extended for use from various sides of the table.

4. A device comprising a table and a rack, a member extendible from and normally concealed by the table, a horizontally extending arm supported on said member and being adjustable vertically, and means movable longitudinally of the arm for adjustably supporting said rack on said arm to be tiltable thereon in opposite directions and also adjustable longitudinally thereof.

5. A device comprising a table including a movable top portion, means on the table normally concealed by said top portion when closed and being adapted for supporting said portion raised and extended from the table to serve as an elevated supporting rack, and a supporting ledge at one edge of said rack and foldable thereunder.

6. A device comprising a table having its top member divided into a stationary supporting portion and a movable top portion, and means adapted to be normally concealed by said two portions and the table and to be movable from the table

for adjustably elevating and for swinging said movable portion beyond the table top and to either side or end thereof to serve as a supporting member.

5 7. A table having its top member divided into a stationary supporting portion and a portion movable in various directions therefrom, a supporting leg, a shaft slidable in said leg and supported thereon for vertical adjustment, an adjustable arm supported on said shaft, and means for supporting said movable top portion in various positions on said arm to serve as a supporting rack placeable in the various directions from the table top.

10 8. A table having a movable top portion and a supporting leg, a shaft supported on said leg and adjustable vertically thereon, an arm adjustably supported on said shaft and adapted to be swung therewith on the table, means for supporting said top portion on said arm in either a horizontal or in oppositely tilted positions, and a ledge and means for mounting it on either side of said portion to provide a reading rack.

15 9. A device comprising a table including a lower supporting shelf, also a top having a part thereof in the shape of a movable board, an arm and means for swingably mounting it on the table and adapted to be normally concealed by said top, a leg under said shelf movable laterally thereof as a brace, and means for adjustably mounting said board on said arm to be selectively supported in various elevated positions.

20 10. A device comprising a table and a rack, a member extendible and adjustable vertically from the table, an arm supported on said member and including a telescoping portion for extending it outwardly, and means including oppositely declining supporting elements for supporting the rack in oppositely tiltable positions and also for securing it in a horizontal position on said arm.

25 11. A device comprising a table having a movable top portion and a supporting leg, a shaft slidable in said leg and adjustable vertically therein, an arm adjustable for length supported on said shaft to swing on the table, and means for supporting said top portion horizontally on said arm including angular plate means for holding said portion tilted.

30 12. A device comprising a table including a stationary and a movable top portion and a leg, a shaft slidable in said leg and means for supporting it vertically adjusted thereon, an arm adjustable for length mounted on said shaft and swingable therewith, means for supporting said movable top portion on said arm to serve as a supporting rack and including slanting members to support said rack tilted, means to secure said rack horizontally on said arm, and a ledge and means for mounting it on either side of said rack.

35 13. A device comprising a table including a top member which is constantly stationary for supporting articles, legs for supporting said member and a lower shelf mounted therebetween, a supporting rack, a horizontal arm and means for mounting it on the table to be adjusted vertically and extended laterally from either side thereof, means for mounting said rack tiltable in opposite directions and also placeable horizontally on said arm, whereby to support said rack in various positions and at different sides of the table, and a leg mounted on said shelf to be extended selectively at either side of the table and serve as a brace.

40 14. A device comprising a table having a sup-

porting top, a bar mounted on said table under said top and extendible therefrom, an arm and means for adjustably supporting it on said bar, and a rack and means for adjustably mounting it on said arm, to serve as a supporting rack, said rack and arm being readily placeable in opposite directions from said bar and being also concealable under said top.

45 15. A device comprising a table having a supporting top, a bar mounted under said top and being slidable and swingable therefrom, an arm and means for swingably mounting and for adjusting it vertically on said bar, and a supporting rack and means for mounting it on said arm to be adjusted longitudinally thereof and to be held thereon in a tilted or in a horizontal position, said rack and arm and bar being foldable and concealable under said top.

50 16. A device comprising a table having a top, a bar and means for mounting it at one end pivotally on said table under said top, leg means for supporting said bar at the other end, a horizontally extending member and means for supporting it on said bar to be swingably and vertically adjustable thereon, and a supporting rack and means for adjustably mounting it on said arm to be held horizontally and also tilted thereon.

55 17. A device comprising a table including an upper frame and a flat top thereon, a bar slidably mounted in said frame adapted to be concealed under said top, pivot means adapting the bar to be swung when extended from the frame, an arm and means for swingably mounting it on said bar and for adjusting it vertically thereon, a supporting rack and means whereby it is mounted on said arm to be adjusted longitudinally thereof and to be held in a horizontal and in a tilted position thereon, and ledge means on said rack adapting it for a reading rack, said rack and connected elements being foldable on said bar and therewith slidable and concealable under said top.

60 18. A device comprising a table adapted for use alongside a chair and including fixed top board means constantly adapted to support articles, a supporting rack mounted on the table to be folded thereon in its inoperative position, a member and means for securing the rack tiltable in various directions thereon, a substantially vertical element on the table, and means for extendibly supporting said member on said element, whereby said member is mounted on the table to be swingable thereon about said element and to be swingable in various directions from the table without moving said fixed top board means while said rack is adjustably supportable in various operative positions in front of the chair and the table is placeable at either side of the chair.

65 19. A device comprising a table including top board means which is constantly stationary for supporting articles, legs for supporting said means and a lower shelf mounted between said legs, a supporting rack, a member and means for mounting it on the table to be adjustable vertically and also laterally at different sides of the table, means for mounting said rack tiltable and also placeable horizontally on said member, whereby to support said rack in various positions and at different sides of the table, and a leg movably mounted on the table to be extended selectively at different sides thereof and serve as a brace.