



US00D755915S

(12) **United States Design Patent**
Hakl

(10) **Patent No.:** **US D755,915 S**

(45) **Date of Patent:** **** May 10, 2016**

(54) **OPTICAL DIFFRACTION ALIGNMENT LENS**

(71) Applicant: **Anthony R. Hakl**, Loda, IL (US)

(72) Inventor: **Anthony R. Hakl**, Loda, IL (US)

(**) Term: **14 Years**

(21) Appl. No.: **29/504,474**

(22) Filed: **Oct. 7, 2014**

(51) **LOC (10) Cl.** **22-01**

(52) **U.S. Cl.**

USPC **D22/107**

(58) **Field of Classification Search**

USPC D16/134; D22/100, 107, 109, 199;
33/265; 42/133; 124/86, 87, 90
CPC F41G 1/00; F41G 1/08; F41G 1/467
See application file for complete search history.

(56) **References Cited**

U.S. PATENT DOCUMENTS

- 3,703,771 A * 11/1972 Saunders F41G 1/467
124/90
- 4,454,857 A * 6/1984 Miller F41G 1/467
124/87
- 4,833,786 A * 5/1989 Shores, Sr. F41G 1/467
33/265
- D304,592 S * 11/1989 Hoogesteger D16/131
- 5,148,603 A * 9/1992 Beutler F41G 1/467
33/265
- 5,325,598 A * 7/1994 Hall F41G 1/467
124/87
- 5,347,976 A * 9/1994 Saunders F41G 1/467
124/87
- 5,450,673 A * 9/1995 Denton F41G 1/467
124/87
- 5,669,146 A * 9/1997 Beutler F41G 1/467
124/87

- 6,131,295 A 10/2000 Cranston
- 6,282,800 B1 * 9/2001 Beutler F41G 1/467
124/87
- 6,981,329 B1 * 1/2006 Strathman F41G 1/467
124/87
- 7,040,027 B1 * 5/2006 Shaffer F41G 1/467
124/87
- 7,266,896 B1 * 9/2007 White F41G 1/467
124/90
- 7,373,723 B1 * 5/2008 Tupper, Jr. F41G 1/467
124/87
- 7,543,389 B2 * 6/2009 Grace, Jr. F41G 1/467
124/87
- 9,212,866 B1 * 12/2015 Hakl F41G 1/08
- 2003/0019118 A1 * 1/2003 Wilson F41G 1/467
33/265

OTHER PUBLICATIONS

<http://www.lancasterarchery.com/g5-meta-peep-28617.html> Available Aug. 8, 2014.*

* cited by examiner

Primary Examiner — Susan Bennett Hattan
Assistant Examiner — Leanne Was
(74) *Attorney, Agent, or Firm* — Philip L. Bateman

(57) **CLAIM**

The ornamental design for an optical diffraction alignment lens, as shown and described.

DESCRIPTION

FIG. 1 is a front and right side perspective view of an optical diffraction alignment lens showing my new design; FIG. 2 is a front elevation view thereof; FIG. 3 is a top plan view thereof; and, FIG. 4 is a right side elevation view thereof.

1 Claim, 1 Drawing Sheet

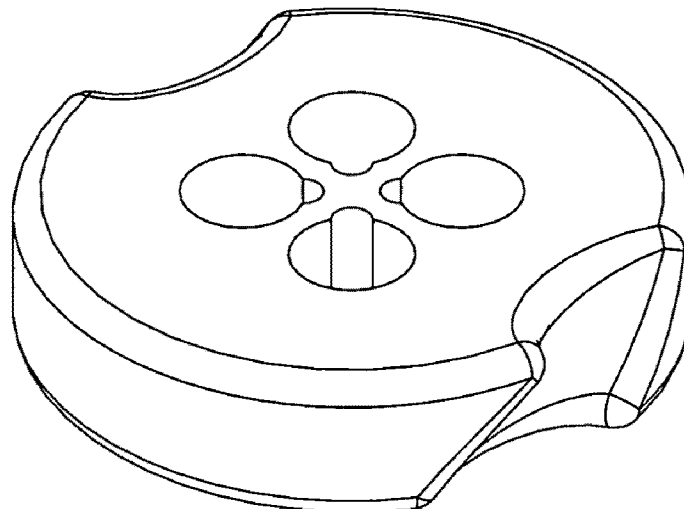

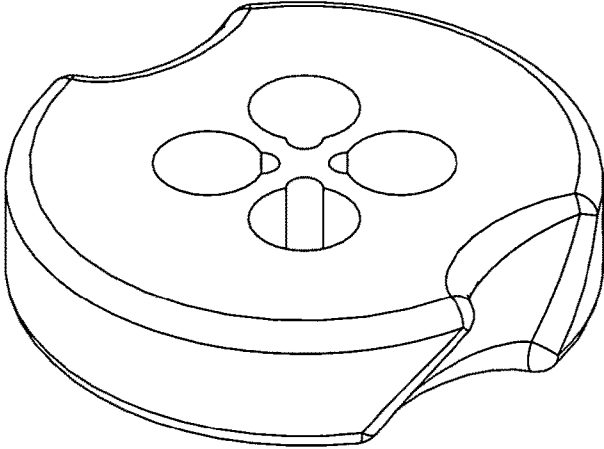

FIG. 1

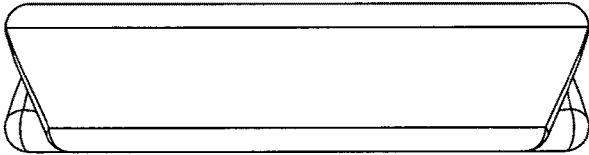

FIG. 3

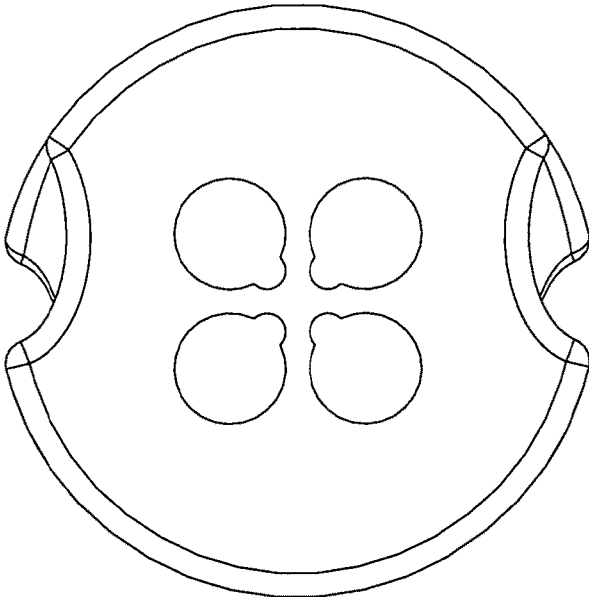

FIG. 2

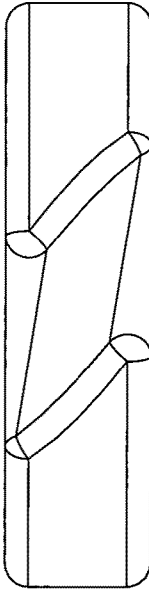

FIG. 4