

# Great Lincoln Marathon

(42.195 km)  
Lincoln, Maine

**Note:** This course was measured using the full width of the road and the Shortest Possible Route (SPR).

Start marked with white paint. Finish & Mile 13/Turnaround marked with white paint & a P-K nail. Miles marked with white paint (UP = Utility Pole).

**Start & Mile 26:** On the north curved side of W Broadway (Rt 2) at intersection with Main St across from the World War I Monument, 35 ft E of the end of the sidewalk & granite curb & 23 ft 5 inches E of UP 200358 in the grass behind a tree.

**Turnaround (TA) & Mile 13:** On west side of Main Rd (Rt 2) even with UP 158950 & 25 ft N of driveway for 722 Main Rd.

**Finish:** In Prince Thomas Park at end of Lake St even with a north-south straight line between the south post of the Prince Thomas Park sign & the west grassy edge of the parking area by the water, & 19 ft 3 inches W of the west side of Lincoln Motor Co. at 37 Lake St.

Measured July 20, 2022  
By Bob Kennedy  
Oyster River Running Company  
osprey02554@yahoo.com  
508-577-4105

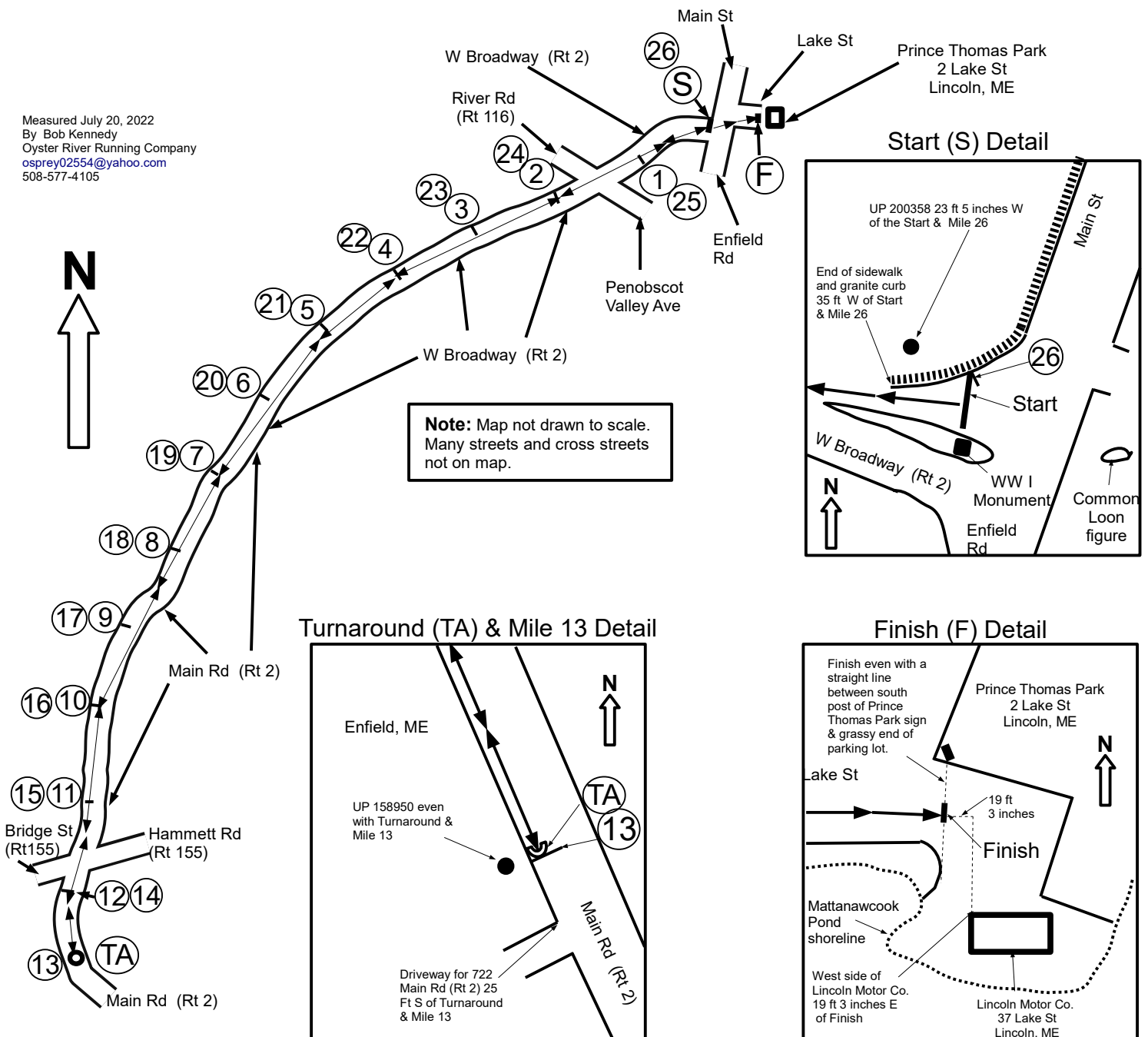

Start (S) Detail

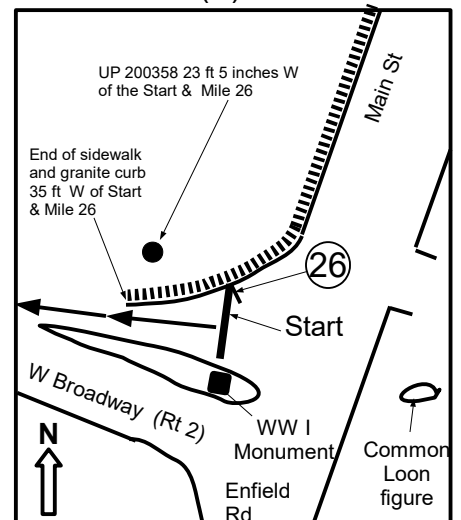

Turnaround (TA) & Mile 13 Detail

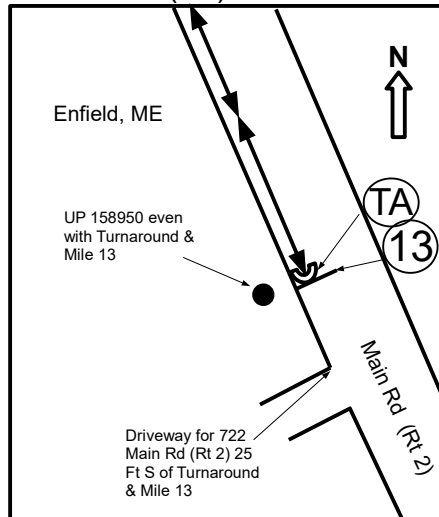

Finish (F) Detail

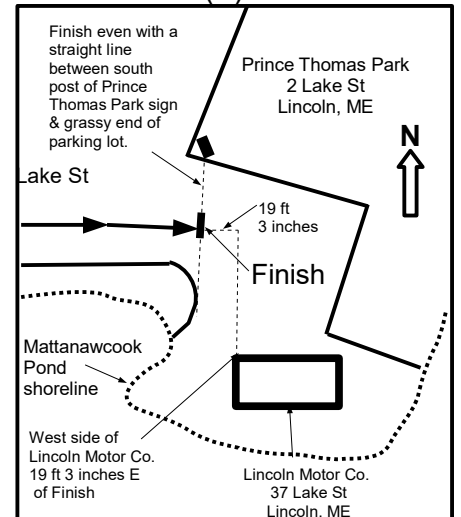







Start - End: 539077, 5023315

6.5 Mi

Half Marathon turn-around:  
530793, 5017629

13.1 Mi

Full Marathon turn-around:  
527844, 5007816

-  Start - End
-  Half Marathon path
-  Full Marathon Path
-  Marathon turn-around
-  Half marathon turn-around